

Blackburn Compression

Featuring the Color-Keyed® System

CATALOG NO. 54216BE

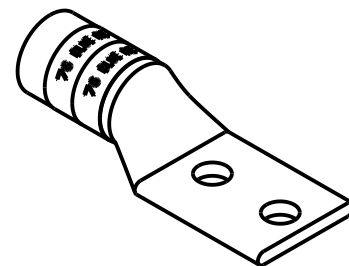
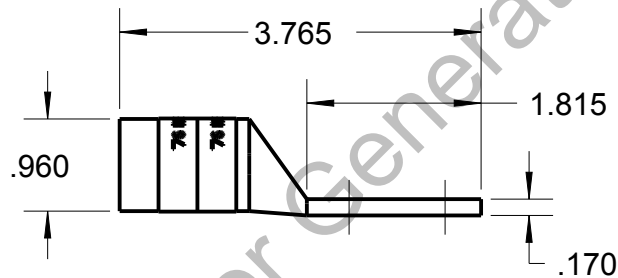
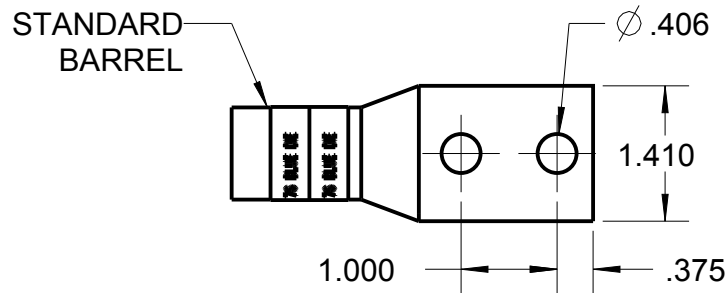

WIRE SIZE: 400 MCM
MATERIAL: HIGH CONDUCTIVITY COPPER
FINISH: TIN PLATED

| | | | | | |
|---|--|---|-------------------------|-------------------|---------------------------------------|
| GENERAL NOTES | | <div><div><div>Thomas & Betts</div><div>www.tnb.com</div></div></div> | | | |
| 1. ALL DIMENSIONS ARE FOR REFERENCE ONLY. 2. DIMENSIONS IN BRACKETS [] ARE IN METRIC UNITS. | | | | | |
| REVISIONS | | DESCRIPTION: 2 HOLE LUG | | | |
| ** | SEE ERN (****) FOR APPROVAL SIGNATURES & RELEASE DATE. PROJECT NO: **** | ORIGINAL PROJECT NO / (ERN NO) / () | SHEET NO: 1 OF 1 | REV. NO: B | DRAWING NO: WSD-002379 54216BE |