

Service Entrance Suppressor(P), 40 kA – SES40P120/240SP



The ERICO SES40P Series of Surge Protective Devices (SPD) provide economical protection against damaging transients and surge events. These Type 1 devices are UL® Listed to UL 1449 Edition 4 and cUL® Listed to CAN/CSA C233.1. This allows installations on the line or load side (Type 1 or Type 2) of the service panel in accordance with the NEC® 2014 or CAN/CSA C233.1 without the requirement for additional circuit breakers or fuses.

Primary applications are service entrance, branch, commercial, industrial, and residential. Other applications include OEM panels, solar combiner boxes, UL 96A lightning protection installations and light pole applications. The housing is constructed of UV-stabilized thermoplastic and meets the UL 50 Type 4x rating, making it ideal for both indoor and outdoor applications. All of the models have a 20kA nominal discharge current rating, the highest level recognized under the UL 1449 Edition 4 standard.

- Compact design can be directly mounted to panel or installed in a small space
- Front-facing design eases installation and performance monitoring
- 40 kA 8/20 μ s maximum surge rating per mode
- UL® 50 Type 4X
- Optional Flush Mounting Plate

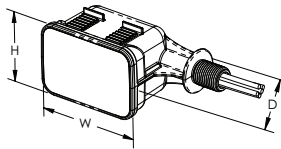

Part Number	SES40P120/240SP
Nominal System Voltage (Un)	120/240 VAC
Distribution System	1Ph 2W+G
Max Continuous Operating Voltage (Uc)	150/300 VAC
Frequency	0 – 100 Hz
Short Circuit Current Rating (SCCR)	200 kA
Nominal Discharge Current (In), Per Mode	20 kA 8/20 μ s
Max Discharge Current (Imax), Per Mode	40 kA 8/20 μ s
Voltage Protection Rating (VPR), L-L	1,800 V
Voltage Protection Rating (VPR), L-N	900 V
Status Indication	Blue LED
Technology	MOV with thermal disconnect
Lead Length	36"
Lead Size	#12
Temperature	-40 to 176 °F
Enclosure Material	UL® 94V-0 Thermoplastic
Enclosure Rating	NEMA®-4X IP 65

Part Number	SES40P120/240SP
Mounting	1/2" straight nipple
Unit Weight	0.55 lb
Certification Details	UL® 1449 Edition 4 Type 1/2, 20 kA Mode
Complies With	ANSI®/IEEE® C62.41.2-2002 Cat A, Cat B, Cat C
Depth (D)	3"
Height (H)	2 3/4"
Width (W)	4 3/4"
Certifications	cULus
Standard Packaging Quantity	1 pc
UPC	78285685909

ANSI is a registered trademark of American National Standards Institute. IEEE is a registered trademark of The Institute of Electrical and Electronics Engineers, Inc. NEC is a registered trademark of, and National Electrical Code (NEC) standard is a copyright of the National Fire Protection Association, Inc. NEMA is a registered service mark of National Electrical Manufacturers Association. UL, UR, cUL, cUR, cULus and cURus are registered certification marks of UL LLC.

WARNING

Pentair products shall be installed and used only as indicated in Pentair's product instruction sheets and training materials. Instruction sheets are available at erico.pentair.com and from your Pentair customer service representative. Improper installation, misuse, misapplication or other failure to completely follow Pentair's instructions and warnings may cause product malfunction, property damage, serious bodily injury and death and/or void your warranty.

© 2017 Pentair All rights reserved

Pentair, CADDY, CADWELD, CRITEC, ERICO, ERIFLEX, ERITECH and LENTON are owned by Pentair or its global affiliates.

All other trademarks are the property of their respective owners. Pentair reserves the right to change specifications without prior notice.