

## 402 Clevis Hanger for Copper Tube, Light Duty – 4020200CP

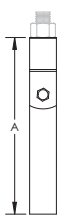

- Recommended for the suspension of stationary non-insulated copper tube lines
- Conforms with U.S. Federal Specification WW-H-171 (Type 12), Manufacturers Standardization Society (MSS) SP-58 (Type 1)

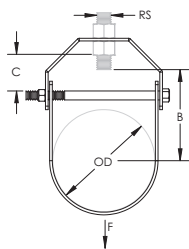

Part Number	4020200CP
Material	Steel
Finish	Copper Electroplated
Pipe Size	2"
Outer Diameter (OD)	2 1/8"
Rod Size (RS)	3/8"
A	4 1/16"
B	2 7/16"
C	1"
Static Load (F)	215 lb
Standard Packaging Quantity	50 pc
UPC	78285636605
EAN-13	8711893089332

### WARNING

Pentair products shall be installed and used only as indicated in Pentair's product instruction sheets and training materials. Instruction sheets are available at [erico.pentair.com](http://erico.pentair.com) and from your Pentair customer service representative. Improper installation, misuse, misapplication or other failure to completely follow Pentair's instructions and warnings may cause product malfunction, property damage, serious bodily injury and death and/or void your warranty.

© 2017 Pentair. All rights reserved.

Pentair, CADDY, CADWELD, CRITEC, ERICO, ERIFLEX, ERITECH and LENTON are owned by Pentair or its global affiliates.

All other trademarks are the property of their respective owners. Pentair reserves the right to change specifications without prior notice.

