

# 360 Adjustable Center-Load Beam Clamp Kit – 3600075PL

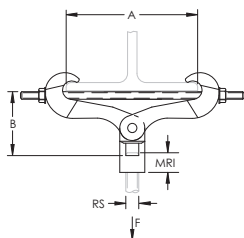

- Includes Series 26 Beam Clamp Extension Piece



Part Number	3600075PL
Material	Steel Cast Iron
Finish	Plain
Rod Size (RS)	3/4"
Pipe Size	6" Max
MRI	1 3/8"
Static Load (F)	1,365 lb
Standard Packaging Quantity	20 pc
UPC	78285638938

Part Number	A-2" B	A-3" B	A-4" B	A-5" B	A-6" B	A-7" B
3600037PL	5 5/16"	5 1/16"	4 15/16"	4 11/16"	5 1/8"	3 9/16"
3600050PL	5 5/16"	5 1/16"	4 15/16"	4 11/16"	5 1/8"	3 9/16"
3600062PL	5 1/2"	5 1/4"	5 1/8"	4 7/8"	5 5/16"	3 3/4"
3600075PL	5 1/2"	5 1/4"	5 1/8"	4 7/8"	5 5/16"	3 3/4"
3600087PL	5 3/4"	5 1/2"	5 3/8"	5 1/8"	5 9/16"	4"

Reduced hanger spacing is required when supporting 10" and 12" pipe.  
Install in accordance with applicable code.

## Included in this Kit

Part Number	Description	Quantity
0260075PL	26 Beam Clamp Extension Piece, 3/4" Rod	1
3600000PL	360 Adjustable Center-Load Beam Clamp, Cast Iron, Steel, Plain	1



#### WARNING

Pentair products shall be installed and used only as indicated in Pentair's product instruction sheets and training materials. Instruction sheets are available at [erico.pentair.com](http://erico.pentair.com) and from your Pentair customer service representative. Improper installation, misuse, misapplication or other failure to completely follow Pentair's instructions and warnings may cause product malfunction, property damage, serious bodily injury and death and/or void your warranty.

© 2017 Pentair. All rights reserved.

Pentair, CADDY, CADWELD, CRITEC, ERICO, ERIFLEX, ERITECH and LENTON are owned by Pentair or its global affiliates.

All other trademarks are the property of their respective owners. Pentair reserves the right to change specifications without prior notice.

