

PRODUCT INFORMATION PACKET



Model No: 171349.60

Catalog No: 171349.60

15 HP General Purpose Motor, 3 phase, 3600 RPM, 230/460 V, 215TC Frame, TEFC
Three Phase TEFC Motors



Regal and Leeson are trademarks of Regal Beloit Corporation or one of its affiliated companies.
©2019 Regal Beloit Corporation, All Rights Reserved. MC017097E

The Regal logo is located in the bottom right corner. It features the word "REGAL" in a white, sans-serif font, set against a dark gray, rectangular background with a slightly distressed or metallic appearance.



Nameplate Specifications

Output HP	15 Hp	Output KW	11.2 kW
Frequency	60 Hz	Voltage	230/460 V
Current	35.0/17.5 A	Speed	3520 rpm
Service Factor	1.15	Phase	3
Efficiency	91.7 %	Power Factor	88.5
Duty	Continuous	Insulation Class	F
Design Code	B	KVA Code	G
Frame	215TC	Enclosure	Totally Enclosed Fan Cooled
Thermal Protection	No	Ambient Temperature	40 °C
Drive End Bearing Size	6308	Opp Drive End Bearing Size	6306
UL	Recognized	CSA	Y
CE	Y	IP Code	55

Technical Specifications

Electrical Type	Squirrel Cage Inverter Rated	Starting Method	Line Or Inverter
Poles	2	Rotation	Reversible
Resistance Main	.5505 Ohms	Mounting	Round
Motor Orientation	Horizontal	Drive End Bearing	Ball
Opp Drive End Bearing	Ball	Frame Material	Cast Iron
Shaft Type	T	Overall Length	20.36 in
Shaft Diameter	1.375 in	Shaft Extension	3.38 in
Assembly/Box Mounting	F1/F2 CAPABLE		

This is an uncontrolled document once printed or downloaded and is subject to change without notice. Date Created:01/11/2019

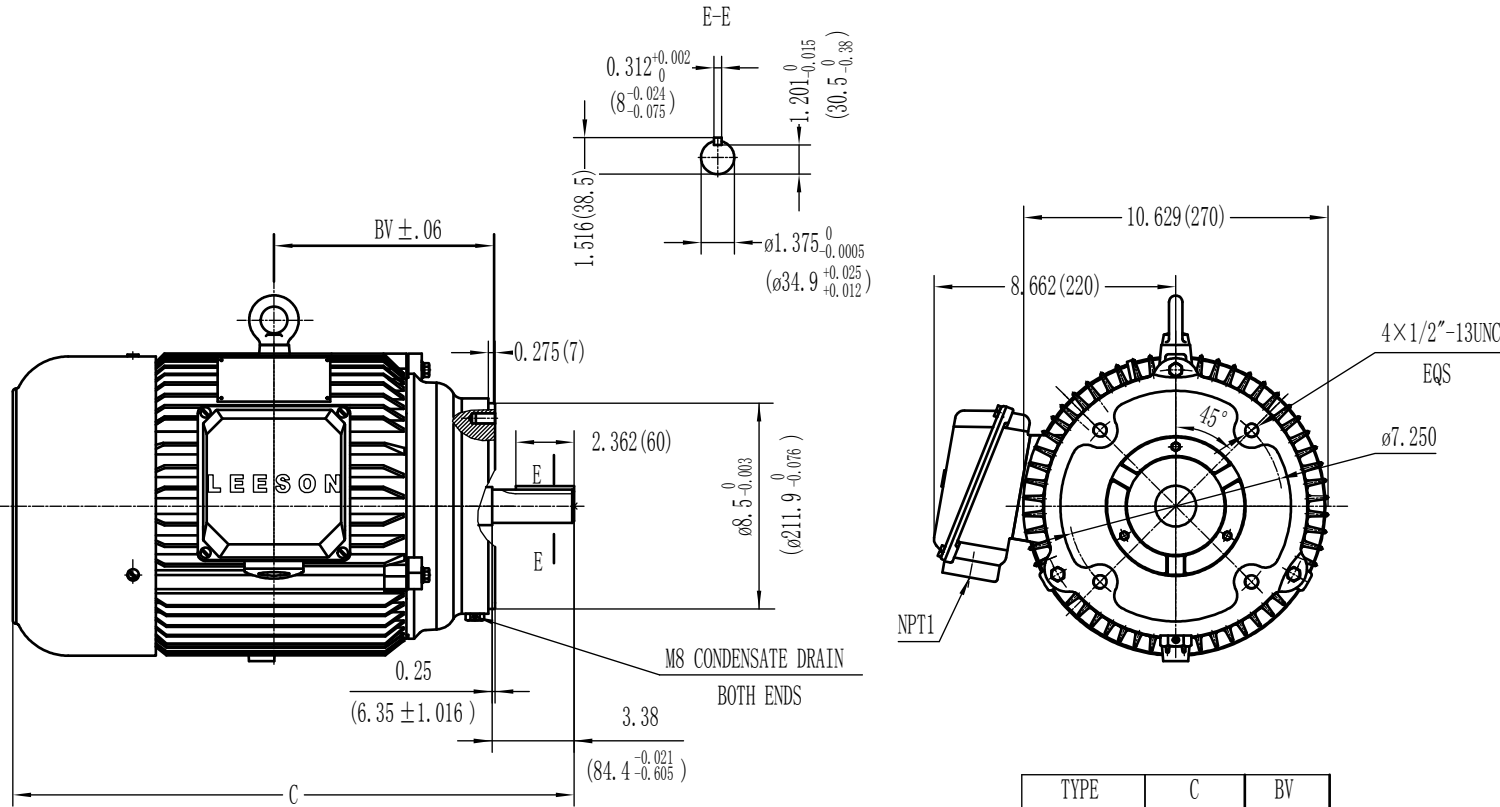

TYPE	C	BV
213T	18.855	7.25
215T	20.355	8.00

			TOLERANCES UNLESS SPECIFIED		REGAL Regal-Beloit Corporation	DRAWN	
			DEC.	INCHES		CHK	
			.X	±.1	TITLE	APPD	
			.XX	±.03		SCALE	NONE
B	REVISED TABLE	ECO-0111323	WGJ	10-17-16	EMH	3 of 3	REF
			OUTLINE			N215TC-2 15HP L/B	