

## PRODUCT INFORMATION PACKET

**marathon®**  
Motors

Model No: 5KH35JN121X  
Catalog No: H218  
1/3,1725,DP,56CZ,1/60/115  
Single Phase



Regal and Marathon are trademarks of Regal Beloit Corporation or one of its affiliated companies.  
©2018 Regal Beloit Corporation, All Rights Reserved. MC017097E

**REGAL**



## Nameplate Specifications

Output HP	0.33 Hp	Output KW	0.25 kW
Frequency	60 Hz	Voltage	115 V
Current	6.6 A	Speed	1725 rpm
Service Factor	1.35	Phase	1
Efficiency	57.5 %	Duty	CONT
Insulation Class	B	Design Code	-
KVA Code	R	Frame	56CZ
Enclosure	DP	Overload Protector	AUTO
Ambient Temperature	40 °C	Drive End Bearing Size	6203
Opp Drive End Bearing Size	6203	UL	Recognized
CSA	Yes	CE	N

## Technical Specifications

Electrical Type	Split Phase	Starting Method	SM
Poles	4	Rotation	CCW/CW
Mounting	RD	Motor Orientation	ANY
Drive End Bearing	BALL	Opp Drive End Bearing	BALL
Frame Material	Rolled Steel	Overall Length	10.25 in
Frame Length	5.79 in	Shaft Diameter	0.63 in
Shaft Extension	2.25 in	Thru-bolts Extension	0
Outline Drawing	52A102411P3	Connection Diagram	52A105379AA

This is an uncontrolled document once printed or downloaded and is subject to change without notice. Date Created: 04/05/2018

REVISIONS

REV.	DESCRIPTION	DATE	APPROVED
5	REDRAWN NO CHANGE T196-22390	9/9/96	MDP
6	UPDATED AS PER ISO5-2685	10/21/05	PRAVEEN.K

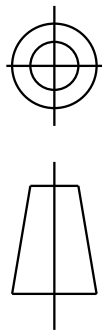

THIRD ANGLE PROJECTION

This document is the property of REGAL-BELOIT CORPORATION ("REG") including its subsidiaries and divisions and contains proprietary information of REG. This document is loaned on the express condition that neither the recipient nor any third party shall use, copy, reproduce, or disseminate the information contained herein without the express written consent of REG. This document shall be returned to REG upon its request. This document may be subject to certain restrictions under U.S. export control laws and regulations.

VIEW FACING  
LEAD END

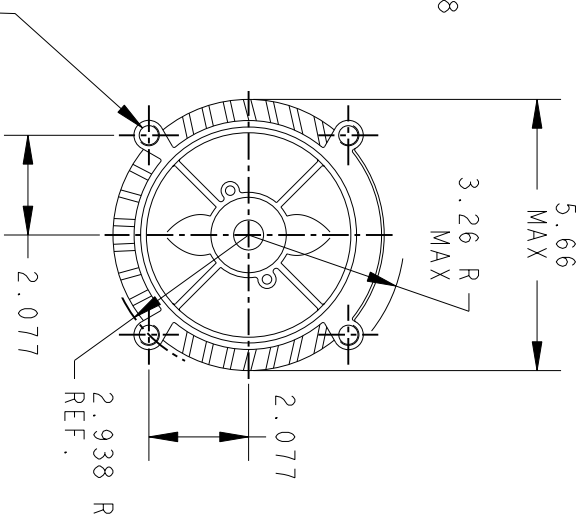
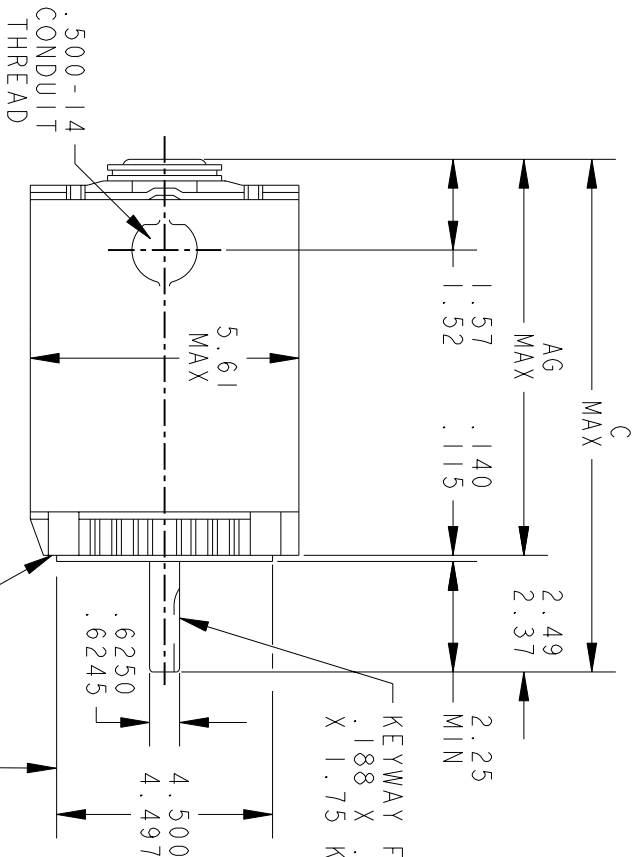
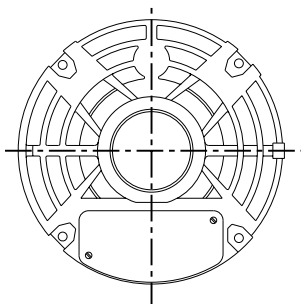

FACE RUNOUT (WITH INDICATOR—  
MOUNTED STATIONARY, RELATIVE  
TO SHAFT) MUST NOT EXCEED  
.010 TIR

ECCENTRICITY OF THIS SURFACE (WITH  
INDICATOR MOUNTED STATIONARY RELATIVE  
TO SHAFT) MUST NOT EXCEED .010 TIR

.375-16 UNC-2B (4 HOLES)  
.82 MIN. FULL THD. THESE  
HOLES FIT A GAGE HAVING A  
RABBIT 4.5005 DIA. AND 4  
PINS .2917 DIA. LOCATED ON  
THE BASIC HOLE POSITIONS.

5	KH	37	56CZ	11.08	8.61	
4	KH	36	56CZ	10.68	8.21	
3	KH	35	56CZ	10.25	7.78	
2	KH	33	56CZ	9.87	7.40	
1	KH	32	56CZ	9.62	7.15	

PT	TYPE	GE SIZE	NEMA FR	C	AG	SHELL REF
----	------	------------	------------	---	----	--------------

FOR ADDITIONAL INFO REFER TO:

APPLIED PRACTICES	SIGNATURES	DATE
DIMENSIONS ARE IN INCHES	MODEL	
	DETAIL	BCC 09/02/17

TITLE



REGAL-BELOIT CORPORATION

TOLERANCE ON:  
1 PL DECIMALS ± 0.1  
2 PL DECIMALS ± 0.02  
3 PL DECIMALS ± 0.005  
ANGLES ± 1.0  
FRACTIONS ±

FINISH

QUALITY	ISSUED	MDP
---------	--------	-----

MATERIAL SOLID MODEL: 52A102411

SIZE	DRAWING	SCALE: 1.000	REF. No.: .	SHEET 1 of 1
A				

FORM "N" MOTOR-D RIP PROOF R2 END MOUNTED  
-SLEEVE & BALL BEARING. FWF 5KH32DN111

52A102411

REV  
6

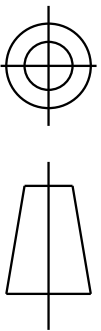

REVISIONS			
REV.	DESCRIPTION	DATE	APPROVED
6	UPDATED FORMAT	12/01/05	MAM

EITHER ROTATION-SINGLE VOLTAGE-TYPE KC OR KH-WITH THERMAL PROTECTOR

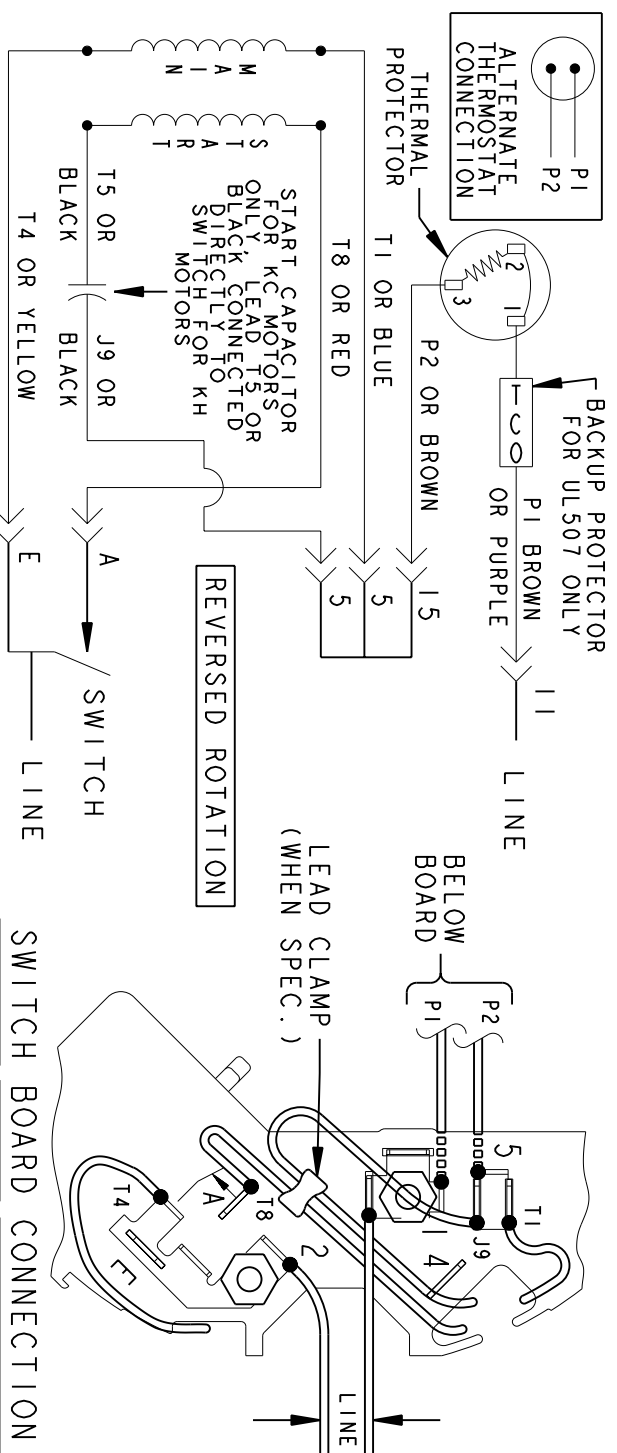
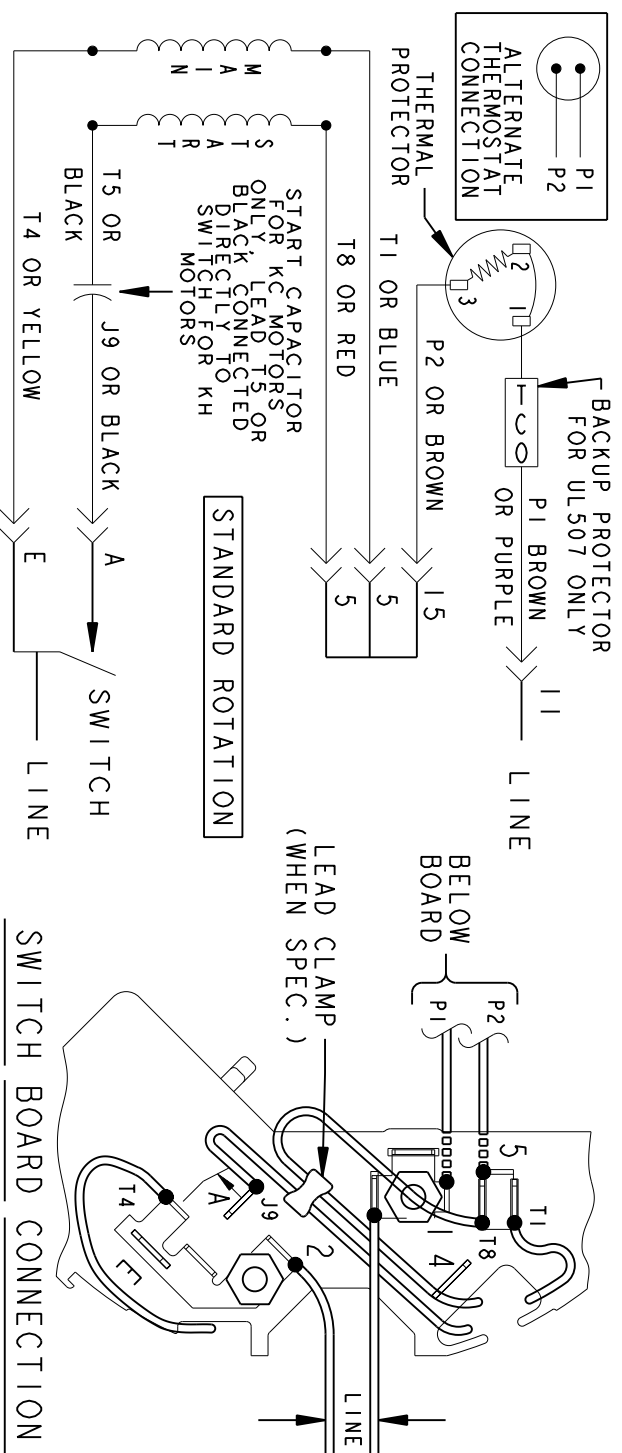

NOTE #1 - TO REVERSE ROTATION INTERCHANGE RED (T8) AND BLACK (J9-KC OR T5-KH) LEADS.  
NOTE #2 - WHEN MORE THAN ONE CAPACITOR IS USED CONNECT IN PARALLEL.

SWITCH (C) - 115D958AB

REF. DIAG. - 121A851

CONN. LABEL - 52X332048

		SIGNATURES		DATE
		MODEL	M.D. PARE	06/29/87
		DETAIL	.	.
		CHECKED	.	.
		ENG66	.	.
		MF6	.	.
FOR ADDITIONAL INFO REFER TO:		QUALITY	.	.
APPLIED PRACTICES		ISSUED	M.D.P.	03/08/00
DIMENSIONS ARE IN INCHES				
MATERIAL		SOL ID MODEL : 52A105379AA		



**REGAL-BELOIT CORPORATION**

TITLE

CONNECTION DIAGRAM

## FMF - 30 FR SWITCH REDESIGN

52A105379AA

REV 6

SIZE	DRAWING
A	

SCALE: 1.0