

# SHIMS & SPACERS

HUYETT.COM • 785-392-3017

BOX 232 • MINNEAPOLIS, KS • 67467

SALES@HUYETT.COM • FAX 785-392-2845

## FLAT SHIM STOCK – METAL

### DESCRIPTION

Flat shim stock is easy to use and versatile. It is available in sheets and offered in a variety of materials. It is easily cut to fit your specific application.

### HOW TO IDENTIFY

1. Measure width (A).
2. Measure length (B).
3. Measure thickness (C).
4. Build the part number from the chart on the next page.

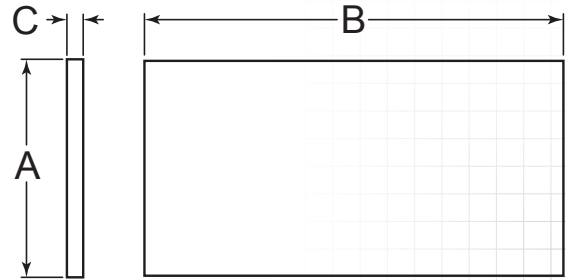
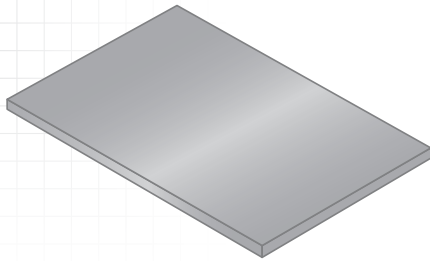

### PREFIX MATERIAL/FINISH

FLT-### = CARBON STEEL, PLAIN\*  
 FLT-###-BR = BRASS, PLAIN  
 FLT-###-BT = CARBON STEEL, BLUE TEMPERED (1095)  
 FLT-###-CU = COPPER, PLAIN

FLT-###-PB = BRONZE, PLAIN  
 FLT-###-SS = STAINLESS STEEL, PLAIN  
 Material/finish combinations may not be available in all sizes.

### FLAT METAL SHIM STOCK TOLERANCES

MATERIAL		WIDTH (A)		LENGTH (B)	
(Prefix)	(Material/Finish)	(Size Range)	(Tolerance)	(Size Range)	(Tolerance)
FLT-###	Carbon Steel, Plain*	6" 8"	±.060" ±.075"	12" 18 – 25"	±.075" ±.060"
FLT-###-BR	Brass, Plain	6" 8"	±.060" ±.063"	12 – 18" 25"	±.060" +3/-.500"
FLT-###-BT	Carbon Steel, Blue Tempered (1095)	All Sizes	±.060"	All Sizes	+3/-.500"
FLT-###-CU	Copper, Plain	All Sizes	±.010"	All Sizes	+.500/-.250"
FLT-###-PB	Bronze, Plain	All Sizes	±.010"	All Sizes	+.250/-.125"
FLT-###-SS	Stainless Steel, Plain	6" 8"	±.075" ±.010"	12" 25"	±.031" ±.075"

FOR DETAILED SPECIFICATIONS AND TOLERANCES, VISIT [HUYETT.COM](http://HUYETT.COM).

Prices, materials, dimensions, tolerances, designs, and grades subject to change without notice. © 2016 G.L. Huyett

\*Limited warranty for surface finish: 30 days from date of shipment. See page 12 for details.



# SHIMS & SPACERS

HUYETT.COM • 785-392-3017

## FLAT SHIM STOCK – METAL

### HOW TO BUILD A PART NUMBER

**FLT-0612012-BR**

(A)  
WIDTH

(B)  
LENGTH

(C)  
THICKNESS

ITEM SUFFIX

**06**

TO ORDER CHOOSE  
YOUR WIDTH,

**12**

CHOOSE YOUR  
LENGTH,

**012**

CHOOSE YOUR  
THICKNESS,

**-BR**

CHOOSE YOUR  
MATERIAL.

CODE	WIDTH
01	1.50"
04	4.00"
05	5.00"
06	6.00"
08	8.00"
10	10.00"
12	12.00"
20	20.00"
21	21.00"

CODE	LENGTH
12	12.00"
18	18.00"
20	20.00"
24	24.00"
25	25.00"
40	40.00"
50	50.00"
51	51.00"

CODE	THICKNESS
0005	.0005"
0008	.0008"
001	.0010"
0015	.0015"
002	.0020"
003	.0030"
004	.0040"
005	.0050"
006	.0060"
007	.0070"
0075	.0075"
008	.0080"
009	.0090"
010	.0100"
012	.0120"
0125	.0125"
0135	.0135"
015	.0150"
016	.0160"
0165	.0165"
018	.0180"
020	.0200"
022	.0220"
025	.0250"
030	.0300"
031	.0310"
032	.0320"
035	.0350"
040	.0400"
042	.0420"
050	.0500"
060	.0600"
062	.0620"
070	.0700"
080	.0800"
090	.0900"
094	.0940"
125	.1250"

CODE	MATERIAL
(blank)	Carbon Steel, Plain*
-BR	Brass, Plain
-BT	Carbon Steel, Blue Tempered (1095)
-CU	Copper, Plain
-PB	Bronze, Plain
-SS	Stainless Steel, Plain

### PUNCHING HOLES IN SHIM STOCK

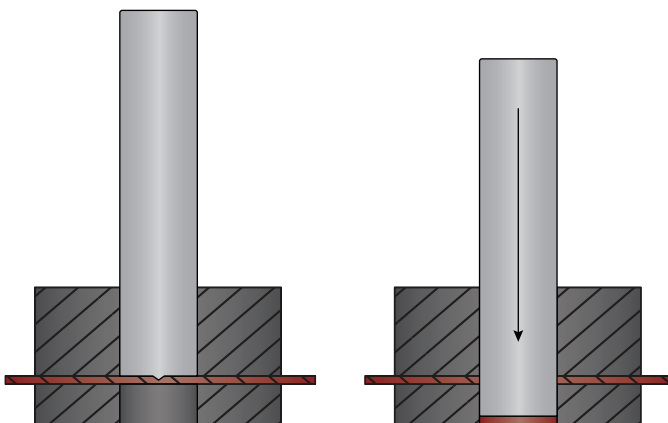

Cut a piece of shim stock to size and place it beneath the block needing shimmed. Use a transfer punch to mark any hole positions. Using a shim stock hole punch set, place the shim stock in the punch block/die set. Maintain consistent pressure on the shim to keep it from moving, remove the transfer punch, install the shim punch, and punch the hole for a perfect fit.

DON'T SEE WHAT  
YOU'RE LOOKING  
FOR? CONTACT  
SALES@HUYETT.COM  
OR  
CALL 785-392-3017

DEPENDING ON THE  
THICKNESS AND  
MATERIAL, SOME FLAT  
SHIM STOCK CAN BE  
CUT WITH SCISSORS FOR  
QUICK AND EASY ON-  
THE-SPOT ADJUSTMENTS

FOR DETAILED SPECIFICATIONS AND TOLERANCES, VISIT HUYETT.COM.

Prices, materials, dimensions, tolerances, designs, and grades subject to change without notice. © 2016 G.L. Huyett

\*Limited warranty for surface finish: 30 days from date of shipment. See page 12 for details.