

GATES 14M POLY CHAIN GT2 BELT

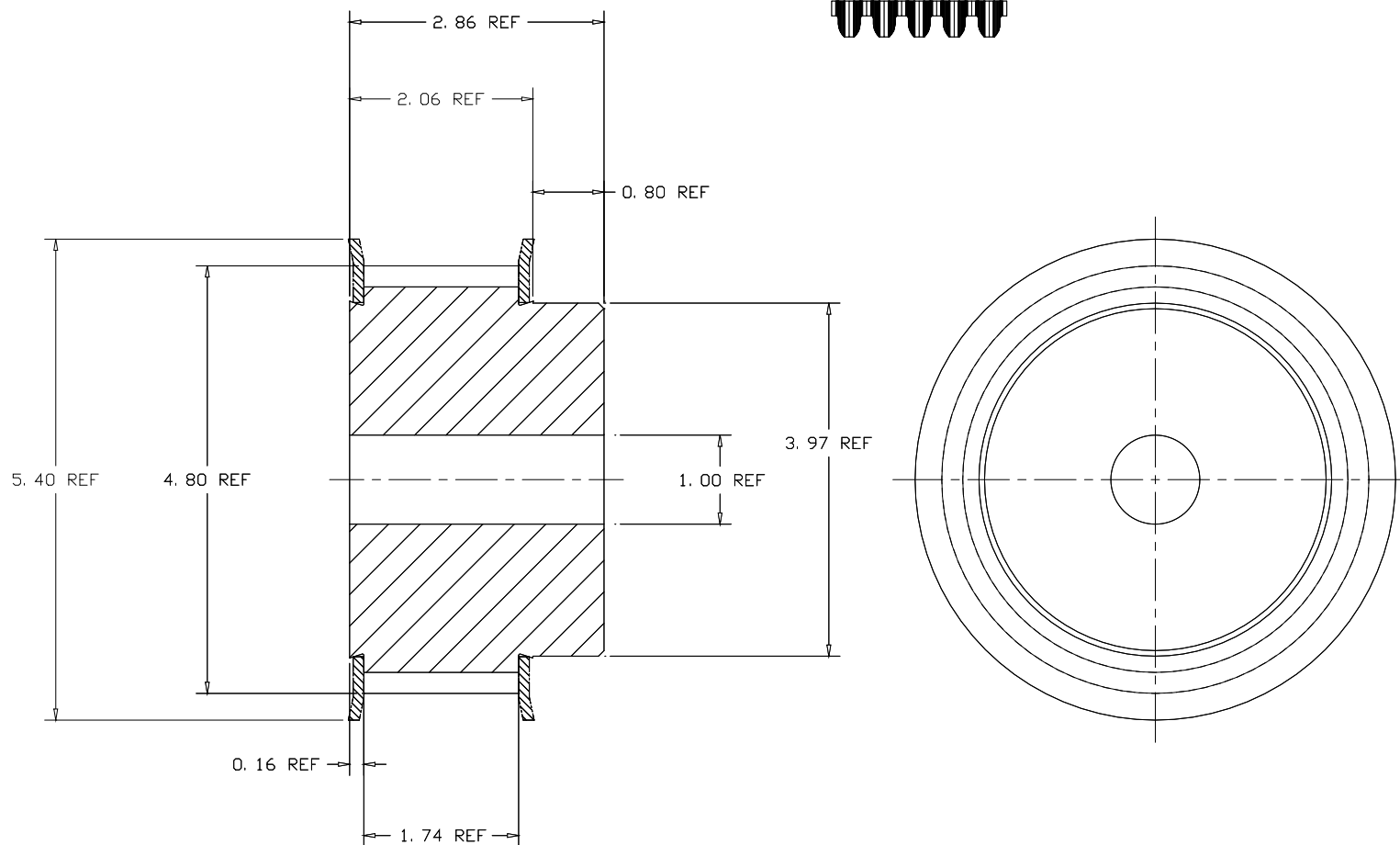

CERTIFIED

DFTR	REV	DATE	APP'D	REVISION

TOOTH TYPE: GTX

BELT PITCH: 14m

PITCH DIA: 4.912

NO. OF TEETH: 28

MATERIAL: DUCTILE IRON

FINISH: 250 ✓

COATINGS: ANTI-RUST

THE MATERIALS AND INFORMATION, INCLUDING THE PRINCIPALS OF DESIGN PRESENTED, ARE THE EXCLUSIVE PROPERTY OF THE GATES RUBBER COMPANY AND ARE TO BE CONSIDERED AS CONFIDENTIAL INFORMATION. ACCORDINGLY, THIS INFORMATION IS SUBMITTED TO YOU WITH THE AGREEMENT THAT IT IS NOT TO BE REPRODUCED, COPIED, OR LOANED, IN PART OR IN WHOLE, NOR IS THE INFORMATION TO BE RELAYED TO ANY OTHER INDIVIDUAL OR COMPANY. ACCEPTANCE OF THIS DRAWING WILL BE CONSTRUED AS AN AGREEMENT TO THE ABOVE.

THIS DRAWING IS A STOCK POWER TRANSMISSION COMPONENT. DETAILS SHOWN WHICH DO NOT AFFECT DRIVE FUNCTION MAY BE CHANGED WITHOUT ANY NOTIFICATION.

CUSTOMER NAME:

CUSTOMER DWG NO.:



THE GATES RUBBER CO.
DENVER, COLORADO

PART DESCRIPTION: 14MX-28S-37 MPB

GATES PART NUMBER: 77163028

APPROVED BY _____

DATE _____

REF. QUOTE NO.

DR. BY mghmw4 DATE 10-20-99

CK. BY _____

APPD. BY _____

DRAWING NO.

77163028