

GATES 14M POLY CHAIN GT2 BELT

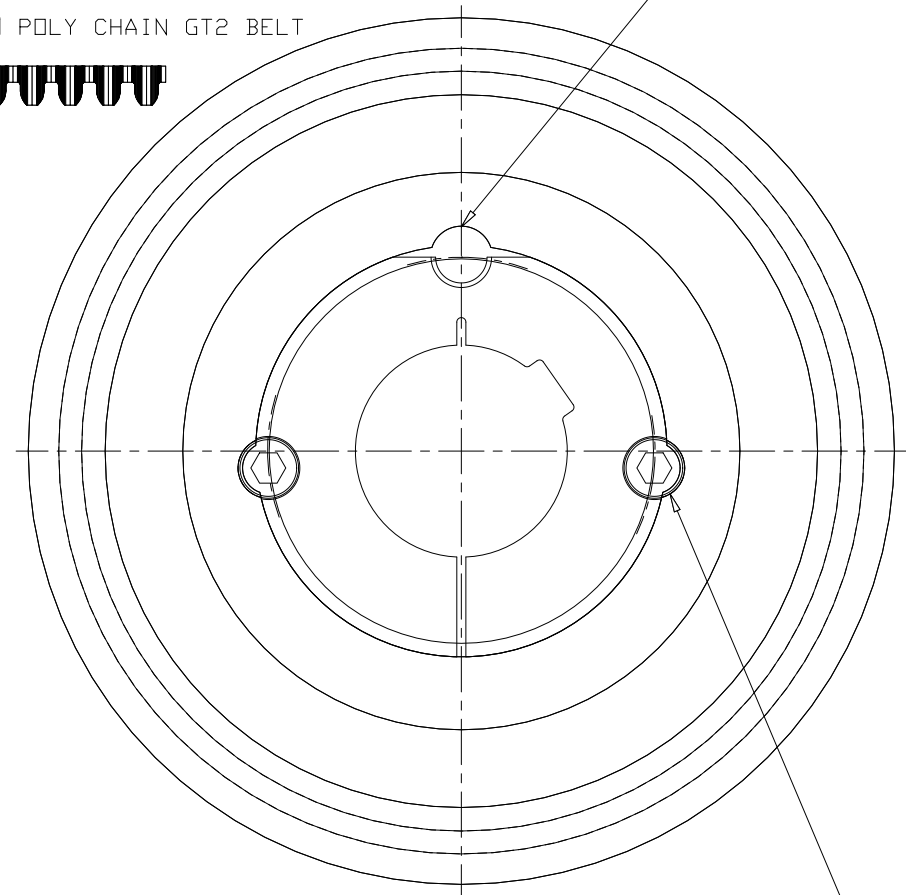

CERTIFIED

DFTR	REV	DATE	APP'D	REVISION

TOOTH TYPE: GT

BELT PITCH: 14m

PITCH DIA: 8.421

NO. OF TEETH: 48

MATERIAL: GRAY IRON

FINISH: 250 ✓

COATINGS: ANTI-RUST

THE MATERIALS AND INFORMATION, INCLUDING THE PRINCIPALS OF DESIGN PRESENTED, ARE THE EXCLUSIVE PROPERTY OF THE GATES RUBBER COMPANY AND ARE TO BE CONSIDERED AS CONFIDENTIAL INFORMATION. ACCORDINGLY, THIS INFORMATION IS SUBMITTED TO YOU WITH THE AGREEMENT THAT IT IS NOT TO BE REPRODUCED, COPIED, OR LOANED, IN PART OR IN WHOLE, NOR IS THE INFORMATION TO BE RELAYED TO ANY OTHER INDIVIDUAL OR COMPANY. ACCEPTANCE OF THIS DRAWING WILL BE CONSTRUED AS AN AGREEMENT TO THE ABOVE

THIS DRAWING IS A STOCK POWER TRANSMISSION COMPONENT. DETAILS SHOWN WHICH DO NOT AFFECT DRIVE FUNCTION MAY BE CHANGED WITHOUT ANY NOTIFICATION.

CUSTOMER NAME:

CUSTOMER DWG NO.:



**THE GATES RUBBER CO.**  
**DENVER, COLORADO**

PART DESCRIPTION: 14MX-48S-20 3020

GATES PART NUMBER: 77192048

APPROVED BY \_\_\_\_\_

DATE \_\_\_\_\_

DR. BY \_\_\_\_\_ DATE \_\_\_\_\_

CK. BY \_\_\_\_\_

APPD. BY \_\_\_\_\_

REF. QUOTE NO.

DRAWING NO.

77192048