

BX-FLEX-MC

Cut-In Snap Lock BX Connector

Features

- Provides significant labor savings when installing metal clad or armored cable in old work (cut-in) electrical box installations
- No tools are required when assembling to the cable or box
- The anti-short bushing is pre-assembled and will not fall out during transit or installation
- After installing the old-work box in the wall and fishing the cable through the box, simply snap the cable to the fitting and snap the fitting into the box
- The Cut-in Snap Lock BX connector can easily be removed without tools and is reusable



E148716

Product Advantage

- Faster installation
- No tools required
- One piece design
- Robust, pre-assembled anti-short bushing
- Easy removal
- Reusable

Standard Material

- Die cast zinc
- Spring steel
- Polycarbonate bushing

Technical Info

- Fit's 1/2" Knockout
- AL and Steel AC 14-2 to 10-3
- AL and Steel MC/MCI-A/HCF 14-2 to 10-3
- AL and steel 3/8" RWFMC

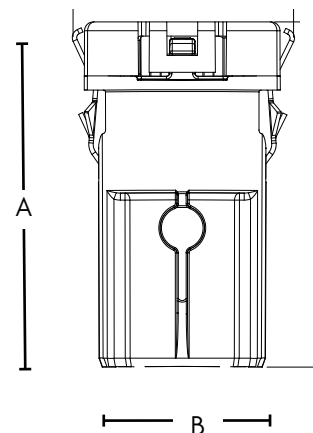

Topaz Cat. No.	UPC	Trade Size	Unit Ctn.	Ship Case	Weight Case	A	B	C
130CSL	87122	3/8"	50	500	31	1.53	.98	1.10