

Armored/Metal Clad Cable Connectors

For Non-Jacketed Metal Clad Cable

Type PK – Malleable Iron

Type PK-A – Aluminum

For Non-Jacketed Metal Clad Cable such as inter-locked armor, corrugated metal sheath, smooth aluminum sheath and similar types. Non-watertight for dry locations.

Use:

Use with any type of metal clad cable to terminate and ground the armor and secure the cable where it enters a cabinet (max. ¼" thick), through a standard knockout, slip-hole or D & T entrance.

These terminators accommodate a wide range of cable armor diameters in a given fitting by simply inserting fibre rings to provide armor stops having smaller diameters. An armor clamp having clamping pieces on each side allows the cable to be centered in the fitting and provides full contact with the armor to insure a positive ground. The armor clamp on the 1¼" through 5" trade sizes consists of two clamping pieces (one on each side) as shown in illustration. The ¾", 1" and 6" trade sizes have one clamping piece located on one side only.

Material/Finish:

Type PK: Malleable Iron/Zinc Electroplated
Type PK-A: Copper free Aluminum

Furnished complete with phenolic insulating Bushing, electro-plated steel screws and plated steel or malleable iron locknut. (Stainless steel screws, and/or aluminum locknuts are available with aluminum fittings at price addition. Contact your local representative for price and availability.)

Third Party Certification:



UL Listed E-36853



CSA Certified: 15553

Applicable Third Party Standards:

UL Standard: 514B

CSA Standard: C22.2 No.18

Note:

The above terminators in the 1¼" through 6" sizes can be furnished with Lay-In-Lug™ grounding wire connectors shown on Page QA14.

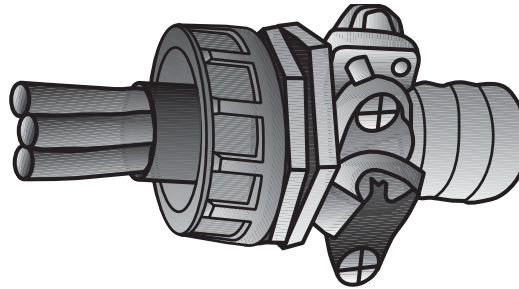

Type PK

Trade Size (in.) C	Iron Catalog Number	Aluminum Catalog Number	Malleable Cable Range Dia Over Armor		Dimensions in Inches		
			Min.	Max.	A	B	Max. Dia.
¾	PK-75	PK-75A	.45	.62	1	1	1½
¾	PK-751	PK-751A	.63	.80	1	1	1½
1	PK-100	PK-100A	.63	.80	1¼	1½	1¾
1	PK-101	PK-101A	.81	.96	1¼	1½	2½
1¼	PK-125	PK-125A	.81	1.34	1⅞	1¼	2½
1½	PK-150	PK-150A	1.19	1.56	1⅞	1¼	2¾
2	PK-200	PK-200A	1.35	2.00	1⅞	1⅞	3½
2½	PK-250	PK-250A	1.79	2.40	2	1⅞	3½
3	PK-300	PK-300A	2.21	2.98	2⅞	1⅞	4½
3½	PK-350	PK-350A	2.79	3.44	2⅞	1¾	5½
4	PK-400	PK-400A	3.21	3.91	2⅞	1⅞	5½
5	PK-500	PK-500A	3.92	4.84	2⅞	2⅞	6¾
6	PK-600*	PK-600A*	5.47	5.71	2¾	2¼	8¼

*Not certified by CSA.

