

Cable Connectors

For Armored Cable & Flexible Metal Conduit

Type AC

45° Angle Squeeze Connectors

Use:

To ground and secure Armored Cable and Flexible Metal Conduit to boxes and enclosures.

Features:

- Male hubs - NPS.
- Provided with center stop.
- Available with insulated throats.
- Furnished with locknuts
- Also suitable for NM and SE cable

Material/Finish:

Malleable Iron/Zinc Electroplated

Third Party Certification:



UL Listed: E-11852
UL Listed for armored cable and flexible steel conduit.
UL Listed flexible metal conduit fittings are suitable for use in Hazardous Location under NEC 501-4(b) Class I Div. II, and suitable as a grounding means under NEC 350-5.



CSA Certified: 9795.
CSA Certified for armored cable.

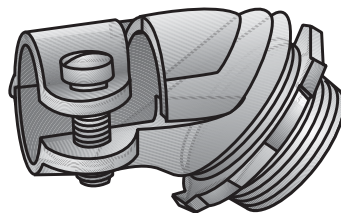

Type AC-38

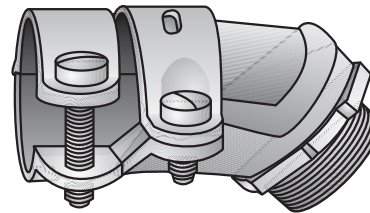

Type AC-50

Trade Size (inches)	Catalog Number	Insulated Throat Catalog Number	Body Length	Dimensions in Inches			Flex. Opening
				Thread Length	Max. Width		
3/8 (1/2 KO)	AC-38	AC-38T	1 3/8	7/16	1 1/4	17/32 - 39/64	
1/2	AC-50	AC-50T	1 15/16	7/16	1 11/16	29/32 - 15/16	
3/4	AC-75	AC-75T	2 1/8	1/2	1 3/4	29/32 - 1 1/16	

Applicable Third Party Standards:

UL Standard: 514B
CSA Standard C22.2 No. 18
Fed. Spec: W-F-406E
NEMA: FB-1

Type 25-38C

Duplex Connector

Use:

To ground and secure two Armored Cables to boxes and enclosures.

Features:

- For armored cable 14/2 to 10/2 or combination of sizes
- Furnished with locknuts.
- Male hubs-NPS

Material/Finish:

Malleable Iron/Zinc Plated

Third Party Certification:



UL Listed: E-11852
UL Listed flexible metal conduit fittings are suitable for use in Hazardous Locations under NEC 501-4(b) Class I Div. II, and suitable as a grounding means under NEC 350-5.



CSA Certified: 9795

Applicable Third Party Standards:

UL Standard: 514B
CSA Standard C22.2 No. 18
Fed. Spec: W-F-406E
NEMA: FB-1

Trade Size (inches)	Catalog Number	Body Length	Dimensions in Inches		
			Thread Length	Max. Width	Flex. Opening
3/8 (1/2 KO)	25-38C	1 1/16	7/16	1 9/16	7/32 - 17/32

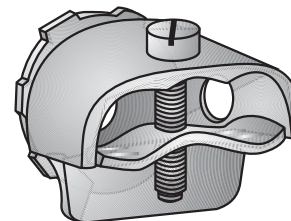

Type 25-38C