

SYM	REVISION	BY	DATE

SCALE: ~

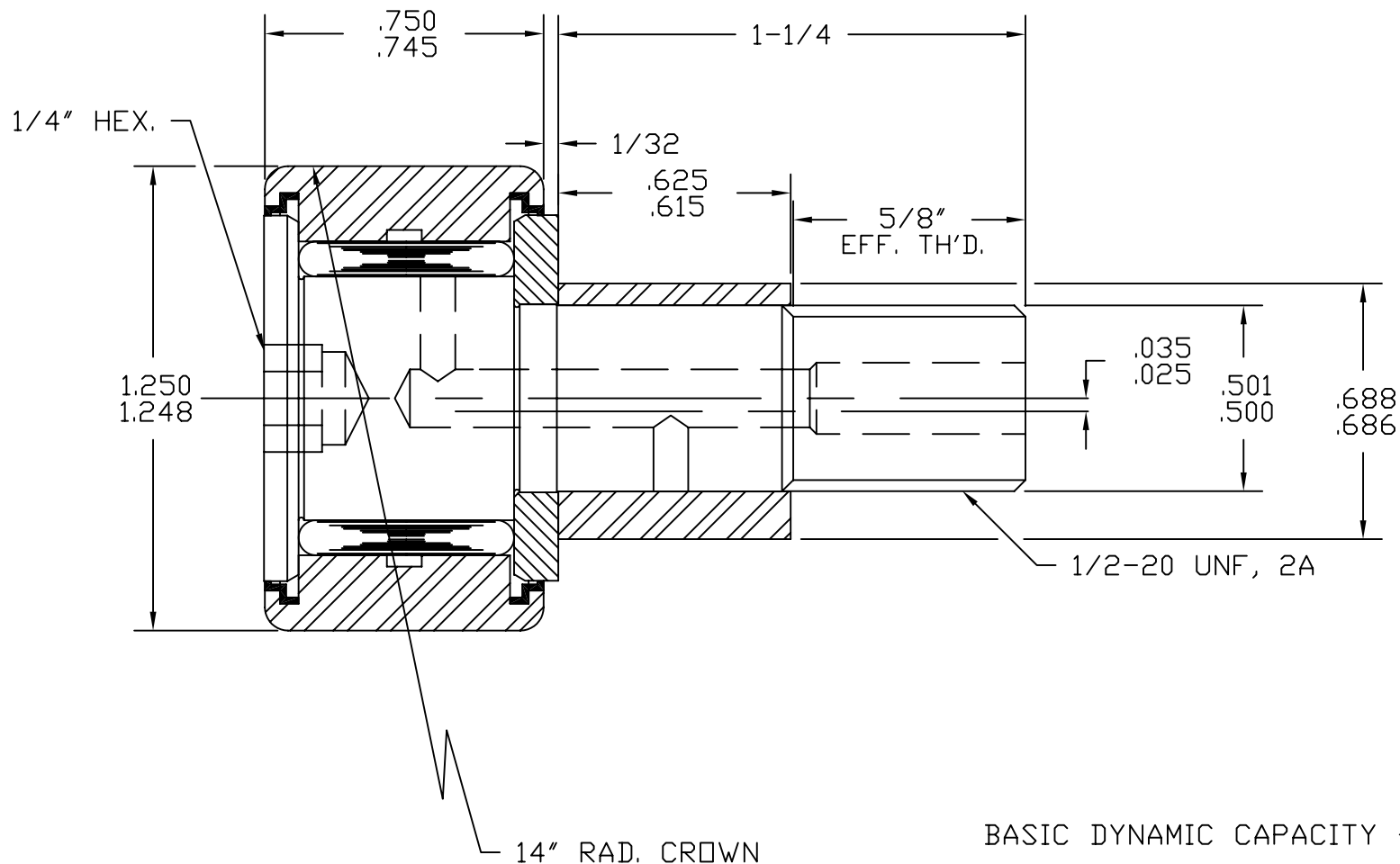

BASIC DYNAMIC CAPACITY - 3390

MAT'L: ST'D BEARING STEELS.  
BEARING PACKED WITH GENERAL PURPOSE EP GREASE.  
RELUBE PROVISIONS WILL ACCEPT 3/16" DRIVE TYPE  
FITTINGS, PLUGS SUPPLIED FOR UNUSED HOLES.

#### TOLERANCES

UNLESS OTHERWISE NOTED  
FRACTIONS:  $\pm .010$  ANGLES:  $\pm .5$   
2 PLACE DECIMALS (.00):  $\pm .005$   
3 PLACE DECIMALS (.000):  $\pm .002$



**ACCURATE BUSHING CO. INC.**  
Manufacturers of SMITH® Bearing Product  
443 NORTH AVENUE  
Garwood, NJ 07027

PART NAME	STANDARD CAM FOLLOWER		
PART NO.	CR-1-1/4-XBEC		
DRAWN BY	JC	DATE	6/23/11
CHECKED BY		FILENAME	CRASSYS\1-1-4-XBEC