

SYM	REVISION	BY	DATE
A	REVISED & REDRAWN	BSK	8/3/95

SCALE: ~

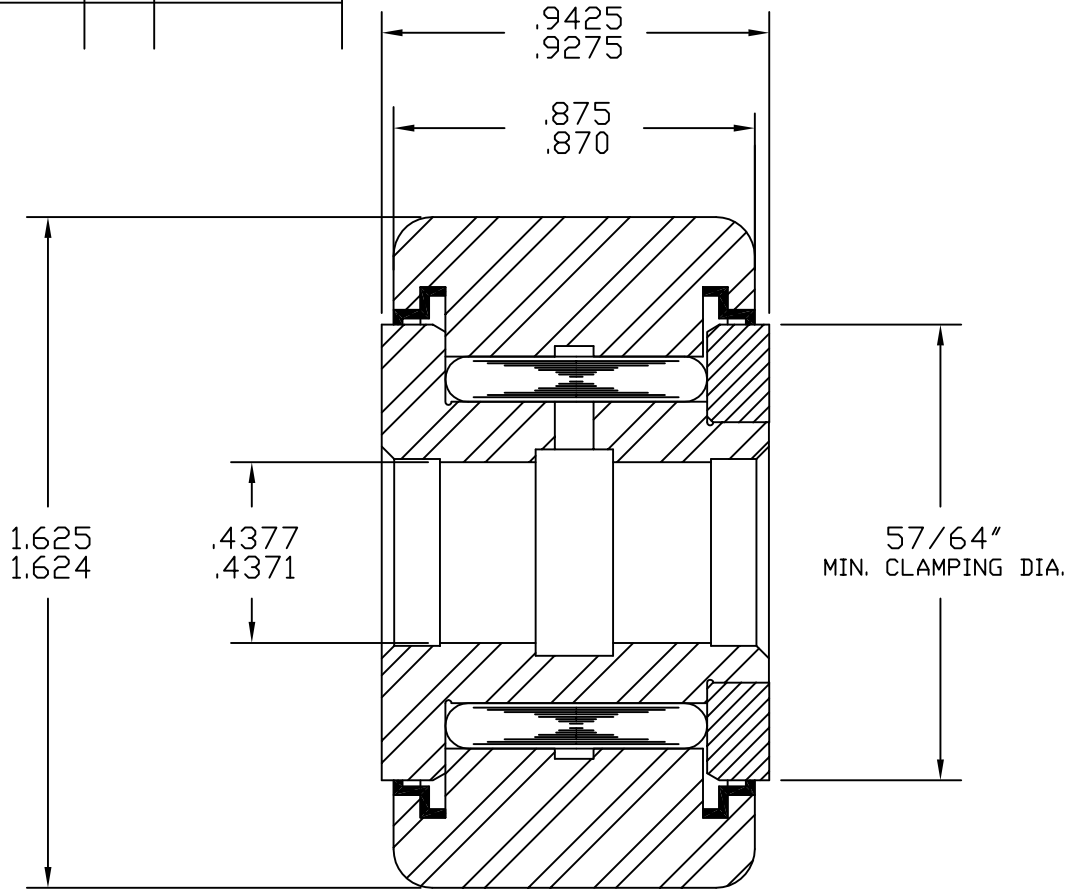

MAT'L: ST'D BEARING STEELS, SEALS - ACETAL.
 BEARING PACKED WITH GENERAL PURPOSE EP GREASE.
 RELUBE PROVISIONS WILL ACCEPT 3/16" DRIVE TYPE
 FITTINGS, PLUGS SUPPLIED FOR UNUSED HOLES.

TOLERANCES
 UNLESS OTHERWISE NOTED
 FRACTIONS: ±.010 ANGLES: ±.5
 2 PLACE DECIMALS (.00): ±.005
 3 PLACE DECIMALS (.000): ±.002



ACCURATE BUSHING CO. INC.
 Manufacturers of SMITH® Bearing Product
 443 NORTH AVENUE
 Garwood, NJ 07027

PART NAME	STANDARD YOKE ROLLER		
PART NO.	YR-1-5/8-X		
DRAWN BY	BSK	DATE	8/3/95
CHECKED BY		FILENAME	\YRASSYS\1-5-8-X