

The Timken Company

4500 Mt Pleasant St. NW

N. Canton, OH 44720

Phone: (234) 262-3000

E-Mail: CustomerCAD@timken.com • **Web site:** www.timken.com

Timken Part Number IR-8810448, Inner Ring (IR)

- Ideal choice where the shaft is not practical to use as inner raceway.
- Designed to meet established inch tolerances.
- Maximum shaft fillet radius cannot exceed inner-ring bore chamfer as shown.
- Optional centralized lubrication groove (bore) or through hole available – specify when ordering.
- Designed to be axially clamped against shoulder for loose transition fit on shaft.
- After mounting, for tight transition fit (keeping inner ring from rotating relative to shaft), inner-ring O.D. must not

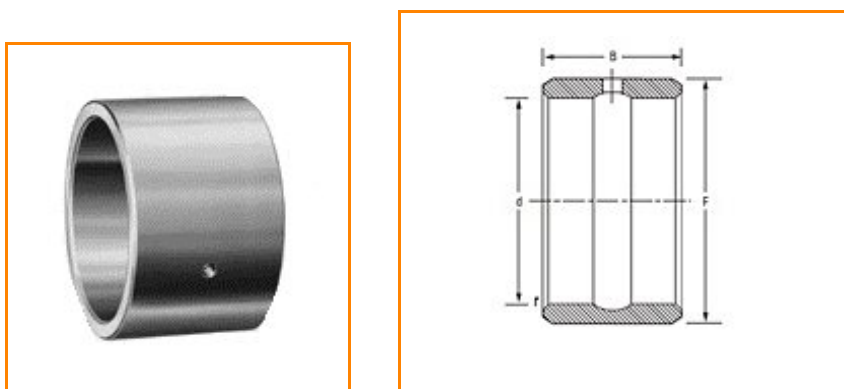
 + [more](#)

[Dimensions](#) | [Specifications](#) | [Sub Assembly Part Numbers](#)

Dimensions

| | |
|---|-----------------------|
| Shaft Diameter | 5.500 in |
| Dimension D | 5.50 in 139.7 mm |
| Dimension F | 6.500 in 165.10 mm |
| Dimension B | 3.000 in 76.20 mm |
| Chamfer r_{smin} | 0.12 in 3.05 mm |

Specifications



| | |
|------------------------------------|-------------------------|
| Max. Loose Transition Fit S | 139.685 mm 5.4994 in |
|------------------------------------|-------------------------|

| | |
|------------------------------------|-------------------------|
| Min. Loose Transition Fit S | 139.662 mm 5.4985 in |
|------------------------------------|-------------------------|

| | |
|------------------------------|-------------------------|
| Max. Interference Fit | 139.733 mm 5.5013 in |
|------------------------------|-------------------------|

| | |
|------------------------------|-------------------------|
| Min. Interference Fit | 139.715 mm 5.5006 in |
|------------------------------|-------------------------|

| | |
|---------------|------------------|
| Weight | 8 lb 3.629 Kg |
|---------------|------------------|

Sub Assembly Part Numbers



| | |
|--------------------------------------|-------------|
| Used with Bearing Designation | HJ-10412848 |
|--------------------------------------|-------------|

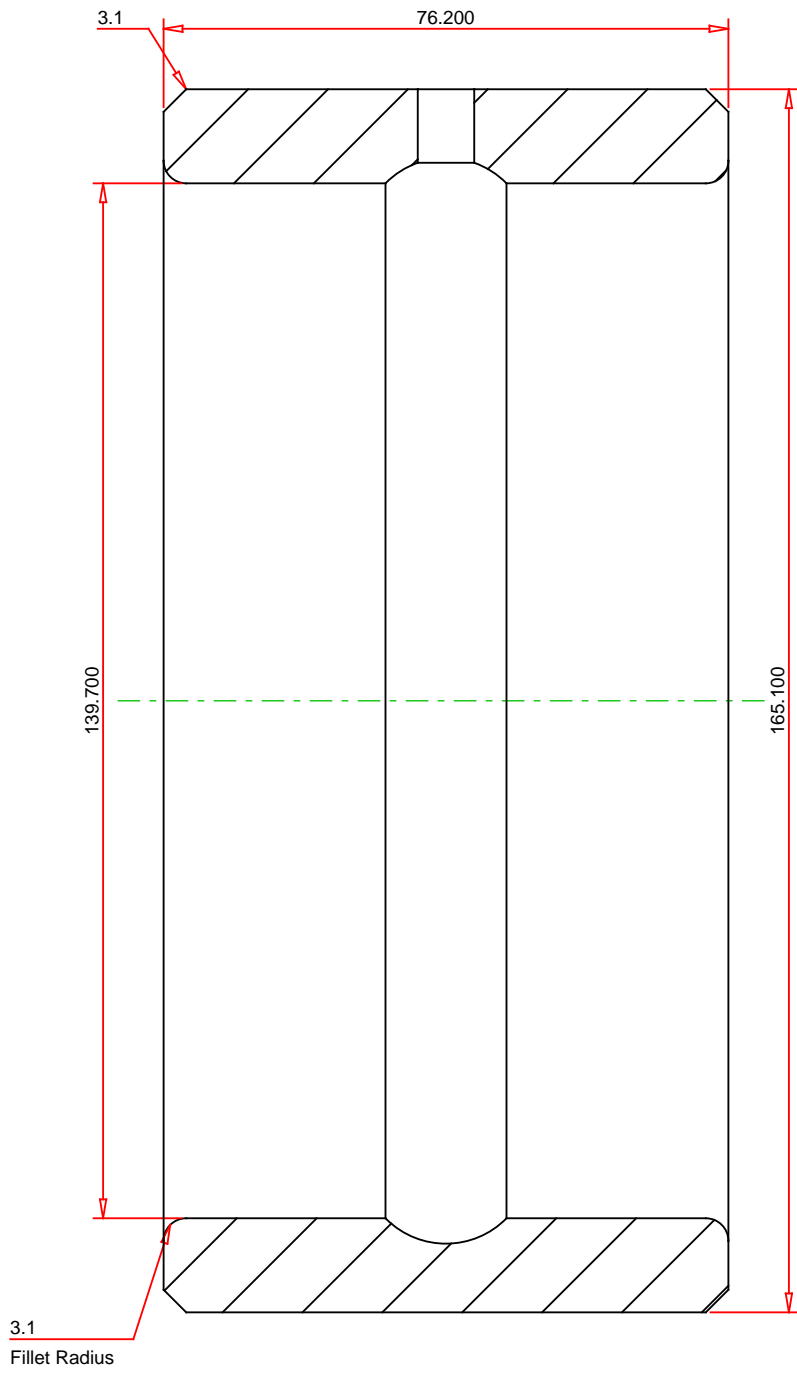

METRIC UNITS

Bearing Weight 3.6 kg

TIMKEN®

THE TIMKEN COMPANY
NORTH CANTON, OHIO USA

IR-8810448
CYLINDRICAL ROLLER BEARINGS

Every reasonable effort has been made to ensure the accuracy of the information contained in this writing, but no liability is accepted for errors, omissions or for any other reason.

FOR DISCUSSION ONLY