

**The Timken Company**

4500 Mt Pleasant St. NW

N. Canton, OH 44720

**Phone:** (234) 262-3000

**E-Mail:** [CustomerCAD@timken.com](mailto:CustomerCAD@timken.com) • **Web site:** [www.timken.com](http://www.timken.com)

## Timken Part Number L44649 - L44610, Tapered Roller Bearings - TS (Tapered Single)

## Imperial

This is the most basic and most widely used type of tapered roller bearing. It consists of two main separable parts: the cone (inner ring) assembly and the cup (outer ring). It is typically mounted in opposing pairs on a shaft.

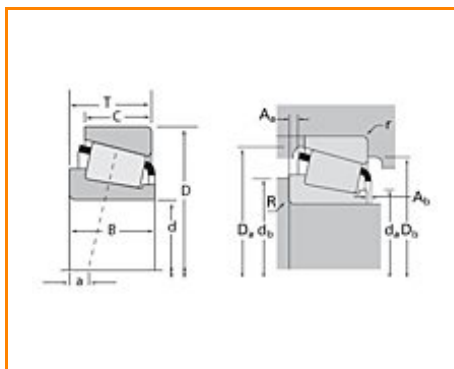

[Specifications](#) | [Dimensions](#) | [Abutment and Fillet Dimensions](#) | [Basic Load Ratings](#) | [Factors](#)

## Specifications

<b>Series</b>	L44600
<b>Cone Part Number</b>	L44649
<b>Cup Part Number</b>	L44610
<b>Design Units</b>	Imperial
<b>Bearing Weight</b>	0.100 Kg 0.30 lb
<b>Cage Type</b>	Stamped Steel

## Dimensions

<b>d - Bore</b>	26.988 mm 1.0625 in
<b>D - Cup Outer Diameter</b>	50.292 mm 1.9800 in
<b>B - Cone Width</b>	14.732 mm 0.5800 in
<b>C - Cup Width</b>	10.668 mm 0.4200 in
<b>T - Bearing Width</b>	14.224 mm 0.5600 in

## Abutment and Fillet Dimensions

<b>R - Cone Backface "To Clear" Radius<sup>1</sup></b>	3.560 mm 0.14 in
<b>r - Cup Backface "To Clear" Radius<sup>2</sup></b>	1.27 mm 0.050 in
<b>da - Cone Frontface Backing Diameter</b>	30.99 mm 1.22 in
<b>db - Cone Backface Backing Diameter</b>	37.59 mm 1.48 in
<b>Da - Cup Frontface Backing Diameter</b>	47.50 mm 1.87 in
<b>Db - Cup Backface Backing Diameter</b>	44.45 mm 1.75 in
<b>Ab - Cage-Cone Frontface Clearance</b>	1.3 mm 0.05 in
<b>Aa - Cage-Cone Backface Clearance</b>	0.5 mm 0.02 in
<b>a - Effective Center Location<sup>3</sup></b>	-3.3 mm -0.13 in

## Basic Load Ratings

<b>C90 - Dynamic Radial Rating (90 million revolutions)<sup>4</sup></b>	9230 N 2080 lbf
---	--------------------

<b>C1 - Dynamic Radial Rating (1 million revolutions)<sup>5</sup></b>	35600 N 8010 lbf
---	---------------------

<b>C0 - Static Radial Rating</b>	32900 N 7400 lbf
----------------------------------	---------------------

<b>C<sub>a90</sub> - Dynamic Thrust Rating (90 million revolutions)<sup>6</sup></b>	5910 N 1330 lbf
---	--------------------

## Factors

<b>K - Factor<sup>7</sup></b>	1.56
-------------------------------	------

<b>e - ISO Factor<sup>8</sup></b>	0.37
-----------------------------------	------

<b>Y - ISO Factor<sup>9</sup></b>	1.60
-----------------------------------	------

<b>G1 - Heat Generation Factor (Roller-Raceway)</b>	8.9
---	-----

<b>G2 - Heat Generation Factor (Rib-Roller End)</b>	8.93
---	------

<b>Cg - Geometry Factor</b>	0.0526
-----------------------------	--------

<sup>1</sup> These maximum fillet radii will be cleared by the bearing corners.

<sup>2</sup> These maximum fillet radii will be cleared by the bearing corners.

<sup>3</sup> Negative value indicates effective center inside cone backface.

<sup>4</sup> Based on  $90 \times 10^6$  revolutions  $L_{10}$  life, for The Timken Company life calculation method.  $C_{90}$  and  $C_{a90}$  are radial and thrust values.

<sup>5</sup> Based on  $1 \times 10^6$  revolutions  $L_{10}$  life, for the ISO life calculation method.

<sup>6</sup> Based on  $90 \times 10^6$  revolutions  $L_{10}$  life, for The Timken Company life calculation method.  $C_{90}$  and  $C_{a90}$  are radial and thrust values for a single-row,  $C_{90(2)}$  is the two-row radial value.

<sup>7</sup> These factors apply for both inch and metric calculations. Consult your Timken representative for instruction on use.

<sup>8</sup> These factors apply for both inch and metric calculations. Consult your Timken representative for instruction

on use.

<sup>9</sup> These factors apply for both inch and metric calculations. Consult your Timken representative for instruction on use.

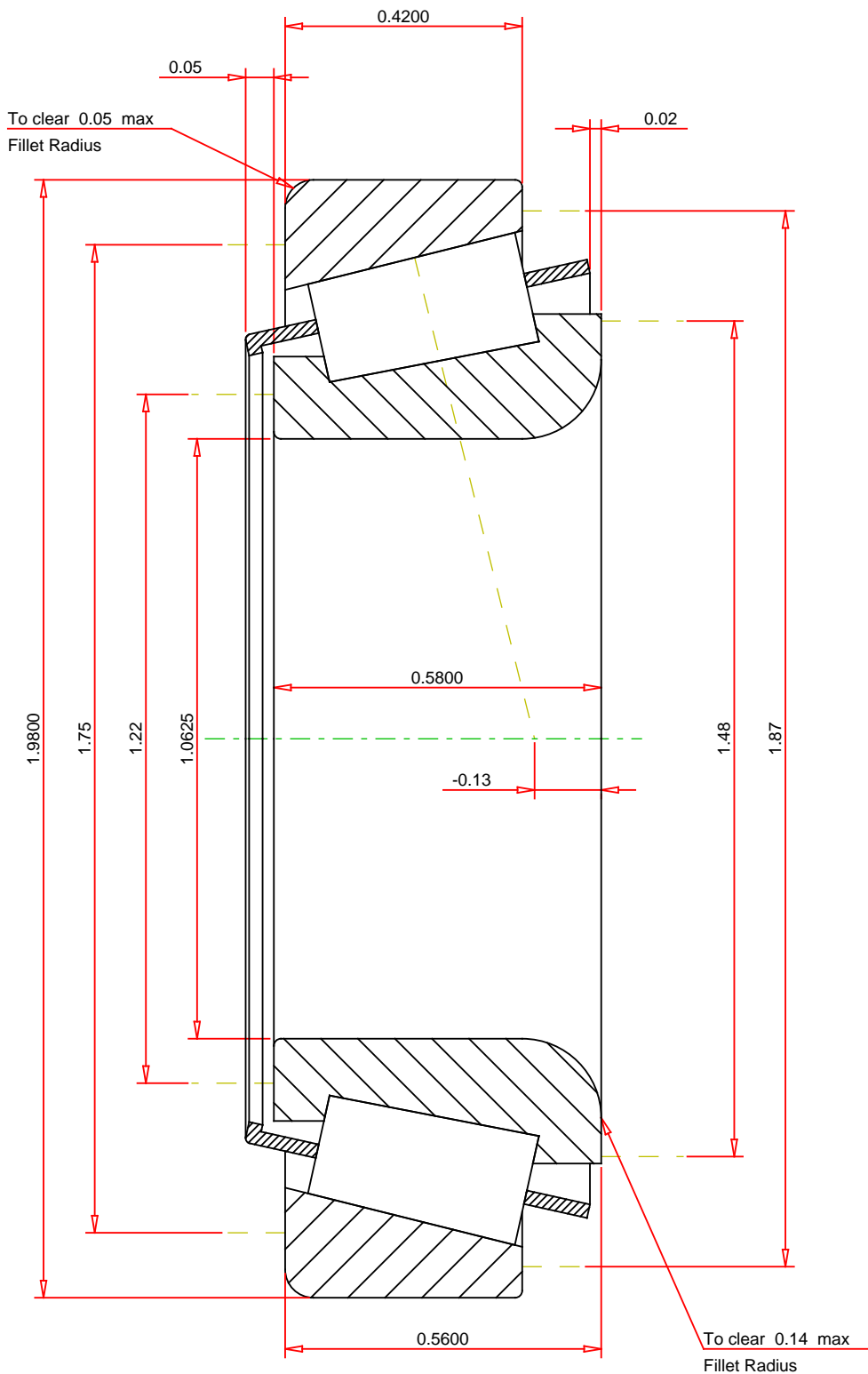

IMPERIAL UNITS

<div>ISO Factor - e0.37</div> <div>ISO Factor - Y1.6</div> <div>Bearing Weight0.3 lbf</div> <div>Number of Rollers Per Row19</div> <div>Effective Center Location-0.13 inch</div>		<div><div>TIMKEN®</div><div>THE TIMKEN COMPANY</div><div>NORTH CANTON, OHIO USA</div></div>		<div>L44649 - L44610</div> <div>TS BEARING ASSEMBLY</div>	
				<div>K Factor1.56</div> <div>Dynamic Radial Rating - C909230 lbf</div> <div>Dynamic Thrust Rating - Ca905910 lbf</div> <div>Static Radial Rating - C032900 lbf</div> <div>Dynamic Radial Rating - C135600 lbf</div>	

Every reasonable effort has been made to ensure the accuracy of the information contained in this writing, but no liability is accepted for errors, omissions or for any other reason.

FOR DISCUSSION ONLY