

High Density Polyethylene (HDPE) Couplings

Applications:

- designed for mechanically joining high density polyethylene pipe and fittings

Features:

- ductile iron body with rust inhibiting paint
- uses four bolts to drive the sharply machined housing teeth into the outside of the pipe
- Comparable to: Grinnell's #9095

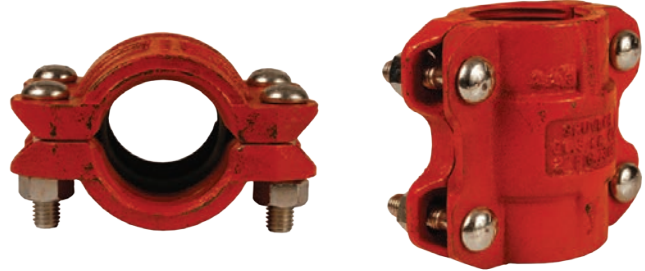
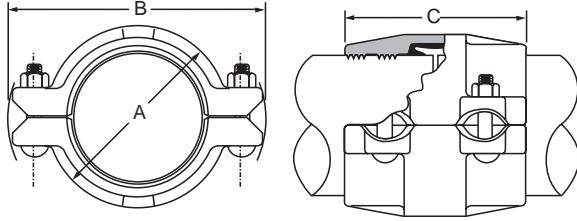

Nominal Size	Pipe OD	Coupling Dimensions			Approx. Weight (lbs.)	Bolts			Ductile Iron w/ EPDM gasket Part #	Ductile Iron w/ Buna-N gasket Part #	Price/E
		A	B	C		qty	size	length			
2"	2.375	3 ³ / ₈ "	5 ¹ / ₂ "	4 ⁵ / ₈ "	4.5	4	1/2"	2 ³ / ₈ "	HDPE200	HDPE200BU	\$510.00
3"	3.500	4 ⁵ / ₈ "	6 ³ / ₄ "	4 ⁵ / ₈ "	8.5	4	1/2"	3"	HDPE300	HDPE300BU	610.00
4"	4.500	5 ¹ / ₄ "	8"	5 ³ / ₄ "	12.0	4	1/2"	3"	HDPE400	HDPE400BU	670.00
6"	6.625	7 ¹ / ₂ "	11"	5 ⁷ / ₈ "	18.0	4	5/8"	3 ¹ / ₂ "	HDPE600	HDPE600BU	930.00

Lite® Couplings - Stainless Steel



Applications:

- designed for use on rigid, locked-in pipe connections

Features:

- 316 cast stainless steel body, nuts and bolts
- certified to ANSI/NSF 61
- ideal for corrosive environments
- use of suitable anti-galling thread compound is recommended
- Comparable to: Grinnell's #7400 SS

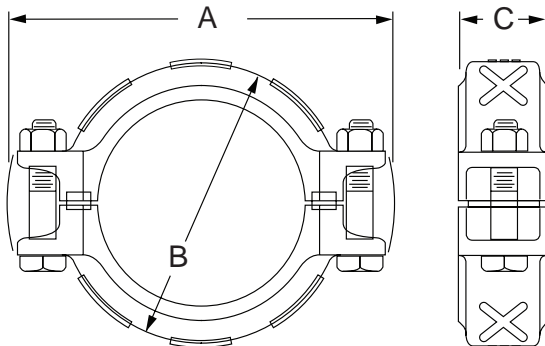

R

Nominal Size	Pipe OD	Maximum Working Pressure	Maximum End Load (Lbs)	Coupling Dimensions			Approx. Weight (lbs.)	Bolts			316 Stainless Steel w/ Fluoro-elastomer gasket Part #	Price/E
				A	B	C		qty	size	length		
2"	2.375	300	1329	5 ³ / ₈ "	3 ³ / ₈ "	1 ³ / ₄ "	2.1	2	3/8"	2 ¹ / ₄ "	RL02V	\$1140.00
3"	3.500	300	2886	6 ⁵ / ₈ "	4 ⁵ / ₈ "	1 ³ / ₄ "	3.1	2	1/2"	2 ³ / ₄ "	RL03V	1430.00
4"	4.500	300	4771	7 ³ / ₄ "	6"	1 ⁷ / ₈ "	4.4	2	1/2"	2 ³ / ₄ "	RL04V	2120.00