

Series NRX Type NF-frame ANSI/UL/IEC low voltage power circuit breaker renewal parts



Contents

Description	Page	Description	Page
Type NF-frame field-installable kits and renewal parts lists		Communication modules	5
Secondary contact wiring kits	2	Primary terminal adapter field option kits for fixed breakers and drawout cassettes	6
Cassette shutter field option kits	2	Bus conductor extensions for fixed, front connected breakers	6
Cassette cell switch field option kits	2	MCCB or Series NRX Type NF-frame code terminals for fixed, front connected breakers	6
Shunt trip field option kits	2	Miscellaneous accessories for breaker and cassette	
Motor operator field option kits (for charging closing spring)	2	Secondary block combinations	7
Spring release device field option kits	3	Adapter and barrier kits	7
Latch check switch (LCS) field option kits	3	Door, levering in, and cassette parts and kits	7
Auxiliary switch field option kits	3	Mechanical interlock parts and kits	7
Undervoltage release field option kits	3	Trip unit replacement kits and parts	8
Trip indicator and bell alarm/overcurrent trip switch field option kits	3	Secondary terminal replacement parts, blocks, and kits	9
Operations counter field option kits	4	Wire harnesses for trip units and communication modules	9
Padlockable pushbutton cover field option kits	4	Breaker replacement parts—miscellaneous	9
Padlock clarification	4	Miscellaneous accessories	9
Breaker key lock provision field option kits	4		
Replacement rating plugs	5		
Neutral current sensor kits	5		



Powering Business Worldwide

Series NRX Type NF-frame field-installable kits and renewal parts list**Table 1. Secondary contact wiring kits**

Field-installation kits for use in wiring fixed breaker or drawout breaker cassette secondary contacts or adding option kits in field.

Description	Kit contents	Catalog number
Drawout secondary terminal block kit	8 blocks	DSBK08
Drawout secondary terminal block kit	20 blocks	DSBK20
Drawout secondary terminal block kit	30 blocks	DSBK30
Fixed secondary terminal block kit	8 blocks	FSBK08
Fixed secondary terminal block kit	20 blocks	FSBK20
Fixed secondary terminal block kit	30 blocks	FSBK30

Note: Please see **Table 22** on **page 7** for secondary block combinations.**Table 2. Cassette shutter field option kits**

Field-installable option kit for drawout cassette for installation by customer.



Breaker frame	Cassette type(s)	Number of poles	Continuous current rating amperes	Shutter kit catalog number
All frames	All types	Three-pole	800–1600	SHTR3P
All frames	All types	Four-pole	800–1600	SHTR4P

Table 3. Cassette cell switch field option kits

Field-installable option kit for drawout cassette for installation by customer.



Description	Catalog number
Three switches; 1 Form C contact per disconnect, test and connect position	NRXCSKT

Table 4. Shunt trip field option kits

Field-installable option kit for fixed or drawout breakers.



Voltage (AC: 50/60 Hz)	Catalog number
110–127 Vac/Vdc	STA
208–250 Vac/Vdc	STR
24 Vdc	STL
48 Vdc	STH
60 Vdc	STS

Note: See **Table 1** to order secondary contact blocks necessary.**Table 5. Motor operator field option kits (for charging closing spring)**

Field-installable option kit for fixed or drawout breakers.

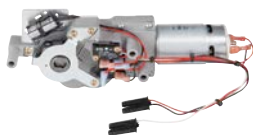

Voltage (AC: 50/60 Hz)	Catalog number
110–127 Vac/Vdc	MOTBW
208–250 Vac/Vdc	MOTPT
24 Vdc	MOTL
48 Vdc	MOTH
60 Vdc	MOTX

Note: See **Table 1** to order secondary contact blocks.

Table 6. Spring release device field option kits

Field-installable option kit for fixed or drawout breakers. Includes SRD assembly with plug-in wires and instructions.



Voltage (AC: 50/60 Hz)	Catalog number
110–127 Vac/Vdc	SRA
208–250 Vac/Vdc	SRR
24 Vdc	SRM
48 Vdc	SRH
60 Vdc	SRS

Note: See **Table 1** to order secondary contact blocks necessary.

Table 7. Latch check switch (LCS) field option kits

Field-installable option kit for fixed or drawout breakers.



Description	Catalog number
Latch check switch for wiring internally to spring release	LCS1
Latch check switch with 1 Form C contact for remote indication	LCS2

Table 8. Auxiliary switch field option kits

Field-installable option kit for fixed or drawout breakers.

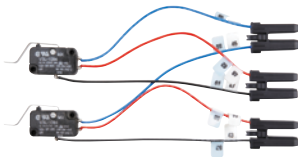

Switch type (Form C)	Catalog number
Two contacts, short leads	NRXAUXKT1
Two contacts, long leads	NRXAUXKT2

Note: Each auxiliary switch requires two secondary blocks. See **Table 1** to order secondary contact blocks.

Table 9. Undervoltage release field option kits

Field-installable option kit for fixed or drawout breakers.



Voltage (AC: 50/60 Hz)	UVR release type	Catalog number
110–127 Vac/110–125 Vdc	Continuous	UVRA
208–240 Vac/220–250 Vdc	Continuous	UVRB
24 Vdc	Continuous	UVRL
48 Vdc	Continuous	UVRH
60 Vdc	Continuous	UVRS

Note: See **Table 1** on **page 2** to order secondary contact blocks.

Table 10. Trip indicator and bell alarm/overcurrent trip switch field option kits

Field-installable option kits for fixed or drawout breakers. For breakers with trip units only, not available on non-automatic breakers.



Trip indication kit description ①	Contacts	Catalog number
Mechanical pop-out trip indicator option kit	None	MTKIT
Interlocked mechanical pop-out trip indicator kit ③	None	IMTKIT
Bell alarm/OTS kit with mechanical trip indicator	2 Form C	BAOTSMT
Bell alarm/OTS contact field option kit ②	2 Form C	BAOTS

① Manual reset only.

② For use with breakers that have mechanical pop-out trip indicator option already installed.

③ Interlock trip indicator requires the trip indicator to be reset before charging and operating the breaker.

Note: See **Table 1** on **page 2** to order secondary contact blocks.

Table 11. Operations counter field option kits

Field-installable option kit for fixed and drawout breakers.



Description	Catalog number
Mechanical counter	NPCOUNTERKIT

Table 12. Padlockable pushbutton cover field option kits

Field-installable option kit for fixed and drawout breakers.



Padlockable cover type ①	Catalog number
Plastic base / plastic doors	NPLPBCP
Metal base / metal doors	NPLPBCM
Plastic base / metal doors	NPLPBCF
Metal base / plastic doors	NPLPBCH
Metal base / plastic doors	NPLPBMOFF

① The cover can be configured to block the Open and Close pushbuttons or just the Close pushbutton.

Table 13. Padlock clarification

Position 18	Frame	Cover	Close button cover type	Open button cover type	Safe off feature	Emergency access feature	Field installable kit
A and N	None	None	None	None	None	None	None
B and J	Plastic	Plastic	Hinged	Hinged	No	No	No
K and L	Metal	Metal	Hinged	Hinged	No	No	No
1 and 2	Metal	Metal	Hinged	Hinged	Yes ①	No	No
Kits	Plastic	Plastic	Hinged	Hinged	No	No	Yes
	Plastic	Metal	Hinged	Hinged	No	No	Yes
	Metal	Metal	Hinged	Hinged	No	No	Yes
	Metal	Plastic	Hinged	Hinged	No	No	Yes
	Metal	Metal	Hinged	Hinged	Yes ①	No	Yes

① When padlocked, the cover depresses the Open pushbutton, preventing manual or electric breaker closing.

Table 14. Breaker key lock provision field option kits

Field-installable option kit for fixed and drawout breakers.



Castell



HF Securite (Ronis)



Kirk



CES

Lock type	Use with customer supplied lock and key number	Catalog number
Castell	—	NCASTELLKIT
HF Securite (Ronis)	PBA90GEL3000	NRONISKIT
Kirk	KC40.10	NKIRKKIT
CES	—	NCESKIT

Note: Lock not provided by Eaton.

Table 15. Replacement rating plugs

Field-installation rating plug on fixed or drawout breakers.



Ampere rating	Frame size in (maximum)		
	630–800 A ①	1000–1250 A ①	1600 A ①
	Group A rating plugs	Group B rating plugs	Group C rating plugs
	Catalog number	Catalog number	Catalog number
I _n of rating plug	—	—	—
200	NA200T	—	—
250	NA250T	—	—
300	NA300T	—	—
400	NA400T	NB400T	—
500	NA500T	NB500T	—
600	NA600T	NB600T	—
630	NA630T ①	NB630T ①	—
800	NA800T	NB800T	NC800T
1000	—	NB1000T	NC1000T
1200	—	NB1200T	NC1200T
1250	—	NB1250T ①	NC1250T ①
1600	—	—	NC1600T ①

① IEC only (not UL listed).

Note: Rating plug must be selected based on breaker frame rating.

Table 16. Neutral current sensor kits

Field-installable external accessory for fixed or drawout breakers. Fourth current sensor for mounting on enclosure neutral in three-pole breaker ground-fault applications on three-phase, four-wire systems.



Sensor rating	Sensor qty. required per three-pole breaker	Style number
All ratings	1	NFNCTKIT

Table 17. Communication modules



Communications type	Catalog number
Eaton INCOM™	ICAM
Modbus®	MCAM
PROFIBUS®	PCAM
Ethernet	ECAM

Table 18. Primary terminal adapter field option kits for fixed breakers and drawout cassettes

Field installation kit for changing fixed breakers to desired bus configurations; all ratings and frames.

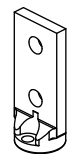
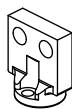

Terminal description	Breaker terminals	Connection type	Number of poles	Continuous current rating amperes	Catalog number
Short horizontal/vertical kit	Upper and lower terminals	Rear mount	Three-pole	630–1600	SADP316
Short horizontal/vertical kit	Upper and lower terminals	Rear mount	Four-pole	630–1600	SADP413
Long horizontal/vertical kit	Upper and lower terminals	Rear mount	Three-pole	630–1600	LADP316
Long horizontal/vertical kit	Upper and lower terminals	Rear mount	Four-pole	630–1600	LADP416

Table 19. Primary terminal adapter field option kits for fixed breakers and drawout cassettes

Field installation kit for changing fixed breakers to desired bus configurations; all ratings and frames.

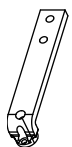
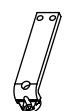

Terminal description	Number of poles	Continuous current rating amperes	Catalog number
Rear connect adapter kit, long, 6 per box	Three-pole	630–1600	LBADPU316
Rear connect adapter kit, long, 8 per box	Four-pole	630–1600	LBADPU416
Rear connect adapter kit, short, 6 per box	Three-pole	630–1600	SBADPI316

Table 20. Bus conductor extensions for fixed, front connected breakers

Terminal description	Number of poles	Interruption rating	Catalog number
Bus conductor extension for front connect	Three-pole	42 kA and below	NRXBUSEXT
Bus conductor extension for front connect	Three-pole	50 kA and below	NRXBUSEXT503
Bus conductor extension for front connect	Four-pole	50 kA and below	NRXBUSEXT504
Bus conductor extension for front connect	Three-pole	65 kA and below	NRXBUSEXT653
Bus conductor extension for front connect	Four-pole	65 kA and below	NRXBUSEXT654

Table 21. MCCB or Series NRX Type NF-frame code terminals for fixed, front connected breakers

Terminal description	Wire size (number of conduct)	Catalog number
Cable connect adapters	500 kcmil #1–500 (2)	TA700NB1M ①②
Cable connect adapters	400 kcmil 3/0–400 (3)	TA1000NB1M ①②
Cable connect adapters	500 kcmil 4/0–500 (4)	TA1200NB1M ①②
Cable connect adapters	750 kcmil 3/0–750 (3)	TA1201NB1M

① Only metric MCCB terminals can be used on the Series NRX front connect at this time.

② Order two per pole.

Miscellaneous accessories for breaker and cassette

Table 22. Secondary block combinations

Accessory	Required secondary blocks
Shunt trip	1
Motor operator	2
Spring release	1
Latch check switch (wired external)	2
Undervoltage release	1
Second shunt trip	1
Two auxiliary switches	3
Four auxiliary switches	6
Bell alarm/OTS	3
Communication module	2
520 style trip unit	2 ①

① Included in all breakers.

Table 23. Adapter and barrier kits



Description	Number of poles	Catalog number
Cassette phase barriers	3	3DBAR
Cassette phase barriers	4	4DBAR
Rear connect phase barriers	3	3RBAR
Rear connect phase barriers	4	4RBAR

Table 24. Door, levering in, and cassette parts and kits

Description	Catalog number
Cassette rejection kid	CREJBRKIT
Drawout door escutcheon and gasket kit	DEGK
Fixed door escutcheon and gasket kit	FEGK
Levering in device tool	LVIN
Three-pole levering in device	NRXLEVIN3
Four-pole levering in device	NRXLEVIN4
Cassette extension rails	NRXRAILS

Table 25. Mechanical interlock parts and kits

Description	Catalog number
Mechanical interlock kit, 2-way, drawout	NFMI2D
Mechanical interlock kit, 3-way, type 31, drawout	NFMI31D
Mechanical interlock kit, 3-way, type 32, drawout	NFMI32D
Mechanical interlock kit, 3-way, type 33, drawout	NFMI33D
Mechanical interlock kit, 2-way, fixed	NFMI2F
Mechanical interlock kit, 3-way, type 31, fixed	NFMI31F
Mechanical interlock kit, 3-way, type 32, fixed	NFMI32F
Mechanical interlock kit, 3-way, type 33, fixed	NFMI33F
Mechanical interlock cable 5 feet	NRXMIC5
Mechanical interlock cable 6 feet	NRXMIC6
Mechanical interlock cable 8 feet	NRXMIC8
Mechanical interlock cable 10 feet	NRXMIC10

Table 26. Trip unit replacement kits and parts

Description	Style number
Series NRX Digitrip 520 replacement cover (with hardware)	5722B23G01
Series NRX 1150 catalog number N11RLSIG trip unit kit	66B3150G01
Series NRX 1150 catalog number N11RLSI trip unit kit	66B3150G02
Series NRX 1150 RLSIA trip unit kit	66B3150G03
Series NRX 1150 IEC trip unit kit	66B3150G04
Series NRX 1150 catalog number N11IECEF trip unit kit	66B3150G05
Series NRX 1150 catalog number N11RIEC trip unit kit	66B3150G06
Series NRX 1150 catalog number RIECEF trip unit kit	66B3150G07
Series NRX 1150 catalog number N11LSIG trip unit kit	66B3150G08
Series NRX 1150 catalog number N11LSI trip unit kit	66B3150G09
Series NRX 1150 catalog number N11LSIA trip unit kit	66B3150G10
Series NRX 520 catalog number 5NLSIG	70C1591G02
Series NRX 520 catalog number N5LSI	70C1591G04
Series NRX 520 catalog number N5LSIG	70C1591G05
Series NRX 520 catalog number N5LI	70C1591G06
Series NRX 520 catalog number N5MLSI	70C1591G11
Series NRX 520 catalog number N5MLSIG	70C1591G12
Series NRX 520 catalog number N5MLSIA	70C1591G13
Series NRX 520 catalog number N5MLSI	70C1591G14
Series NRX 520 catalog number N5MLSIG	70C1591G15
Series NRX 520 catalog number N5MLSIA	70C1591G16
Series NRX 520 catalog number N5MRLSI	70C1591G51
Series NRX 520 catalog number N5MRLSIG	70C1591G52
Series NRX 520 catalog number N5MRLSIA	70C1591G53
Series NRX 520 catalog number N5MRLSI	70C1591G54
Series NRX 520 catalog number N5MRLSIG	70C1591G55
Series NRX 520 catalog number N5MRLSIA	70C1591G56

① Contact 800-ETN-CARE for pricing and availability.

Catalog number references

Symbol	Function/protection
M	Metering function
R	Arcflash Reduction Maintenance System™ Maintenance Mode function
L	Long time trip (overload)
S	Short time trip
I	Instantaneous trip
G	Ground (Earth) fault trip
A	Ground (Earth) Alarm only

Table 27. Secondary terminal replacement parts, blocks, and kits



Description	Style number
Cassette secondary terminal block comb	65A2675G01
Weidmuller drawout terminal block	66B2508G01
Weidmuller fixed terminal block	66B2510G01
Rear connect adapter—short	66B2512H01

① Contact 800-ETN-CARE for pricing and availability.

Table 28. Wire harnesses for trip units and communication modules

Description	Style number
Cam module cable assembly	5723B54G10
Aux power / GF source wire harness	66B2832G27
Communications wire harness	66B2832G29
GF source enable wire harness	66B2832G28
N-frame wire harness—aux power/GFs	66B3090G01
N-frame wire harness—PT module	66B2832G35
NF-frame wire harness kit	66B3150G11
Relay alarm wire harness	66B2832G25
Zone interlock jumper wire harness	66B2832G30
Zone interlock wire harness	66B2832G26

① Contact 800-ETN-CARE for pricing and availability.

Table 29. Breaker replacement parts—miscellaneous

Description	Style number
Series NRX N-frame replacement charging handle	65A3059G01
Terminal shield kit accessory for NRX NF	NRXNFTSI
Series NRX 1150 PT module	6D32438G01

Table 30. Miscellaneous accessories

Description	Kit contents/accessory function	Catalog number
Breaker trip unit test devices and accessories		
Trip unit test kit	120 Vac portable test kit for Digitrip 520, 520M	MTK1000
Hand-held test kit	120 Vac, 240 Vac hand-held test kit for Digitrip 520, 520M, and 1150 series trip units	MTST230V
Breaker trip unit test devices and accessories		
NF wire harness kit	Harness to upgrade from 520 to 1150 trip units	66B3150G11
Miscellaneous breaker and enclosure accessories		
Fixed breaker mounting feet kit	Replacement mounting feed for fixed breakers	NRXMTGFEET
Surface mount hardware kit	Hardware to surface mount NF breaker to panel	NFSMHKIT
Replacement charging handle	To replace damaged or broken charging handle	65A3059G01
Accessory tray	To replace damaged or broken accessory tray	LTTRAY
Ground fault/zero sequence sensor kit	External sensor to detect source ground/zero sequence faults	NFGFSKIT
Residual/neutral ground sensor kit	External sensor to detect residual ground faults	NFNCTKIT

Eaton
1000 Eaton Boulevard
Cleveland, OH 44122
United States
Eaton.com

© 2016 Eaton
All Rights Reserved
Printed in USA
Publication No. TD013014EN / Z17712
January 2016