

Metallics

An **AMERICAN** Source For Premier
and Innovative Fasteners and Anchors

HEX NYLON INSERT LOCK NUTS – 18-8 STAINLESS STEEL AND 316 STAINLESS STEEL

The following Specification Sheet applies to all **Hex Lock Nuts – 18-8 Stainless Steel and 316 Stainless Steel** in our **JNYN** series.

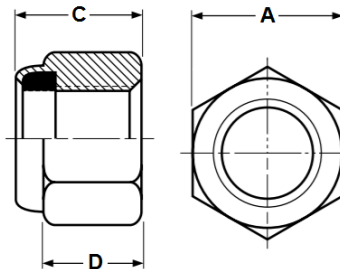

Size	C		A		D
	Thickness		Width Across Flats		Hex Height
	Max.	Min.	Max.	Min.	Min.
8	.239	.219	.345	.336	.140
10	.249	.229	.376	.367	.140
12	.328	.298	.439	.430	.225
1/4	.328	.298	.439	.430	.225
5/16	.359	.329	.502	.489	.250
3/8	.468	.438	.564	.551	.335
7/16	.468	.438	.627	.616	.324
1/2	.609	.579	.752	.736	.464
5/8	.765	.735	.940	.922	.593
3/4	.890	.860	1.064	1.052	.742

Metallics

229 Cross Street
Bristol, CT 06010

www.metallics.us

Phone: 860 589-4186 Toll Free: 800 243-8272

Fax: 860 584-1008 Toll Free Fax: 800 831-9358

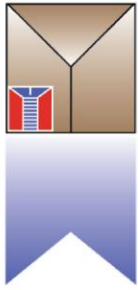

Metallics

An **AMERICAN** Source For Premier
and Innovative Fasteners and Anchors

SPECIFICATION REQUIREMENTS:

18-8 STAINLESS STEEL

- Dimensions: Per ASME B18.16.6
- Material: 18-8 Stainless Steel meeting a Rockwell Hardness of B95 to C35. Nylon 6/6 material shall be in compliance with current RoHS European Union Directive
- Performance: Prevailing torque per QA7-95
- Thread Requirements: ASME B1.1, UNC & UNF, Class 2B
- Finish: Surface condition per ASTM A380/A380M, and waxed. Wax shall contain a tracer element that is visible under black light.

316 STAINLESS STEEL

- Dimensions: Per ASME B18.16.6
- Material: 316 Stainless Steel
- Mechanical Properties: Alloy Group 2, Condition CW per ASTM F594. Nylon 6/6 material shall be in compliance with current RoHS European Union Directive
- Performance: Prevailing torque per QA7-95
- Thread Requirements: ASME B1.1, UNC & UNF, Class 2B
- Product Marking: Manufacturer's ID and 316 for all sizes 3/8" and above
- Finish: Surface condition per ASTM A380/A380M and waxed. Wax to contain a tracer element visible under black light

Metallics

229 Cross Street
Bristol, CT 06010

www.metallics.us

Phone: 860 589-4186 Toll Free: 800 243-8272

Fax: 860 584-1008 Toll Free Fax: 800 831-9358