

Viega ProPress® Ball Valve - Zero Lead* Model 2971.1 ZL

Description

The Zero Lead bronze ball valve is equipped with a full port, Zero Lead bronze body. The ball valve features EPDM sealing elements, EPDM stem seals and Viega's Smart Connect® technology for easy identification of unpressed connections during pressure testing.

Features

- 316 stainless steel ball
- Eco Brass® blowout-proof stem
- Lockable metal handle
- Reinforced PTFE seats
- Smart Connect technology

Ratings

- 250 CWP
- Temperature Range: 0°F - 250°F
- Max. Operating Pressure: 250 psi

Approvals

- Conforms to MSS SP-110
- NSF - UP Code
- NSF 61 Annex G
- ASME A112.4.14
- Listed by NSF to Commercial Hot

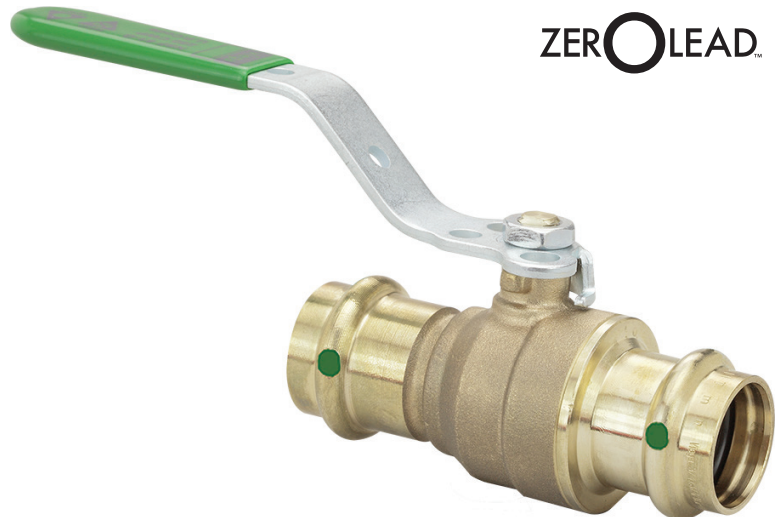

Component	Material
Body	Zero Lead Bronze C87700
Ball	316 Stainless Steel
Seat	Reinforced PTFE
Stem	Eco Brass C69300
Stem Seals	EPDM
Nut	Zinc plated Steel
Handle	Zinc plated Steel
Handle Cover	Polyvinyl
Sealing Element	EPDM

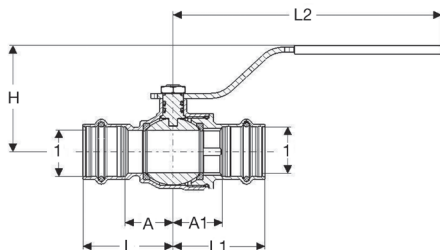

Part No.	Size (1)	A (in)	A1 (in)	L (in)	L1 (in)	L2 (in)	H (in)
79920	1/2"	0.75	0.75	1.57	1.57	4.57	1.97
79925	3/4"	0.85	0.87	1.75	1.77	4.57	2.09
79930	1"	1.02	1.06	1.93	1.96	5.75	2.46
79935	1 1/4"	1.14	1.12	2.17	2.15	5.75	2.67

*Zero Lead identifies Viega® products meeting the lead free requirements of NSF 61-G through testing under NSF/ANSI 372 (0.25% or less maximum weighted average lead content).

Viega products are designed to be installed by licensed and trained plumbing and mechanical professionals who are familiar with Viega products and their installation. Installation by non-professionals may void Viega LLC's warranty.

This document is subject to updates. For the most current Viega technical literature please visit www.viega.us.

Viega LLC • 585 Interlocken Blvd. • Broomfield, CO 80021 • Phone (800) 976-9819 • www.viega.us