

Viega ProPress® Ball Valve Model 2973

Description

Viega ProPress model 2973 is a full port ball valve intended for hydronic and non-potable applications. The ball valve features EPDM sealing elements, EPDM stem seals and Viega's Smart Connect® feature for easy identification of unpressed connections during pressure testing.

Features

- Chrome-plated brass ball
- Blowout-proof stem
- Reinforced PTFE seats
- Smart Connect feature
- ProPress connections

Ratings

- 250 CWP
- Temperature range: 0°F - 250°F
- Max. operating pressure: 200 psi

Approvals

- Conforms to MSS SP-110
- NSF-U.P. Code
- IGC-157

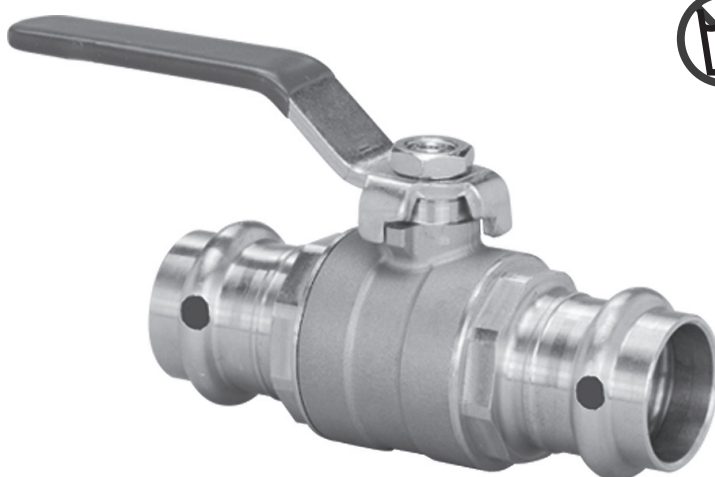

Component	Material
Body	Brass C37700
Ball	Chrome-plated Brass
Seat	Reinforced PTFE
Stem	Brass C37700
Stem Seals	EPDM
Nut	Zinc-plated Steel
Handle	Zinc-plated Steel
Handle Cover	Polyvinyl
Sealing Element	EPDM

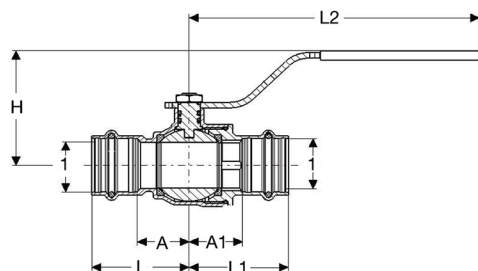

Part Number	1	Z (in)	Z1 (in)	L (in)	L1 (in)	L2 (in)	H (in)
24000	½"	0.83	0.83	1.58	1.58	3.94	1.69
24005	¾"	0.95	0.95	1.86	1.86	4.72	1.97
24010	1"	1.18	1.18	2.09	2.09	4.72	2.13
24015	1¼"	1.29	1.29	2.31	2.31	6.22	2.87
24020	1½"	1.39	1.39	2.81	2.81	6.22	3.11
24025	2"	1.85	1.85	3.43	3.43	6.22	3.46

NOTE: Model 2973 is for use in non-potable applications. For NSF-61G compliant valves refer to Viega ProPress models 2971.1ZL and 2971.3ZL

This document subject to updates. For the most current Viega technical literature please visit www.viega.us.
Click Services -> Click Electronic Literature Downloads -> Select Product Line -> Select Desired Document

Viega LLC, 100 N. Broadway, 6th Floor • Wichita, KS 67202 • Ph: 800-976-9819 • Fax: 316-425-7618