



Professional Series Sump Pump Model 53

**Zoeller's time proven quality
and an industry fixture**

Features:

- 3-year warranty
- 2-pole mechanical switch
- 3/10 HP 115V sump pump
- Performance up to 19.25' TDH
- Flows up to 43 gallons per minute
- Cast iron switch case, motor and pump housing
- Engineered thermoplastic base
- Corrosion-resistant, powder coated epoxy paint



100% factory tested



zoellerpumps.com

FM2958

PRODUCT SPECIFICATIONS

| | | |
|------------------|----------------------|---|
| MOTOR | Horse Power | 3/10 |
| | Voltage | 115 or 230 |
| | Phase | 1 Ph |
| | Hertz | 60 Hz |
| | RPM | 1550 |
| | Type | Shaded pole |
| | Insulation | Class B |
| | Amps | 4.8 - 9.7 |
| PUMP | Operation | Automatic or nonautomatic |
| | Auto On/Off Points | 7-1/4" (18.4 cm) / 3" (7.6 cm) |
| | Discharge Size | 1-1/2" NPT |
| | Solids Handling | 1/2" (12 mm) spherical solids |
| | Cord Length | 9' (3 m) automatic, 15' (5 m) nonautomatic |
| | Cord Type | UL listed, 3-wire, grounded plug |
| | Max. Head | 19.25' (5.9 m) |
| | Max. Flow Rate | 43 GPM (163 LPM) |
| | Max. Operating Temp. | 130° F (54° C) |
| | Cooling | Oil filled |
| | Motor Protection | Auto reset thermal overload |
| MATERIALS | Cap | Cast iron or bronze |
| | Motor Housing | Cast iron or bronze |
| | Pump Housing | Cast iron or bronze |
| | Base | Cast iron, bronze or engineered thermoplastic |
| | Upper Bearing | Sleeve bearing |
| | Lower Bearing | Sleeve bearing |
| | Mechanical Seals | Carbon and ceramic |
| | Impeller Type | Non-clogging vortex |
| | Impeller | Plastic, cast iron or bronze |
| | Hardware | Stainless steel |
| | Motor Shaft | AISI 1215 cold rolled steel |
| | Gasket | Neoprene |

NOTE: See model comparison chart for specific details.

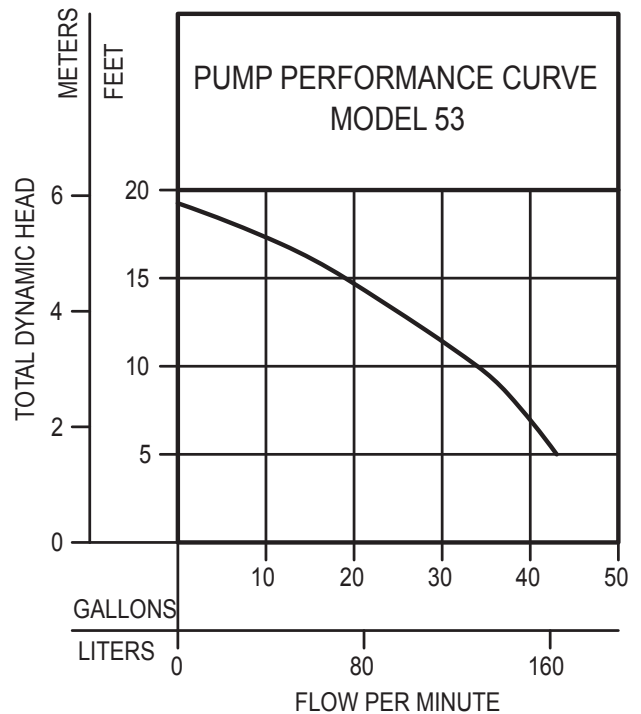
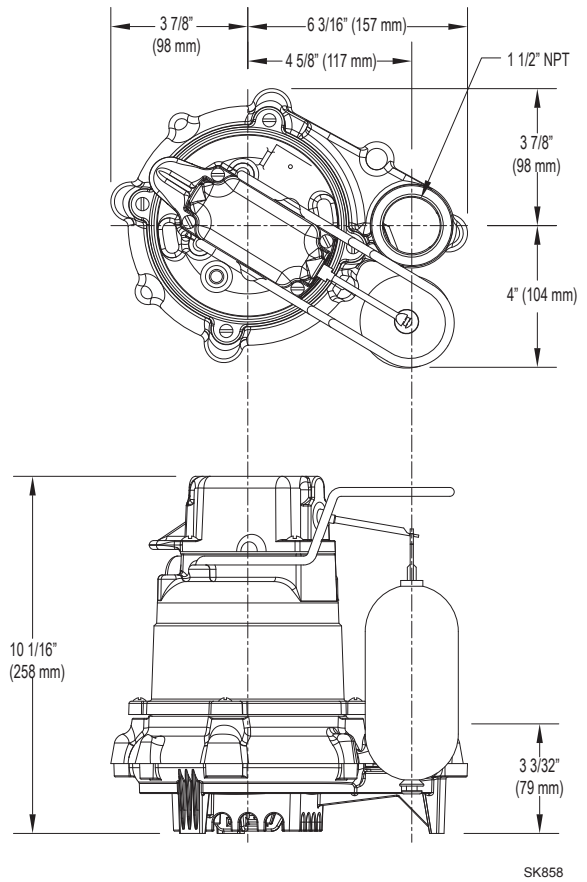

⚠ CAUTION

All installation of controls, protection devices and wiring should be done by a qualified licensed electrician. All electrical and safety codes should be followed including the most recent National Electrical Code (NEC) and the Occupational Safety and Health Act (OSHA).