

Part No: 354-151F

Fabricated Fittings

Flanges and Cut in Kits

Desc: 16X15.300 PVC FLG PIP SOC CL150

MSRP: 1999.9

Part Code: 320

Weight(lbs): 47.276

Weight(kg): 21.444

Weight(gm): 21444

Size: 16"X15.300"

Color: GRAY

Material: PVC

Joint Style PIP

Connection Socket

Ring Plastic

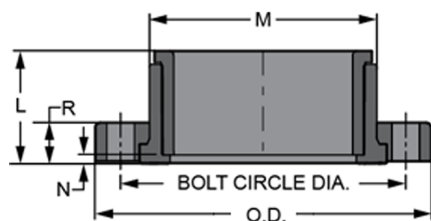

L = 8-11/16

M = 17- 3/4

N = 11/16

O.D. = 23- 1/2

R = 2- 3/8

No of Bolts = 16

Bolt Circle Dia. = 21- 1/4

Bolt Size = 1

Fabricated Dimension References:

G = (LAYING LENGTH) intersection of center lines to bottom of socket/thread; 90° elbows, tees, crosses; ± 1/4 & larger ± 1/2 inch.

H = Intersection of center lines to face of fitting; 90° elbows, tees, crosses; ± 1/4 inch.; wyes ± 1/2 inch; 14" & larger inch.

J = Intersection of center lines to bottom of socket/thread; 45° elbows; ± 1/4 inch; 14" & larger ± 1/2 inch.

L = Overall length of fittings; ± 1/2 inch; wyes ± 1 inch; 14" & larger ± 1 inch.

M = Outside diameter of socket/thread hub; ± 1/4 inch.

N = Socket bottom to socket bottom; couplings; ± 1/2 inch.

W = Height of cap; ± 1/4 inch.

Typical Fabricated Dimension References

