

**Part No:** 869V-664SR

**Schedule 80 PVC & CPVC**

**Clamp-On Saddle**

**Desc:** 12X4 PVC CLAMP SADDLE D/O SRFPT FKM ZN

**MSRP:** 842.4

**Part Code:** 086

**Weight(lbs):** 16.898

**Weight(kg):** 7.665

**Weight(gm):** 7665

**Size:** 12"X4"

**Color:** GRAY

**Material:** PVC

**Connection** Double SR Fipt

**Type** Clamp Saddle

**Hardware** Zinc

**O-Ring** FKM

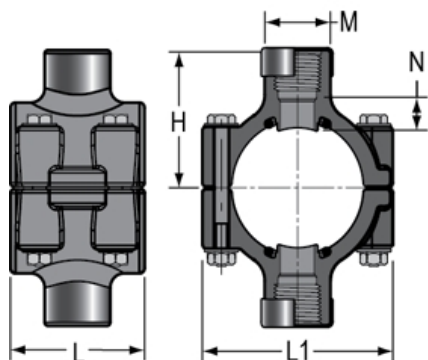

**H** = 9-1/2

**L** = 8- 1/2

**L1** = 14-1/4

**M** = 5- 1/4

**N** = 1- 5/8

**Bolt** = 10

**Hole Size** = 4

**No of** = 6

**Bolts**

**Torque**  
**FT./LBS.**

## Injection Molded Dimension References:

**G** = (LAYING LENGTH) intersection of center lines to bottom of socket/thread; 90° elbows, tees, crosses;  $\pm 1/32$  inch.

**H** = Intersection of center lines to face of fitting; 90° elbows tees, crosses;  $\pm 1/32$  inch.

**J** = Intersection of center lines to bottom of socket/thread; 45° elbows;  $\pm 1/32$  inch

**L** = Overall length of fittings;  $\pm 1/16$  inch.

**M** = Outside diameter of socket/thread hub;  $\pm 1/16$  inch.

**N** = Socket bottom to socket bottom; couplings;  $\pm 1/16$  inch.

**W** = Height of cap;  $\pm 1/16$  inch

## Typical Molded Dimension References

