

Part No: 869V-527CSR

Schedule 80 PVC & CPVC

Clamp-On Saddle

Desc: 6X1-1/2 CPVC CLAMP SADDLE D/O SRFPT VITN

MSRP: 403.16

Part Code: 096

Weight(lbs): 4.054

Weight(kg): 1.839

Weight(gm): 1839

Size: 6"X1-1/2"

Color: GRAY

Material: CPVC

Connection Double SR Fipt

Type Clamp Saddle

Hardware Zinc

O-Ring FKM

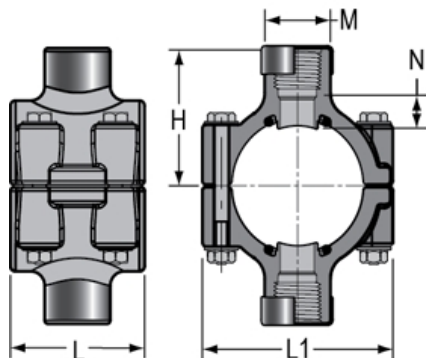

Bolt = 10
Torque
FT./LBS.

Hole Size = 2-1/4

No of = 4
Bolts

H = 5-3/4

L = 4- 1/8

L1 = 8-3/16

M = 3-1/32

N = 1-7/16

Injection Molded Dimension References:

G = (LAYING LENGTH) intersection of center lines to bottom of socket/thread; 90° elbows, tees, crosses; $\pm 1/32$ inch.

H = Intersection of center lines to face of fitting; 90° elbows tees, crosses; $\pm 1/32$ inch.

J = Intersection of center lines to bottom of socket/thread; 45° elbows; $\pm 1/32$ inch

L = Overall length of fittings; $\pm 1/16$ inch.

M = Outside diameter of socket/thread hub; $\pm 1/16$ inch.

N = Socket bottom to socket bottom; couplings; $\pm 1/16$ inch.

W = Height of cap; $\pm 1/16$ inch

Typical Bushing Dimension References

