

Part No: 3775-626

Fabricated DWV

Wyes

Desc: 10X6 PVC RED WYE SOC SCH40 N.P.R.

MSRP: 507.38

Part Code: 390

Weight(lbs): 21.471

Weight(kg): 9.739

Weight(gm): 9739

Size: 10 X 6

Color: WHITE

Material: PVC

Schedule SCH 40 DWV

Connection Socket X Socket X Socket

Type Reducing Wye

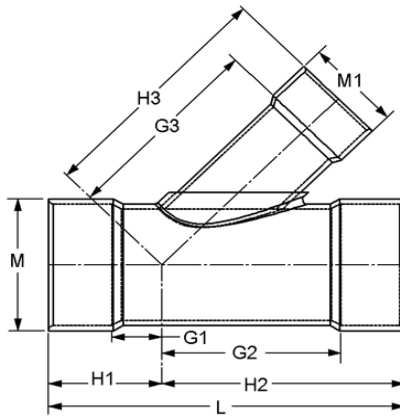

G1 = 3-1/2

G2 = 14-1/4

H1 = 8-3/4

H2 = 19-1/2

H3 = 17-1/2

L = 28-1/4

M = 11-1/2

M1 = 7-3/16

G3 = 14-1/4

Fabricated Dimension References:

G = (LAYING LENGTH) intersection of center lines to bottom of socket/thread; 90° elbows, tees, crosses; $\pm 1/4$ & larger $\pm 1/2$ inch.

H = Intersection of center lines to face of fitting; 90° elbows, tees, crosses; $\pm 1/4$ inch.; wyes $\pm 1/2$ inch; 14" & larger inch.

J = Intersection of center lines to bottom of socket/thread; 45° elbows; $\pm 1/4$ inch; 14" & larger $\pm 1/2$ inch.

L = Overall length of fittings; $\pm 1/2$ inch; wyes ± 1 inch; 14" & larger ± 1 inch.

M = Outside diameter of socket/thread hub; $\pm 1/4$ inch.

N = Socket bottom to socket bottom; couplings; $\pm 1/2$ inch.

W = Height of cap; $\pm 1/4$ inch.

Typical Fabricated Dimension References

