

Part No: 852-012

Flanges & Cut-In Kit

Molded

Desc: 1-1/4 PVC ONE-PIECE FLG FPT CL150 150PSI

MSRP: 107.31

Part Code: 080

Weight(lbs): 0.437

Weight(kg): 0.198

Weight(gm): 198

Size: 1-1/4"

Color: GRAY

Material: PVC

Connection Fipt (One Piece)

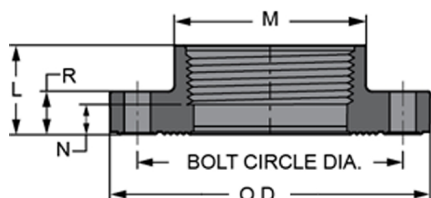

L = 1- 3/8

Bolt Circle Dia. = 3- 1/2

Bolt Size = 1/2

M = 2- 7/32

N = 17/32

O.D. = 4- 5/8

R = 23/32

No of Bolts = 4

Injection Molded Dimension References:

G = (LAYING LENGTH) intersection of center lines to bottom of socket/thread; 90° elbows, tees, crosses; ± 1/32 inch.

H = Intersection of center lines to face of fitting; 90° elbows tees, crosses; ± 1/32 inch.

J = Intersection of center lines to bottom of socket/thread; 45° elbows; ± 1/32 inch

L = Overall length of fittings; ± 1/16 inch.

M = Outside diameter of socket/thread hub; ± 1/16 inch.

N = Socket bottom to socket bottom; couplings; ± 1/16 inch.

W = Height of cap; ± 1/16 inch

Typical Molded Dimension References

