

Part No: 3920-200C

Fabricated CPVC Schedule 80 Crosses
DWV

Desc: 20 CPVC CROSS SOC SCH80

MSRP: 27098.16

Part Code: 099

Weight(lbs): 249.976

Weight(kg): 113.387

Weight(gm): 113387

Size: 20

Color: GRAY

Material: CPVC

Type Standard

Connection Soc x Soc x Soc x Soc

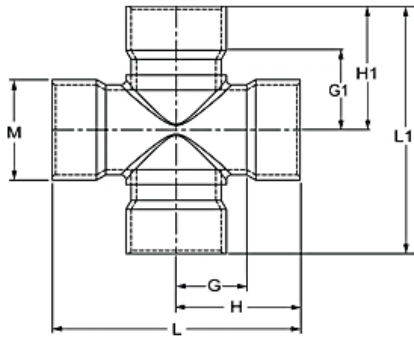

G = 16-3/8

G1 = 16-3/8

H = 26-3/8

H1 = 26-3/8

L = 52-3/4

M = 22-1/16

L1 = 52-3/4

Fabricated Dimension References:

G = (LAYING LENGTH) intersection of center lines to bottom of socket/thread; 90° elbows, tees, crosses; $\pm 1/4$ & larger $\pm 1/2$ inch.

H = Intersection of center lines to face of fitting; 90° elbows, tees, crosses; $\pm 1/4$ inch.; wyes $\pm 1/2$ inch; 14" & larger inch.

J = Intersection of center lines to bottom of socket/thread; 45° elbows; $\pm 1/4$ inch; 14" & larger $\pm 1/2$ inch.

L = Overall length of fittings; $\pm 1/2$ inch; wyes ± 1 inch; 14" & larger ± 1 inch.

M = Outside diameter of socket/thread hub; $\pm 1/4$ inch.

N = Socket bottom to socket bottom; couplings; $\pm 1/2$ inch.

W = Height of cap; $\pm 1/4$ inch.

Typical Fabricated Dimension References

