

**Part No:** 3977-904

**Fabricated DWV**

**Combo Wye & 1/8 Bend**

**Desc:** 24X4 PVC RED COMB WYE&1/8 BEND SOC SCH80

**MSRP:** 4604.27

**Part Code:** 400

**Weight(lbs):** 222.466

**Weight(kg):** 100.909

**Weight(gm):** 100909

**Size:** 24 X 4

**Color:** GRAY

**Material:** PVC

**Schedule** SCH 80 DWV-Reducing

**Connection** Socket x Socket x Socket

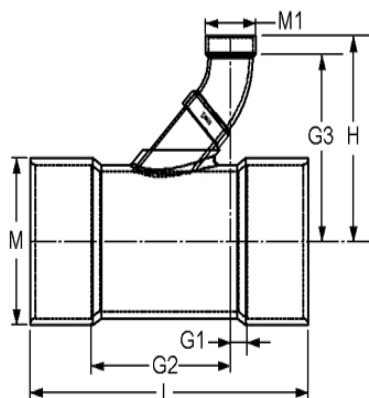

**M** = 26-7/16

**M1** = 5-1/4

**G1** = 3-3/16

**G2** = 14-3/16

**G3** = 18-1/4

**H** = 20-1/2

**L** = 42

## Injection Molded Dimension References:

**G** = (LAYING LENGTH) intersection of center lines to bottom of socket/thread; 90° elbows, tees, crosses; ± 1/32 inch.

**H** = Intersection of center lines to face of fitting; 90° elbows tees, crosses; ± 1/32 inch.

**J** = Intersection of center lines to bottom of socket/thread; 45° elbows; ± 1/32 inch

**L** = Overall length of fittings; ± 1/16 inch.

**M** = Outside diameter of socket/thread hub; ± 1/16 inch.

**N** = Socket bottom to socket bottom; couplings; ± 1/16 inch.

**W** = Height of cap; ± 1/16 inch

## Typical Molded Dimension References

