

**Part No:** 3792-628

**Fabricated DWV**

**Double Wye**

**Desc:** 10X8 PVC RED DBL CMB Y&1/8 BND SOC SCH40

**MSRP:** 756.26

**Part Code:** 390

**Weight(lbs):** 44.734

**Weight(kg):** 20.291

**Weight(gm):** 20291

**Size:** 10"X10"X8"X8"

**Color:** WHITE

**Material:** PVC

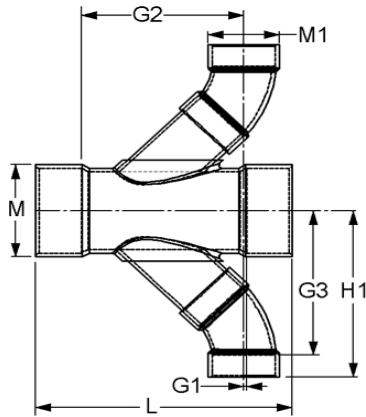

**Schedule** SCH 40 DWV

**Type** Reducing Double Combo Wye  
With 1/8 Bend

**Connection** Socket x Socket x Socket x Socket

**G1** = 3/4

**G2** = 20- 1/4

**G3** = 17-1/8

**H1** = 21-3/16

**L** = 31-1/2

**M** = 11-1/2

**M1** = 9-3/8

## Fabricated Dimension References:

**G** = (LAYING LENGTH) intersection of center lines to bottom of socket/thread; 90° elbows, tees, crosses;  $\pm 1/4$  & larger  $\pm 1/2$  inch.

**H** = Intersection of center lines to face of fitting; 90° elbows, tees, crosses;  $\pm 1/4$  inch.; wyes  $\pm 1/2$  inch; 14" & larger inch.

**J** = Intersection of center lines to bottom of socket/thread; 45° elbows;  $\pm 1/4$  inch; 14" & larger  $\pm 1/2$  inch.

**L** = Overall length of fittings;  $\pm 1/2$  inch; wyes  $\pm 1$  inch; 14" & larger  $\pm 1$  inch.

**M** = Outside diameter of socket/thread hub;  $\pm 1/4$  inch.

**N** = Socket bottom to socket bottom; couplings;  $\pm 1/2$  inch.

**W** = Height of cap;  $\pm 1/4$  inch.

## Typical Fabricated Dimension References

