

Part No: 855-080F

Fabricated Fittings

Flanges and Cut in Kits

Desc: 8 PVC VAN STONE FLANGE FPT CL150

MSRP: 535.44

Part Code: 083

Weight(lbs): 11.72

Weight(kg): 5.316

Weight(gm): 5316

Size: 8"

Color: GRAY

Material: PVC

Joint Style Fipt (2 Piece Van Stone)

Connection Fipt

Ring Plastic

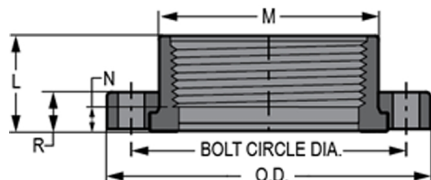

L = 8- 1/8

M = 9- 5/16

N = 6- 7/16

O.D. = 13- 1/2

R = 1- 1/2

No of Bolts = 8

Bolt Circle Dia. = 11- 3/4

Bolt Size = 3/4

Fabricated Dimension References:

G = (LAYING LENGTH) intersection of center lines to bottom of socket/thread; 90° elbows, tees, crosses; ± 1/4 & larger ± 1/2 inch.

H = Intersection of center lines to face of fitting; 90° elbows, tees, crosses; ± 1/4 inch.; wyes ± 1/2 inch; 14" & larger inch.

J = Intersection of center lines to bottom of socket/thread; 45° elbows; ± 1/4 inch; 14" & larger ± 1/2 inch.

L = Overall length of fittings; ± 1/2 inch; wyes ± 1 inch; 14" & larger ± 1 inch.

M = Outside diameter of socket/thread hub; ± 1/4 inch.

N = Socket bottom to socket bottom; couplings; ± 1/2 inch.

W = Height of cap; ± 1/4 inch.

Typical Fabricated Dimension References

