

Part No: 806-180F

Fabricated Fittings

Elbow

Desc: 18 PVC 90 ELL SOC SCH80 FAB

MSRP: 4111.49

Part Code: 083

Weight(lbs): 164.981

Weight(kg): 74.834

Weight(gm): 74834

Size: 18"

Color: GRAY

Material: PVC

Schedule SCH 80

Angle 90 Degree

Connection Socket X Socket

Type Standard

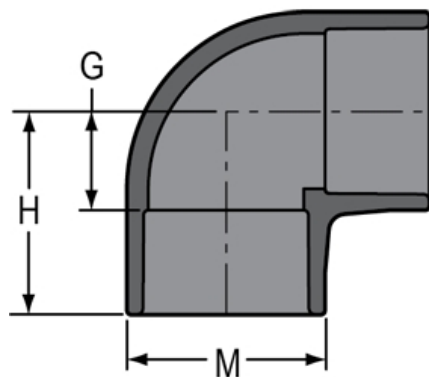

G = 17-11/16

H = 26-11/16

M = 19- 7/8

Fabricated Dimension References:

G = (LAYING LENGTH) intersection of center lines to bottom of socket/thread; 90° elbows, tees, crosses; ± 1/4 & larger ± 1/2 inch.

H = Intersection of center lines to face of fitting; 90° elbows, tees, crosses; ± 1/4 inch.; wyes ± 1/2 inch; 14" & larger inch.

J = Intersection of center lines to bottom of socket/thread; 45° elbows; ± 1/4 inch; 14" & larger ± 1/2 inch.

L = Overall length of fittings; ± 1/2 inch; wyes ± 1 inch; 14" & larger ± 1 inch.

M = Outside diameter of socket/thread hub; ± 1/4 inch.

N = Socket bottom to socket bottom; couplings; ± 1/2 inch.

W = Height of cap; ± 1/4 inch.

Typical Fabricated Dimension References

