

Part No: 280-103347

Fabricated Low Head PIP

Crosses

Desc: 20X8 PVC RED CROSS SOC LOW HEAD PIP

MSRP: 790.87

Part Code: 300

Weight(lbs): 26.231

Weight(kg): 11.898

Weight(gm): 11898

Size: 20 X 8

Color: WHITE

Material: PVC

Type Cross- Reduction

Connection Socket x Socket x Socket x Socket

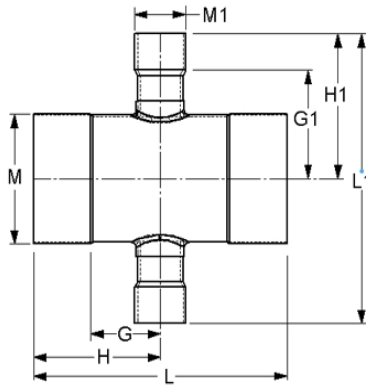

H = 15-1/2

H1 = 16-7/8

L = 31

L1 = 33-3/4

M = 20-13/16

M1 = 8-5/16

G = 9

G1 = 12-7/8

Fabricated Dimension References:

G = (LAYING LENGTH) intersection of center lines to bottom of socket/thread; 90° elbows, tees, crosses; $\pm 1/4$ & larger $\pm 1/2$ inch.

H = Intersection of center lines to face of fitting; 90° elbows, tees, crosses; $\pm 1/4$ inch.; wyes $\pm 1/2$ inch; 14" & larger inch.

J = Intersection of center lines to bottom of socket/thread; 45° elbows; $\pm 1/4$ inch; 14" & larger $\pm 1/2$ inch.

L = Overall length of fittings; $\pm 1/2$ inch; wyes ± 1 inch; 14" & larger ± 1 inch.

M = Outside diameter of socket/thread hub; $\pm 1/4$ inch.

N = Socket bottom to socket bottom; couplings; $\pm 1/2$ inch.

W = Height of cap; $\pm 1/4$ inch.

Typical Fabricated Dimension References

