

**Part No:** 854-060CL300

**Flanges & Cut-In Kit**

**Molded**

**Desc:** 6 PVC VAN STONE FLANGE SOC 150PSI CL300

**MSRP:** 1982.19

**Part Code:** 083

**Weight(lbs):** 7.705

**Weight(kg):** 3.495

**Weight(gm):** 3495

**Size:** 6"

**Color:** GRAY

**Material:** PVC

**Connection** Socket CL 300 (Van Stone 2 Piece)

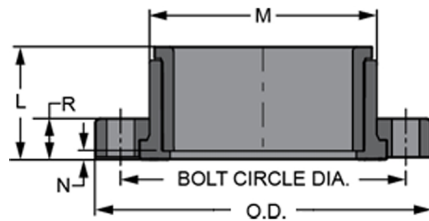

**L** = 3- 7/16

**M** = 7- 9/16

**N** = 3/8

**O.D.** = 12- 1/2

**R** = 1- 1/2

**No of Bolts** = 12

**Bolt Circle Dia.** = 10- 5/8

**Bolt Size** = 3/4

## Injection Molded Dimension References:

**G** = (LAYING LENGTH) intersection of center lines to bottom of socket/thread; 90° elbows, tees, crosses; ± 1/32 inch.

**H** = Intersection of center lines to face of fitting; 90° elbows tees, crosses; ± 1/32 inch.

**J** = Intersection of center lines to bottom of socket/thread; 45° elbows; ± 1/32 inch

**L** = Overall length of fittings; ± 1/16 inch.

**M** = Outside diameter of socket/thread hub; ± 1/16 inch.

**N** = Socket bottom to socket bottom; couplings; ± 1/16 inch.

**W** = Height of cap; ± 1/16 inch

## Typical Molded Dimension References

