

**Part No:** 869SV-333SR

**Schedule 80 PVC & CPVC**

**Clamp-On Saddle**

**Desc:** 3X1/2 PVC CLAMP SADDLE D/O SRFPT FKM

**MSRP:** 167.92

**Part Code:** 086

**Weight(lbs):** 0.981

**Weight(kg):** 0.445

**Weight(gm):** 445

**Size:** 3"X1/2"

**Color:** GRAY

**Material:** PVC

**Connection** Double SR Fipt

**Type** Clamp Saddle

**Hardware** SS

**O-Ring** FKM

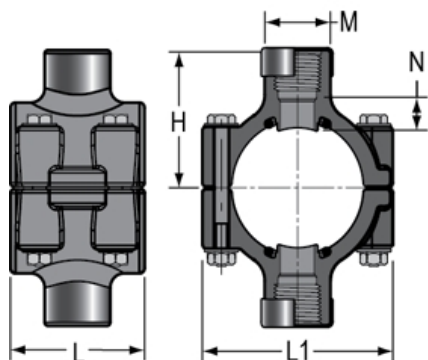

**H** = 3- 5/16

**L** = 3

**L1** = 4-3/4

**M** = 1- 3/8

**N** = 13/16

**No of Bolts** = 4

**Bolt** = 8  
**Torque**  
**FT./LBS.**

**Hole Size** = 7/8

## Injection Molded Dimension References:

**G** = (LAYING LENGTH) intersection of center lines to bottom of socket/thread; 90° elbows, tees, crosses;  $\pm 1/32$  inch.

**H** = Intersection of center lines to face of fitting; 90° elbows tees, crosses;  $\pm 1/32$  inch.

**J** = Intersection of center lines to bottom of socket/thread; 45° elbows;  $\pm 1/32$  inch

**L** = Overall length of fittings;  $\pm 1/16$  inch.

**M** = Outside diameter of socket/thread hub;  $\pm 1/16$  inch.

**N** = Socket bottom to socket bottom; couplings;  $\pm 1/16$  inch.

**W** = Height of cap;  $\pm 1/16$  inch

## Typical Bushing Dimension References

