

Tankless Water Heater Accessories

Specification Sheet

Pipe Cover

- Made of durable powder coated steel (or stainless steel for select models)
- Conceals the piping underneath the water heater to provide a cleaner installation
- Compatible with all water heater models and requires light assembly



Dimensions

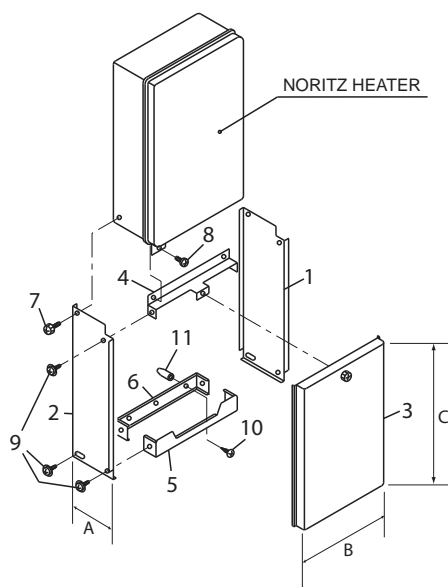

Pipe Cover

- ☐ NR50, NR66 and NR71 Series (#PC-1S)
- ☐ NR83-DVC, NR98-SV/-OD, NC199-OD (#PC-2S)
- ☐ NRC98, NCC199, NRC111, NR111 Series (#PC-3S)
- ☐ Stainless Steel Version (#PC-3S-SUS)
- ☐ Pipe Cover for NC380/1321 Series (#PC-4S)
- ☐ Stainless Steel Version (#PC-4S-SUS)
- ☐ N-0751M-DVC, NR98-DVC, NC199-DVC (#PC-5S)

Compatible with All Models

NR50 Series	NC199 Series
NR66 Series	NCC199 Series
NR71 Series	NRC111 Series
NR83 Series	NR111 Series
NR98 Series	NC250 Series
NRC98 Series	NC380 Series

Pipe Cover			PC-1S		PC-2S		PC-3S(-SUS)*		PC-4S(-SUS)*		PC-5S	
Model Compatibility			NR50, 531 Series, NR66 Series, 631 Series, NR71 Series		N-0751M, NR83-DVC, NR98-SV, N-0751M-OD, NR98-OD, NC199-OD		N-0751M-DV, NRC98 Series, NCC199 Series, 841 & 842 Series, NRC111 Series, 931 Series, NR111 Series, NC250 Series		N-1321M-ASME, NC380-SV-ASME		N-0751M-DVC, NR98-DVC, NC199-DVC	
Part #	Part Name	QTY		QTY		QTY		QTY		QTY		QTY
1	Left Side	1		1		1		1		1		1
2	Right Side	1	A: 6.0"	1	A: 8.7"	1	A: 8.7"	1	A: 11.8"	1	A: 9.6"	
3	Front	1	B: 13.3" C: 17.5"	1	B: 13.3" C: 17.5"	1	B: 17.8" C: 17.5"	1	B: 18.3" C: 17.5"	1	B: 13.3" C: 17.5"	
4	Top Bracket	1		1		1		1		1		
5	Bottom Front Bracket	1		1		1		1		1		
6	Bottom Back Bracket	1		1		1		1		1		
7	Cosmetic Screw	2		2		2		2		2		
8	Truss Screw Small	2		2		2		2		2		
9	Tapping Screw	6		6		6		8		6		
10	Wood Screw	2		2		2		0		2		
11	Wall Anchor	2		2		2		0		2		

*-SUS denotes Stainless Steel version of the Pipe Cover