

Central Brass

C O M P A N Y

Brecksville, Ohio 44141

Phone: (216) 883-0220 Fax: (440) 526-5745

www.CentralBrass.com

MODEL NO. **0127-A**
KITCHEN TOPMOUNT

The 6-inch center topmounted kitchen faucet has a cast brass body that is copper, nickel and chrome plated. The compression stems are all brass with a double O-Ring seal and rubber seat washer. The canopy handles are zinc die cast with a chrome plated finish. The 8-inch swivel "D" spout is brass with a chrome plated finish and is fitted with a water saving aerator that limits the flow rate. The O-Rings and seals are rubber.

Flow Rate: 2.0 GPM @ 60 psi

ADA Compliant and Meets ASME A112.18.1M

ANSI/NSF 61/Section 9 Certified



Certified to
ANSI/NSF 61 Section 9

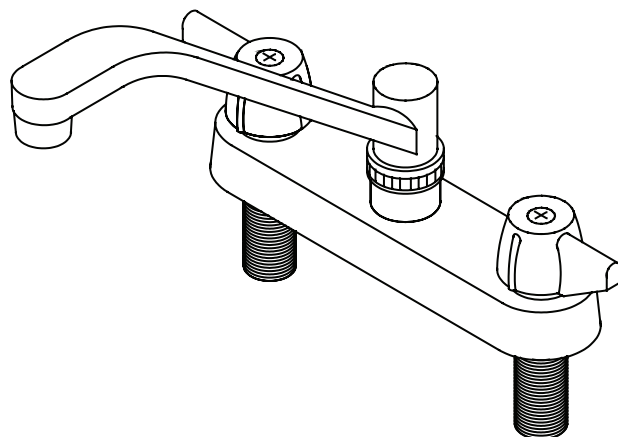

Installation Drawing

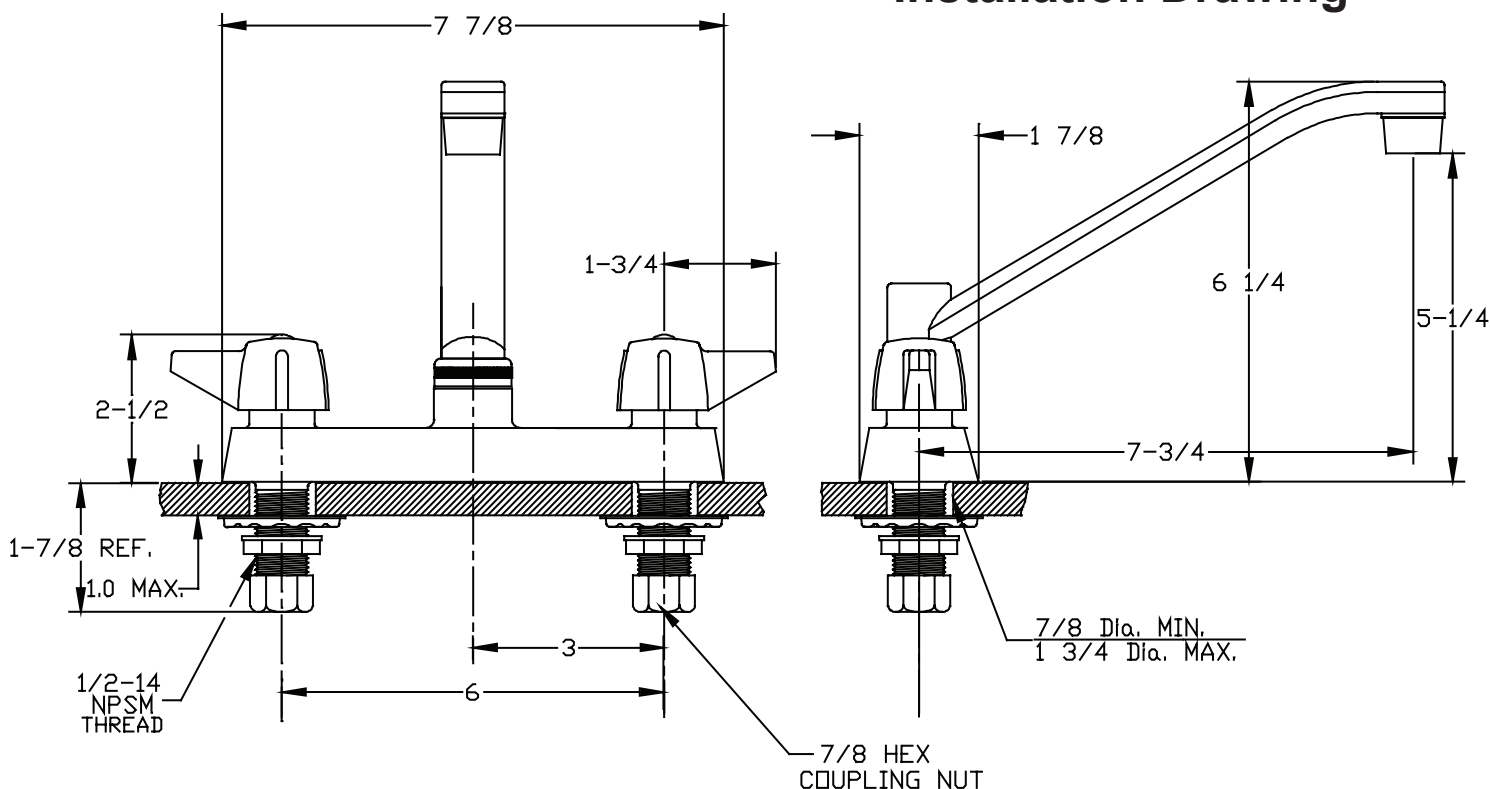

Central Brass

C O M P A N Y

Brecksville, Ohio 44141

Phone: (216) 883-0220 Fax: (440) 526-5745

www.CentralBrass.com

MODEL NO. 0127-A
KITCHEN TOPMOUNT

Suffix Options
& Accessories

Handle variations available

Wrist 4-inch

Elbow 6-inch

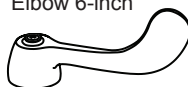

G-4147 (4-inch)

G-4149 (6-inch)



Faucets with lever, wrist or elbow handles with compression or ceramic stem cartridges are ADA compliant.

Spout variations available

A8 - Suffix
7 1/4-inch High-Rise Swivel Spout

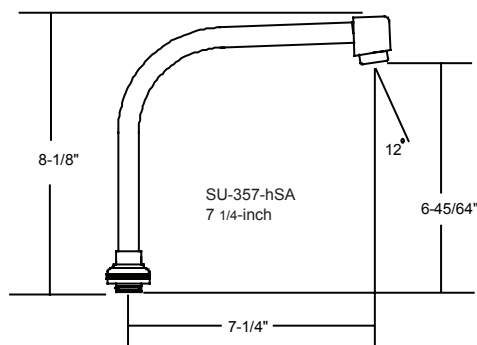

Wall Mount
Spout Adaptor
Accessory

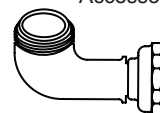

G-1748-88W

Cast Brass Spout
Extension
Accessory

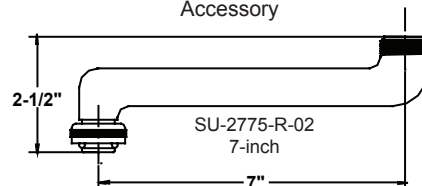

Drinking water products tested and certified by NSF International to ANSI/NSF Standard 61, Section 9. Each product required to meet the standard proudly exhibits the NSF logo.