

## 22L23-W



### Brand Features

The 22 Series Cam-Type positive latching connectors and receptacles are the standard used by Navy bases and shipyards in supplying 3-phase power to ships at dockside. Our latching connector series has been tested to meet Navy specs, including intermateability with competition. They provide heavy duty, completely insulated connectors that are vibration resistant. These connectors will not vibrate or loosen, ensuring high conductivity and maximum efficiency. Contacts can be retrofitted to existing locations and power distribution systems. Male contacts provide 40% more surface contact with the female vs. competitive products, ensuring greater conductivity while preventing burnout.

### Item Description

Ball Nose In-Line Latching Male Connector, 22 Series Single Pole Cam-Type Contact & Insulator, Crimped, 500-750MCM, 690 Amp Max - WHITE

**Color:** White

**UPC Code:** 07847799776

### Technical Information

#### Electrical Specifications

**Max. Amperage:** 690 Amp

**Max. Voltage:** 600 Volt

#### Material Specifications

**Sleeve Material:** Santroprene TPV

**Contact Material:** Brass

**Strain Relief:** Copper Wire

#### Mechanical Specifications

**Gender:** Male

**Connection Type:** Crimped

**Cable Range:** 500-750MCM

#### Product Features

**Color:** White

**Insulator Cat. No.:** 22SVM-W

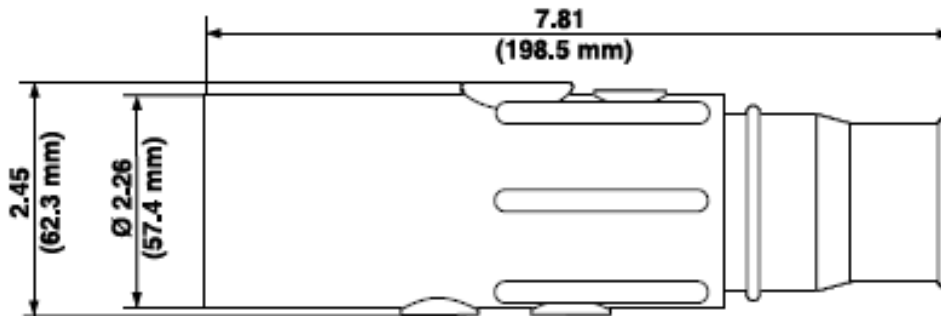

## Ball Nose In-line Latching Male Connectors – Crimped

### SPECIFICATION SUBMITTAL

JOB NAME: <input type="text"/> JOB NUMBER: <input type="text"/>	CATALOG NUMBERS: <input type="text"/> <input type="text"/> <input type="text"/> <input type="text"/>
--	---

**Leviton Manufacturing Co., Inc.**

201 North Service Road, Melville, NY 11747

Téléfono: +1-800-323-8920 · FAX: +1-800-832-9538 · Tech Line (8:30AM-7:30PM E.S.T. Monday-Friday): +1-800-824-3005

**Leviton Manufacturing of Canada, Ltd.**

165 Hymus Boulevard, Pointe Claire, Quebec H9R 1E9 · Telephone: +1-800-469-7890 ·

FAX: +1-800-824-3005 · [www.leviton.com/canada](http://www.leviton.com/canada)

**Leviton S. de R.L. de C.V.**

Lago Tana 43, Mexico DF, Mexico CP 11290 · Tel.: (+52)55-5082-1040 · FAX: (+52)5386-

1797 · [www.leviton.com.mx](http://www.leviton.com.mx)

**Visit our Website at: [www.leviton.com](http://www.leviton.com)**

© 2018 Leviton Manufacturing Co., Inc. Todos los derechos reservados. Subject to change without notice.

**Leviton has a global presence.**

If you would like to know where your local Leviton office is located please go to:

[www.leviton.com/international/contacts/](http://www.leviton.com/international/contacts/)

