

SYLVANIA LEDVANCE

Luminaires Installation Guide

FLANGE KIT

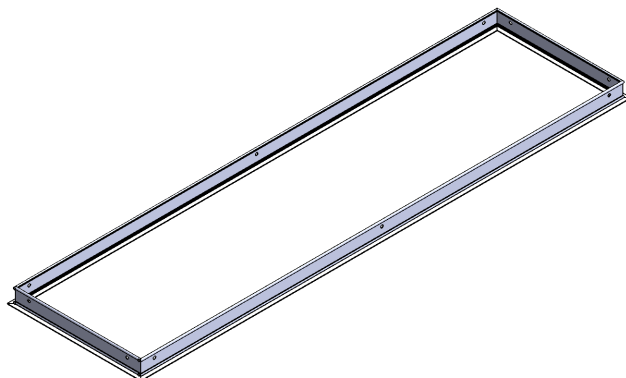

For warranty coverage, please register at www.sylvania.com/warrantyregistration.

⚠ WARNING

- TO PREVENT PERSONAL INJURY OR PRODUCT DAMAGE ONLY LICENSED ELECTRICIANS SHOULD PROVIDE ALL INSTALLATION SERVICES.
- TO AVOID ELECTRIC SHOCK OR COMPONENT DAMAGE DISCONNECT POWER BEFORE ATTEMPTING INSTALLATION OR SERVICING.
- INSTALL FLANGE KIT PER LOCAL CODES. SUITABLE FOR INSTALLATION IN SHEET ROCK/ PLASTERBOARD IN BOTH INSULATED CEILINGS AND NON-INSULATED CEILINGS.
- DO NOT HANDLE ENERGIZED FIXTURE WHEN HANDS ARE WET, WHEN STANDING ON WET OR DAMP SURFACES, OR IN WATER.
- RISK OF FIRE OR ELECTRIC SHOCK. SUITABLE FOR DAMP LOCATIONS.
- THIS PRODUCT MUST BE INSTALLED IN ACCORDANCE WITH THE NATIONAL ELECTRIC CODE (NEC) AND ALL APPLICABLE FEDERAL, STATE AND LOCAL ELECTRIC CODES AND SAFETY STANDARDS.
- USE CAUTION WHEN HANDLING THIS PRODUCT DURING OR AFTER OPERATION AS IT MAY BECOME HOT AND CAUSE BURNS. DISCONNECT PRODUCT AND ALLOW COOLING PRIOR TO SERVICING.
- ANY ALTERATION OR MODIFICATION OF THIS PRODUCT IS EXPRESSLY FORBIDDEN AS IT MAY CAUSE SERIOUS PERSONAL INJURY, DEATH, PROPERTY DAMAGE AND/OR PRODUCT MALFUNCTION.
- TO PREVENT PRODUCT MALFUNCTION AND / OR ELECTRICAL SHOCK THIS PRODUCT MUST BE PROPERLY GROUNDED.

SAFETY PRECAUTIONS:

IMPORTANT: READ CAREFULLY BEFORE INSTALLING THE FIXTURE. RETAIN FOR FUTURE REFERENCE.

GENERAL: Upon receipt of the kit, thoroughly inspect for any freight damage which should be brought to the attention of the delivery carrier.

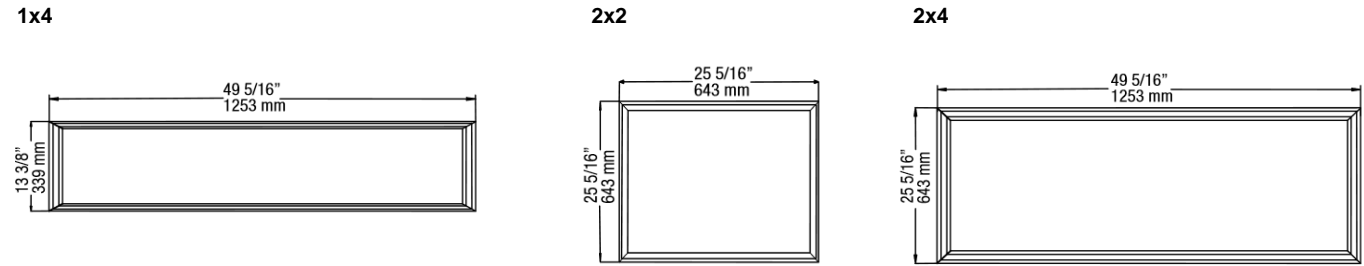

INSTALLATION:

- 1. Assemble the four pieces of the Flange Kit with the screws provided (fig. 1).
- 2. Cut out an opening according to the dimension table (fig. 4).
- 3. Support the Flange Kit to the building structure by Hanger Wires (provided by others) (fig 2.), alternatively screw to Wood Blocking (provided by others) (fig. 3) or black iron (provided by others).
- 4. Follow wiring directions on luminaire installation instruction sheet.
- 5. Rotate and slide the luminaire as required to fit through the drywall opening and place it on the Flange Kit (fig. 5).

Figure 1

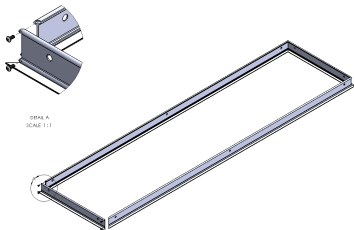

Figure 2

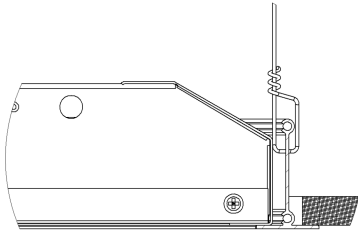
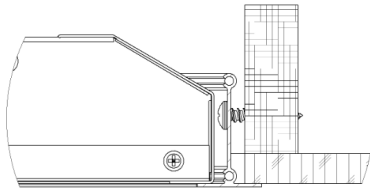

Figure 3



Dimensions Table
(Figure 4)

Rough Cut Dimensions			
NAED	Dimensions	Length	Width
60457	1 x 4	12-5/8"	48-5/8"
60458	2 x 2	24-5/8"	24-5/8"
60459	2 x 4	24-5/8"	48-5/8"

Figure 5

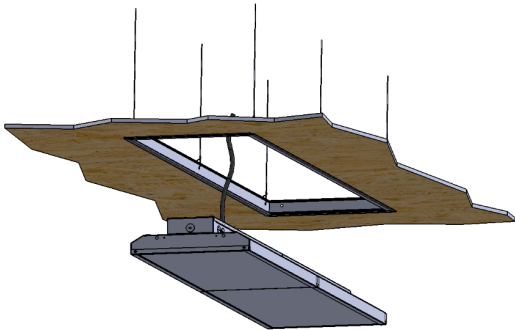

WARNING
Risk of electric shock
Disconnect power before servicing

TROUBLE SHOOTING CHECKLIST: If luminaire does not work

- Check your power source.
- Check electrical connections.