

Leviton Load Center Hydraulic Magnetic Branch Circuit Breakers



APPLICATION

Ideal for harsh climates, Hydraulic Magnetic circuit breakers offer more precise trips based on current, even in extreme temperatures: from -40°C to 85°C, without re-rating.

The most advanced circuit breakers on the market are now the fastest to install. Only Leviton circuit breakers feature an all plug on design, so you can wire the entire panel at rough-in, without a single circuit breaker present.

Intuitive diagnostics such as LEDs on electronic circuit breakers indicate fault type and color indicators in each rocker handle display operational status at-a-glance.

FEATURES AND BENEFITS

- **Precision:** Offers more precise trips based on current, even in extreme temperatures: -40°C to 85°C, without re-rating
- **Simple:** Features an all plug-on installation - no wiring to circuit breakers less than 70A
- **Intuitive:** Line-side powered LEDs stay lit, even after a circuit breaker has tripped, and identify cause of trip. Color indicators in each rocker handle designate operational status at-a-glance (ON/OFF/Tripped)

PRODUCT SPECIFICATIONS

PRODUCT FEATURES

Dimensions:
Single Pole 3.9" H x 1.0" W x 3.1" D
Double Pole 3.9" H x 2.0" W x 3.1" D
Operating Temperature: -40°C to 85°C (-40°F to 185°F)
Warranty: 10-Year Limited, 2-Years for electronic components
Weight: Single Pole 0.42 lbs.
Double Pole 0.85 lbs.
Wiring: All Plug-on up to 60A

Electrical Specifications

Amperage: Refer to catalog number tables
Breaker Technology: Hydraulic Magnetic
Short Circuit Current Rating: 10 KA, Series Rated 22KA with Leviton
Main Breaker; see Series Ratings Tables for additional Ratings
Type: Available in Standard, AFCI, GFCI, AFCI/GFCI, GFPE

Standards & Certifications

CSA-C22.2 No. 5-02
EMC Compatible
FCC
RoHS
UL 489, HACR rated
UL 943 (GFCI), where applicable
UL 1699 (AFCI), where applicable

ORDERING INFORMATION

Standard

	Amp Rating	1-Pole	2-Pole
	15	LB115	LB215
	20	LB120	LB220
	25	LB125	LB225
	30	LB130	LB230
	35	-	LB235
	40	-	LB240
	45	-	LB245
	50	-	LB250
	60	-	LB260
	70	-	LB270
	80	-	LB280
	90	-	LB290
	100	-	LB200
	110	-	LB211
	125	-	LB212

GFCI - 5 mA Ground-Fault
Protection of Personnel

	Amp Rating	1-Pole	2-Pole
	15	LB115-GF	LB215-GF
	20	LB120-GF	LB220-GF
	25	LB125-GF	LB225-GF
	30	LB130-GF	LB230-GF
	40	-	LB240-GF
	50	-	LB250-GF
	60	-	LB260-GF

GFPE - 30 mA Ground-Fault
Protection of Equipment

	Amp Rating	1-Pole	2-Pole
	15	LB115-EP	LB215-EP
	20	LB120-EP	LB220-EP
	25	LB125-EP	LB225-EP
	30	LB130-EP	LB230-EP
	40	-	LB240-EP
	50	-	LB250-EP
	60	-	LB260-EP

AFCI

	Amp Rating	1-Pole	2-Pole
	15	LB115-AF	LB215-AF
	20	LB120-AF	LB220-AF

AFCI/GFCI - Dual Function

	Amp Rating	1-Pole
	15	LB115-DF
	20	LB120-DF

DIMENSIONAL DRAWINGS

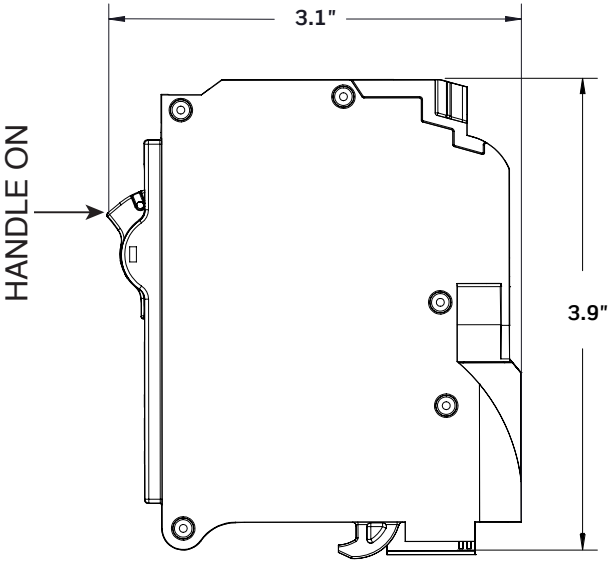
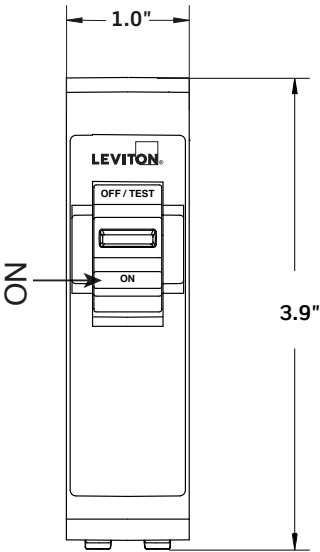

Single Pole

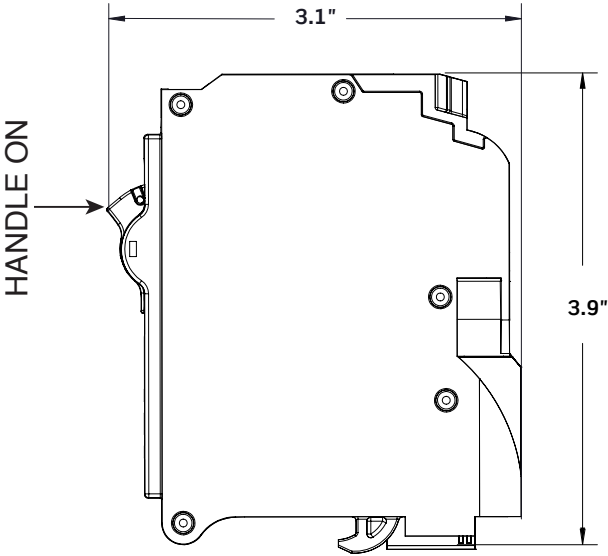
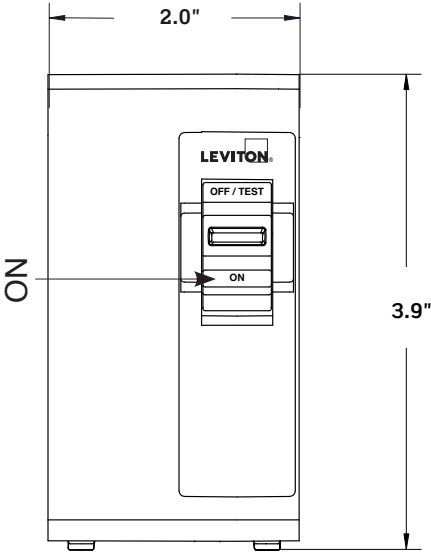

Double Pole

HANDLE OPERATION AND LED DIAGNOSTICS

Handle Window	"AF" LED	"GF" LED	Device Status
GREEN	OFF	OFF	ON
RED	OFF	OFF	Overload or short-circuit trip
RED	ON (solid)	OFF	Series arc-fault trip
RED	OFF	ON (solid)	Ground-fault trip or Parallel arc-fault to Ground
RED	ON (blinking)	OFF	0.5 sec. delay -Parallel arc-fault trip
RED	OFF	ON (blinking)	3 sec. delay - Neutral Miswired
RED	ON (blinking)	ON (blinking)	0.1 sec. delay -Electronics self-test failure (breaker will be locked out and must be replaced)
WHITE	OFF	OFF	Manual OFF



Leviton Manufacturing Co., Inc.

201 North Service Road, Melville, NY 11747-3138
Telephone: 1-800-323-8920 • FAX: 1-800-832-9538
Tech Line: 1-800-824-3005
Mon-Fri 8am-10pm EST, Saturday 9am-7pm EST

Visit our Website at: www.leviton.com

© 2020 Leviton Manufacturing Co., Inc. All rights reserved.

TS-032020C-tp