

**WATER-TITE**  
IPS CORPORATION

## Utility Kitchen Box with Four Qtr-turn Valves

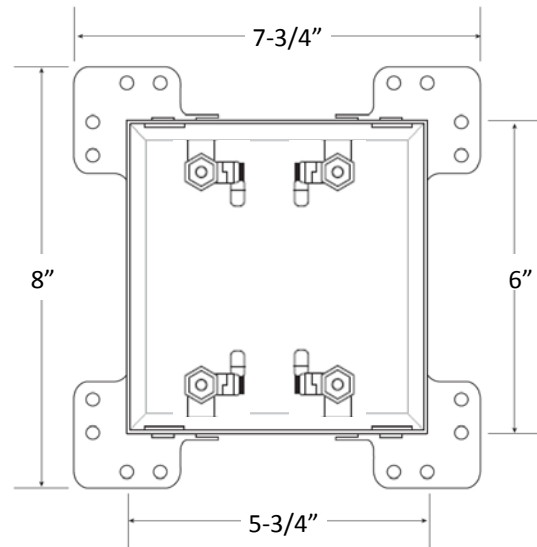

Side View

Top View

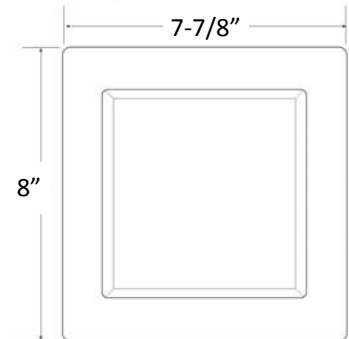
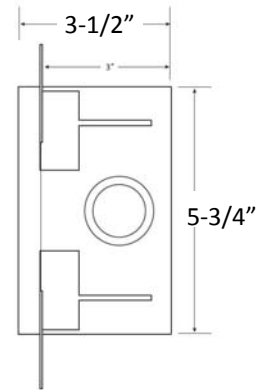
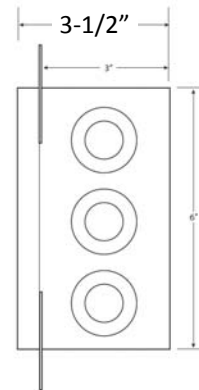

### Specification:

Furnish and install Water-Tite Utility Kitchen Outlet Box with four qtr-urn valves. Unit shall be Water-Tite product code checked below, as manufactured by IPS Corporation.

### Box/Frame Material:

High-impact Polystyrene

### Valves:

Lead free Qtr. Turn Valves with 3/8" Compression Outlet available for Sweat, CPVC, PEX or Wirsbo connection as checked below. Valves comply with ASME A112.18.1/CSA B125.1-05, NSF61-NSF/ANSI 372, and meets No Lead Plumbing Law.

### Certifications:

Box   
Valves 

✓	Product Code #	Model #	Product Description	Units/Case
	82766	15004	Utility Box w/4 valves, Sweat	10
	82767	15014	Utility Box w/4 valves, CPVC	10
	82768	15024	Utility Box w/4 valves, F1807	10
	82769	15114	Utility Box w/4 valves, F1960	10

**IPS**  
CORPORATION