

STAINLESS STEEL
HINGE PIN

(2) EACH #10-32 BRASS INSERTS
AND STAINLESS STEEL
CAPTIVE COVER SCREWS

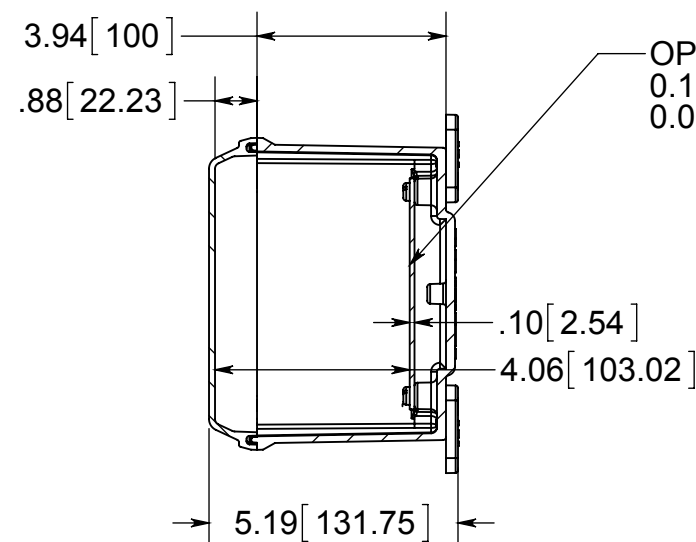

(4) EACH #10-32 BRASS
INSERTS, AND STAINLESS
STEEL FLANGE AND
FEET SCREWS

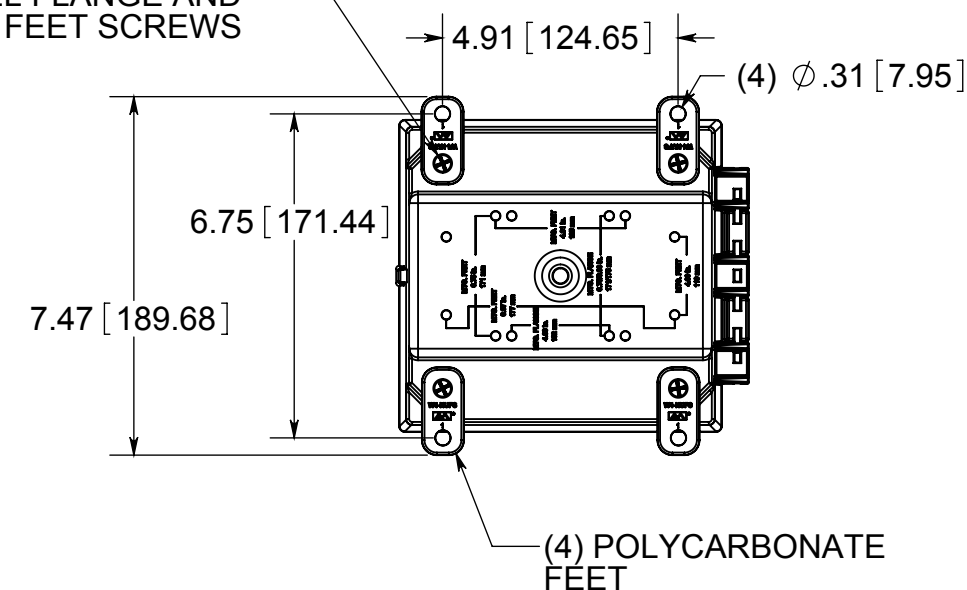

FRONT VIEW
WITH COVER REMOVED
AND BACK PANEL DISPLAYED

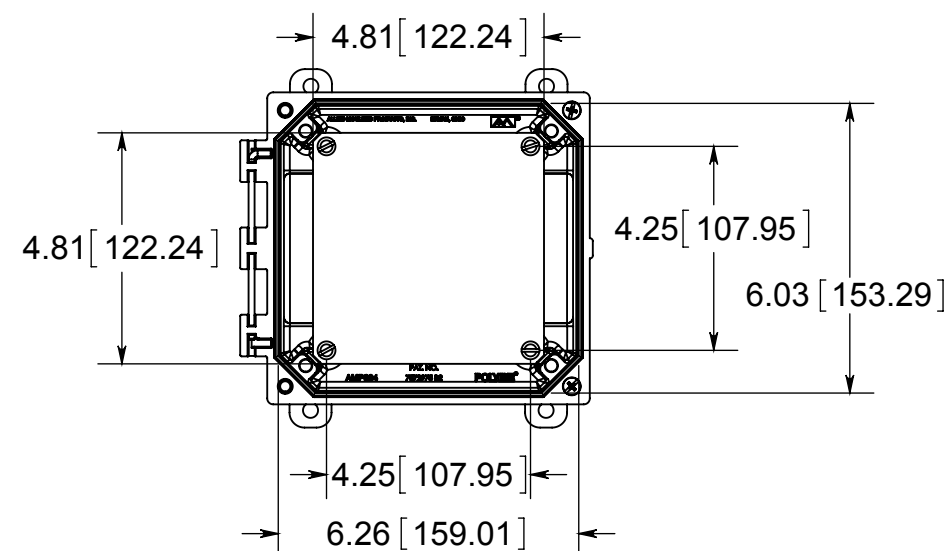

CLOSED CELL
NEOPRENE
GASKET

(4) EACH #10-32 BRASS
INSERTS AND PLATED
CARBON STEEL TRUSS SCREW

MATERIAL:
BOX- INJECTED POLYCARBONATE
STANDARD COVER- INJECTED POLYCARBONATE
CLEAR COVER- INJECTED POLYCARBONATE



PART No. PCJ664H

for more information visit
www.hammfg.com
Data subject to change without notice
Drawing Not to Scale