

1485 / 1487 - SERIES

BUL10148

REV. B

ASSEMBLY INSTRUCTIONS FOR A BOX CONNECTOR OF A WIREWAY

ASSEMBLY INSTRUCTIONS

- A) USE CONNECTOR PLATE (PART 1) AS A TEMPLATE. MARK, CUT CUTOUT HOLE AND DRILL .281" (7.1mm) DIA. HOLES. DO THIS AT THE DESIRED LOCATION IN THE ENCLOSURE.
- B) FASTEN THE CONNECTOR PLATE (PART 2) TO THE INSIDE OF THE ENCLOSURE WITH THE GASKET ON THE MATING WIREWAY CONNECTING EXTERNALLY TO THE ENCLOSURE USING 1/4 - 20 X 1 HEX HD. SCREWS WITH 1/4 STAR WASHERS AND 1/4 - 20 KEP NUTS (PARTS 6, 5 & 1). ENSURE THAT THE GASKET (PART 3) IS IN BETWEEN THE WIREWAY FLANGE AND CONTROL BOX.
- C) FOR ONLY 1485 SERIES, SLIP THE ANGLE SEALING BRACKET (PART 4) INTO MATING WIREWAY AND FASTEN TO THE FLANGE ON 1/4 - 20 HARDWARE.

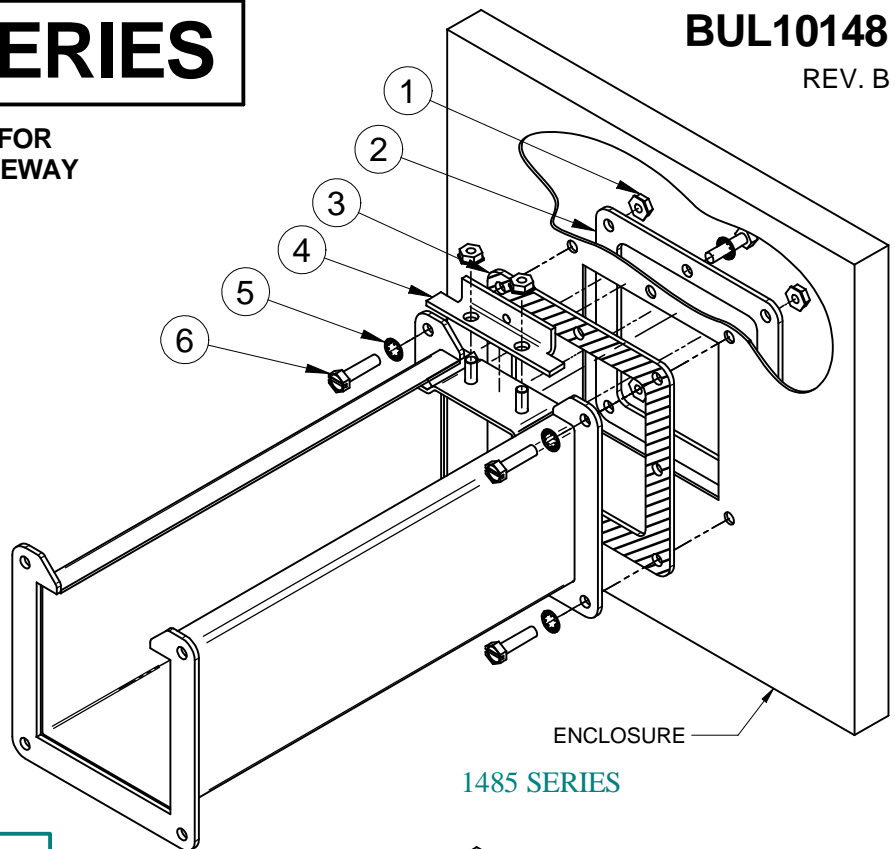

1485 SERIES

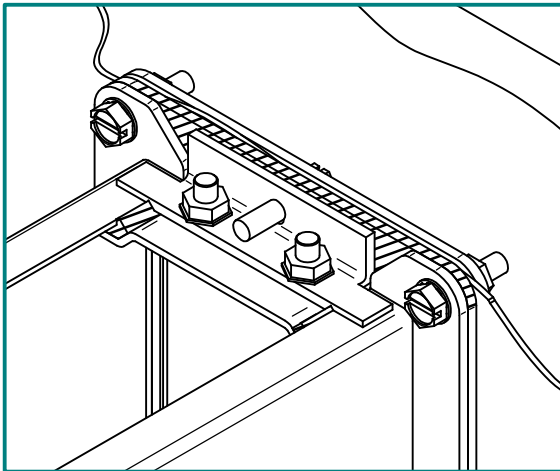

ASSEMBLED VIEW OF 1485

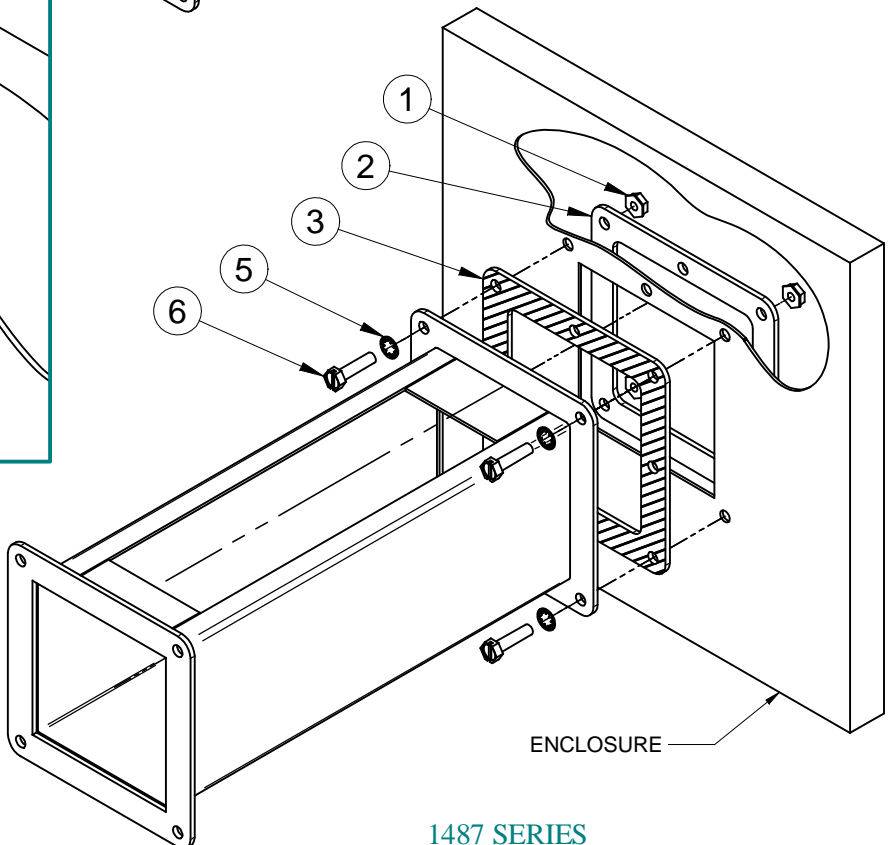

1487 SERIES

PART #	QTY.	DESCRIPTION
1	4 OR 7	1/4 - 20 KEP NUT W/ WASHER
2	1	BOX CONNECTOR PLATE
3	1	SOLID FLANGE GASKET
4	1	ANGLE SEALING PLATE
5	4 OR 8	1/4 STAR WASHER
6	5 OR 8	1/4 - 20 X 1 HEX CAP SCREW

TOOL BOX	3/8, 7/16" Socket Wrench	3/8 or 7/16 Open Wrench	Centre Punch	Drill, use .281(7.1mm) BIT	Hammer	Cutting Tool

**HAMMOND
MANUFACTURING™
ENCLOSURES**