

OWL2-20/20W/8XX-U-S18-W  
OWL2-20/20W/8XX-U-S18-BZ

## INSTALLATION INSTRUCTIONS LED Sensor Light

### SAFETY PRECAUTIONS:

- PLEASE READ ALL WARNINGS AND INSTRUCTIONS INCLUDED IN THE BOX AND ON FIXTURE TO AVOID PERSONAL INJURY, PROPERTY DAMAGE CAUSED BY FIRE, ELECTRIC SHOCK, FALLING COMPONENTS, CUTS, BRUISES, OR DEATH BEFORE INSTALLING, MAINTAINING, OR FIXING.
- WARNING: RISK OF ELECTRICAL SHOCK
- WARNING: RISK OF PRODUCT DAMAGE
- WARNING: RISK OF INJURY
- WARNING: RISK OF BURN
- COMMERCIAL INSTALLATION, SERVICE, AND MAINTENANCE OF LUMINAIRES SHOULD BE PERFORMED BY A QUALIFIED LICENSED ELECTRICIAN.
- RESIDENTIAL INSTALLATION SHOULD CONSULT A QUALIFIED LICENSED ELECTRICIAN AND CHECK LOCAL ELECTRICAL CODE.
- DO NOT ALLOW THE LUMINAIRES TO CONTACT THE SURFACE OF COMBUSTIBLE MATERIALS.
- FIXTURE CANNOT BE USED WITH A DIMMER SWITCH, MOTION SENSORS OR OTHER ELECTRONIC SWITCHING DEVICES. THE FIXTURE MUST BE CONTROLLED BY ONE SWITCH.
- FIXTURE SHOULD NOT BE USED IN AREAS WITH LIMITED VENTILATION OR HIGH AMBIENT TEMPERATURE.
- TURN OFF ELECTRICAL POWER AT FUSE OR CIRCUIT BREAKER BOX BEFORE WIRING FIXTURE TO THE POWER SUPPLY
- ENSURE FIXTURE IS CONNECTED TO THE CORRECT VOLTAGE. CONNECT THE FIXTURE WITH 100-277V 50/60HZ POWER SUPPLY.
- ENSURE ALL ELECTRICAL AND GROUNDED CONNECTIONS ARE IN ACCORDANCE WITH THE NATIONAL ELECTRICAL CODE AND APPLICABLE LOCAL CODE REQUIREMENTS.
- ALL WIRING CONNECTIONS SHOULD BE COMPLIANT WITH UL STANDARD.
- NEVER CONNECT COMPONENTS WHILE UNDER LOAD.
- DO NOT HANG OR SUPPORT THESE FIXTURES IN A MANNER THAT WILL CUT THE OUTER JACKET OR DAMAGE WIRE INSULATION.
- AVOID INSTALLING THIS LED FIXTURE WHERE IT COULD BE COVERED BY INSULATION, FOAM, OR OTHER MATERIALS.
- DO NOT EXCEED FIXTURES MAXIMUM AMBIENT OPERATING TEMPERATURE UNLESS INDIVIDUAL PRODUCT SPECIFICATIONS DEEM OTHERWISE
- ELECTROSTATIC DISCHARGE CAN DAMAGE LED FIXTURES. PERSONAL GROUNDING EQUIPMENT MUST BE WORN DURING INSTALLATION OR MAINTENANCE.
- DO NOT TOUCH INDIVIDUAL ELECTRICAL COMPONENTS AS THIS CAN CAUSE ELECTROSTATIC DISCHARGE, SHORTEN LAMP LIFE, OR ALTER PERFORMANCE.
- WEAR GLOVES AND SAFETY GLASSES WHEN REMOVING THE LUMINAIRE FROM CARTON, INSTALLING, SERVICING OR PERFORMING MAINTENANCE.
- AVOID DIRECT EYE EXPOSURE TO THE LIGHT SOURCE WHILE IT IS ON AS THIS MAY CAUSE IRREPARABLE DAMAGE TO THE EYES.
- ACCOUNT FOR SMALL PARTS AND DESTROY PACKING MATERIAL, AS THESE MAY BE HAZARDOUS TO CHILDREN
- ALLOW FIXTURE TO COOL BEFORE TOUCHING.
- DO NOT EXCEED MAXIMUM WATTAGE MARKED ON LUMINAIRE LABEL.

## SENSOR LIGHT INSTALLATION:

### ALWAYS TURN OFF THE POWER SUPPLY FROM MAIN CIRCUIT BREAKER FIRST!

1. ATTACH SUPPLIED MOUNTING BRACKET TO JUNCTION BOX WITH PROVIDED SCREWS. NOTE: DO NOT POWER THE FIXTURE BEFORE INSTALLATION IS COMPLETE (SEE FIGURE 1).
2. PLACE GASKET BETWEEN THE FIXTURE AND JUNCTION BOX AND ATTACH USE PROVIDED WIRE NUTS TO MAKE THE FOLLOWING CONNECTIONS (SEE FIGURE 2):
  - A. CONNECT THE WHITE WIRE TO THE WHITE (NEUTRAL)
  - B. CONNECT THE BLACK WIRE TO THE BLACK (LINE)
  - C. CONNECT THE YELLOW AND GREEN WIRE TO THE GREEN (GROUND) NOTE: DO NOT CUT OR REMOVE ANY CONNECTORS ON THE WIRE TO MAKE SURE THE POSITIVE AND NEGATIVE CONNECTION IS CORRECT.
3. INSERT AND TIGHTEN THE MOUNTING BOLT ONTO THE MOUNTING BRACKET. NOTE: MAKE SURE ALL WIRES ARE IN THE JUNCTION BOX OR LAMP BODY BEFORE INSTALLING THE LIGHT ONTO THE JUNCTION BOX TO AVOID PINCHING WIRES (SEE FIGURE 3).
4. COVER THE BOLT HEAD WITH PROVIDED RUBBER PLUG. SEAL THE BASE OF THE FIXTURE, IF NEEDED, WITH SUITABLE SEALANT TO ENSURE A WATER TIGHT SEAL TO THE MOUNTING PLANE (SEE FIGURE 4).
5. ADJUST THE MOTION SENSOR. UP/DOWN MOVEMENT ANGLE: 0-90°, LEFT TO RIGHT MOVEMENT ANGLE: 0-120°

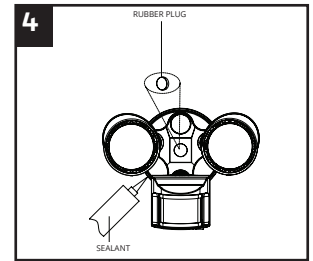
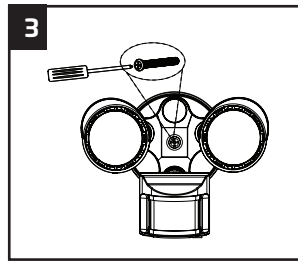
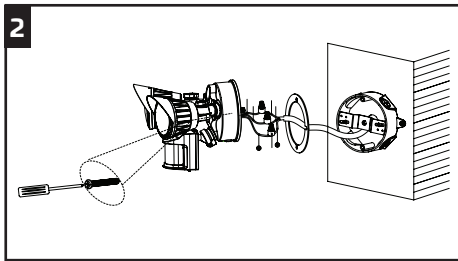
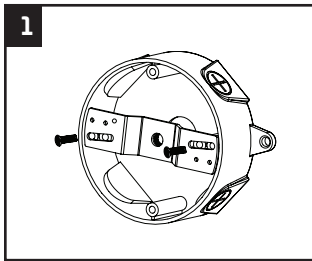

## FIXTURE OPERATION:

THE NITEOWL SENSOR LIGHT FEATURES THREE CUSTOMIZABLE OPERATING MODES: **ON-TIME/AUTO/DIM**

- **ON-TIME MODE:** DEFAULTS THE SENSOR LIGHT TO AN "ALWAYS ON" STATE SUITABLE FOR USE WITH A LIGHT SWITCH WHEN IT IS DESIRED THAT THE SENSOR LIGHT OPERATES AT 100% LIGHT OUTPUT FOR THE DURATION OF THE DUTY CYCLE.
- **AUTO MODE:** DEFAULTS THE SENSOR LIGHT TO "OFF" UNDER NORMAL OPERATION BASED ON OPERATING THRESHOLD SETTINGS. WHEN THE SENSOR DETECTS A BODY, THE SENSOR LIGHT WILL TURN ON TO 100% LIGHT OUTPUT FOR A PREDETERMINED TIME PERIOD AFTER WHICH IT WILL TURN OFF (IN AUTO MODE WHEN THE SENSOR DETECTS A BODY A RED INDICATOR WILL FLASH REGARDLESS OF OPERATING THRESHOLDS).
- **DIM MODE:** DEFAULTS THE SENSOR LIGHT TO 20% LIGHT OUTPUT UNDER NORMAL OPERATION BASED ON OPERATING THRESHOLD SETTINGS. WHEN THE SENSOR DETECTS A BODY, THE SENSOR LIGHT OUTPUT WILL INCREASE TO 100% LIGHT OUTPUT FOR A PREDETERMINED TIME PERIOD AFTER WHICH IT WILL RETURN TO 20% LIGHT OUTPUT (IN DIM MODE WHEN THE SENSOR DETECTS A BODY A RED INDICATOR WILL FLASH REGARDLESS OF OPERATING THRESHOLDS).

OPERATING THRESHOLDS CAN BE SET BY ADJUSTING THE FOLLOWING DIALS LOCATED ON THE SENSOR:

- **LUX:** SETS THE OPERATING THRESHOLD OF THE LIGHT ACTIVATION BASED ON AMBIENT LIGHTING CONDITIONS (NIGHT: 5 TO 50 LUX; DAY: 35 TO 400 LUX). SET TO "∞" THE LIGHT WILL ACTIVATE ANYTIME IT DETECTS MOTION DAY OR NIGHT.
- **TIME:** SETS THE LENGTH OF TIME THE SENSOR LIGHT OPERATES AT 100% LIGHT OUTPUT WHEN ACTIVATED. THE TIME DURATION CAN BE VARIED FROM 5 SECONDS UP TO 5 MINUTES (IN ON-TIME MODE THESE FEATURES ARE DEACTIVATED).
- **RANGE:** ADJUSTS THE DETECTION RANGE OF THE MOTION SENSOR FROM APPROXIMATELY 20 TO 70FT (6 TO 21M).

