

# Laboratory Remote Valves

## LRV-N1-A2E

### Concealed Valve - Right Hand for 45° Angle Panels

- Needle Valve
- Needle Valve Compression Cartridge
- Plastic Cross Handle
- Service: Oxygen\*
- Solid Brass Valve Construction
- Fully Assembled and Tested

\*NOTE: This fitting is not suitable for dispensing medical grade oxygen.

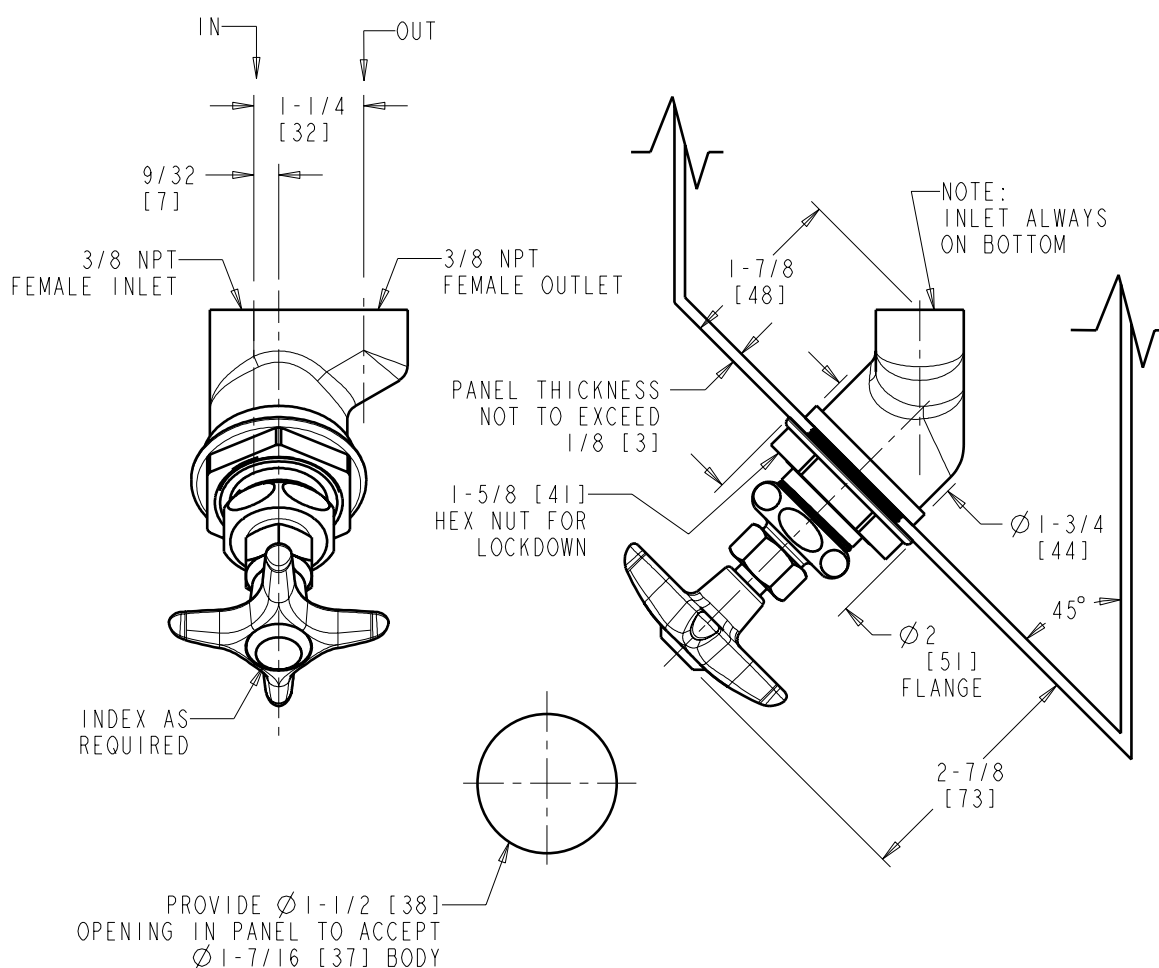

Note: All dimensions are in inches and [millimeters].

#### For Technical Assistance:

Phone: 800-TEC-TRUE (832-8783)

Email: [techsupport.us@chicagofaucets.com](mailto:techsupport.us@chicagofaucets.com)

The Chicago Faucet Company

2100 South Clearwater Drive

Des Plaines, IL 60018

Phone: 847/803-5000

Fax: 847/803-5454

Technical: 800/832-8783

[www.chicagofaucets.com](http://www.chicagofaucets.com)