

Laboratory Gas Fine Control Needle Valves

LGF3-A11B-60

Angle Pattern Valve

- Multi Turn Compression Cartridge
- Cartridge Features Stainless Steel Seat and Needle
- Metal Handle with Index Button
- Straight Serrated Nozzle
- Service: Vacuum
- Y Pattern Wall Flange
- Solid Brass Valve Construction
- Fully Assembled and Tested

Agency Certifications

ASME A112.18.1/CSA B125.1

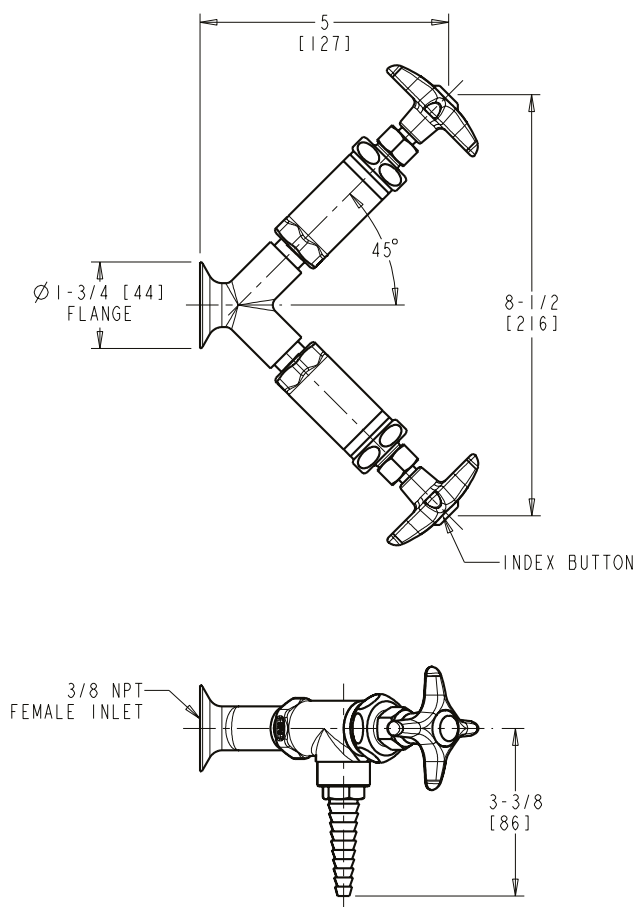

Note: All dimensions are in inches and [millimeters].

For Technical Assistance:

Phone: 800-TEC-TRUE (832-8783)

Email: techsupport.us@chicagofaucets.com

The Chicago Faucet Company
2100 South Clearwater Drive
Des Plaines, IL 60018
Phone: 847-803-5000
Fax: 847-803-5454
Technical: 800-832-8783
www.chicagofaucets.com