

ROUGHING IN DIMENSIONS MAY VARY AND ARE SUBJECT TO CHANGE. NO RESPONSIBILITY IS ASSUMED FOR USE OF SUPERCEDED OR VOIDED DATA.



2100 South Clearwater Drive
Des Plaines, IL 60018
Phone: 847-803-5000
Fax: 847-803-5454
www.chicagofaucets.com

ROUGH-IN

BY: SID

DATE: 06-15-12

CHK: *YMC*

REV:

FITTING NO.

DJ18E31JKCP

SUBMITTED MODEL NO.

FOR TECHNICAL ASSISTANCE
1-800-TEC-TRUE (1-800-832-8783)

SUBMITTED AS SHOWN

SUBMITTED AS NOTED

SEE ATTACHED FOR
SUBMITTED MODIFICATION

JOB NAME

ITEM NO.

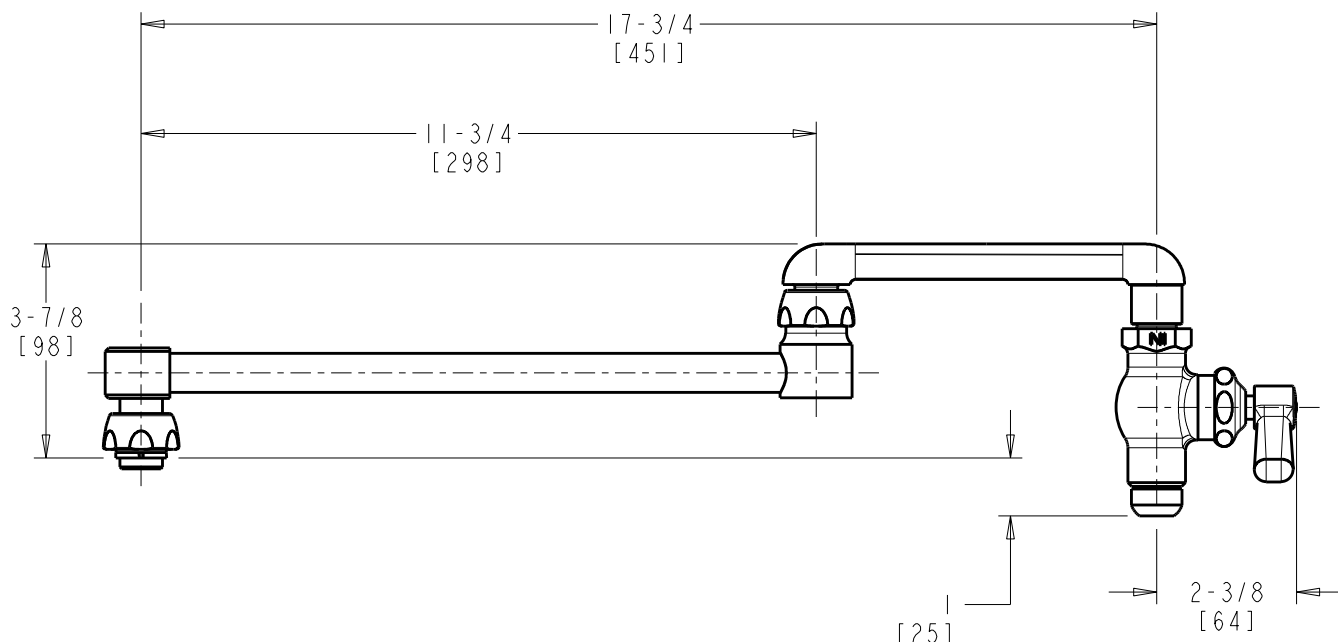

SIDR VIEW

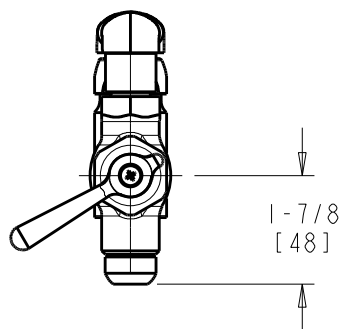

FRONT VIEW

DIMENSIONS ARE IN INCHES AND [MILLIMETERS].

TECHNICAL DATA

- 18" DOUBLE JOINTED SWING SPOUT
- E31 CONTROL VALVE WITH HEAT RESISTANT LEVER HANDLE, QUATURN OPERATING CARTRIDGE AND E1 QUIXTOP OUTLET
- FINISH: CHROME PLATE