

# SUBMITTAL DATA SHEET

## No-Lead Low Pressure Valves Y-Pattern Swing Check Valve - 72051S

SWT x SWT

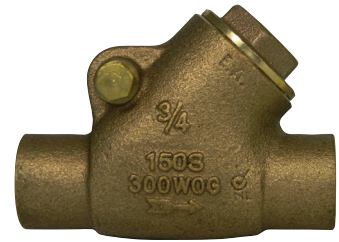

A.Y. McDonald Mfg. Co. No-Lead Low Pressure Valves are constructed from heavy duty no-lead bronze and are recommended for residential and commercial applications and positive shut-off with various inlet configurations.

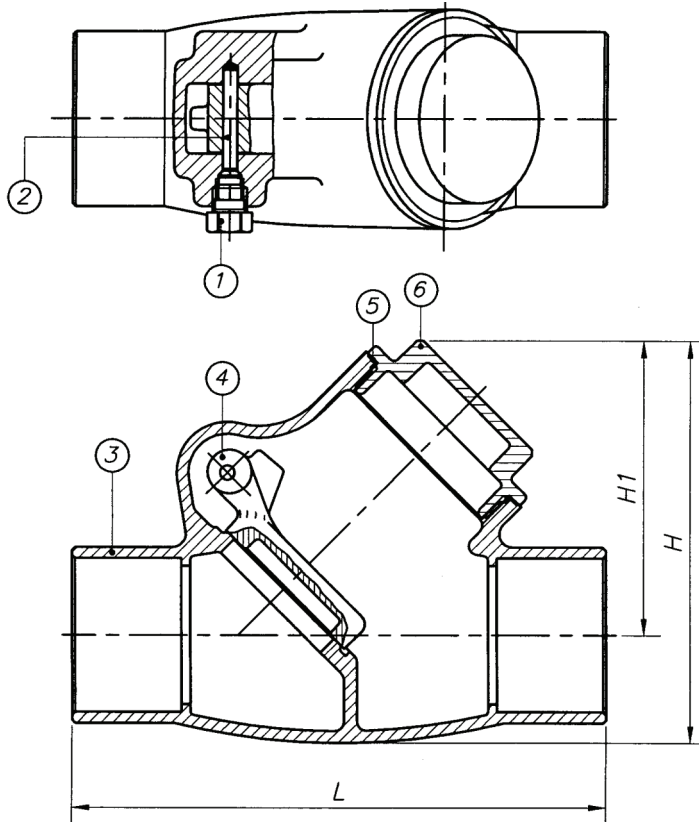

### Dimensions

Size	L	H	H1
1/2"	2.72	2.07	1.56
3/4"	3.37	2.17	1.94
1"	4.09	2.91	2.13
1 1/4"	4.76	3.60	2.63
1 1/2"	5.43	4.13	3.07
2"	6.66	5.06	3.75

### Materials

No.	Part	Material
1	Bolt	No-Lead Brass
2	Pin	No-Lead Brass
3	Body	No-Lead Brass
4	Disc	No-Lead Brass
5	Packing	Fiber "H"
6	Bonnet	No-Lead Brass

### SUBMITTAL INFORMATION

- Sizes: 1/2", 3/4", 1", 1 1/4", 1 1/2", 2"
- Temperature Rating 180°F
- Pressure Rating 300 WOG - Non Shock
- 150 PSI Steam Rating 320°F
- Threads conform to ANSI B1.20.1
- Solder ends conform to ANSI B16.18
- Directional
- Complies with NSF / ANSI 372-2010

**NO-LEAD:** The weighted average of the wetted surface of this no-lead product contacted by consumable water contains less than one quarter of one percent (0.25%) lead.



**A.Y. McDonald Mfg. Co.**  
P.O. Box 508  
Dubuque, IA 52004-0508

**Toll Free:** 1-800-292-2737  
**Fax:** 1-800-832-9296  
**Hours:** 7:00 a.m. - 5:00 p.m., CST

[sales@aymcdonald.com](mailto:sales@aymcdonald.com)  
[www.aymcdonald.com](http://www.aymcdonald.com)

A.Y. McDonald considers the information on this assembly drawing correct when published. Item and option availability, including specifications, are subject to change without notice.

**Submitted by:**