



# **"Apollo" Valves** manufactured in the USA **Hose Connection Backflow Preventer**

### **Applications**

Conbraco Model 38-304-02 and lead-free Model 38LF-304-02 hose connection backflow preventers are recommended for hose connection applications to protect the potable water system from contamination caused by back-siphonage or low-lead back pressure (no more than ten feet). These backflow preventers are not designed for continuous pressure. NOTE: These devices may discharge water to prevent backflow - DO NOT install where spillage may cause water damage.

Model	Approvals
38-304-02 & 38LF-304-02	  ASSE 1052    B64.2
38LF-304-02 ONLY	 NSF/ANSI 372

### **Maintenance**

Annual inspection is recommended to ensure water system safety and proper product function. See the repair instructions for proper disassembly.

### **Inspection and Repair Instructions**

#### Disassembly Procedure

1. \* If possible, remove device from the hose connection.
2. Place device in a vice with the inlet retainer up and free from the clamping force of the vice. NOTE: Use lead jaws or similar means to protect surfaces from clamp marks.
3. Remove the inlet seal, then the inlet retainer end using a 15mm hex wrench.
4. Noting the orientation of the inlet check assembly (see Fig.), remove and inspect for lodged debris or rubber degradation. Also inspect sealing area in the body for damage.
5. Now place in vice with outlet retainer up and free from the clamping force of the vice.
6. Remove the outlet end using an 11/16 hex wrench.
7. Noting the orientation of outlet check assembly (see Fig.), remove and inspect for lodged debris and rubber degradation. Remove outlet seal from the body and inspect for damage. Also, inspect sealing area in the body for damage.

\*If the set screw has been used, the valve may be serviced as connected - hold the inlet retainer with a pipe wrench and proceed with disassembly using another pipe wrench.

#### Assembly Procedure

Assembly is in the reverse order of disassembly being sure to orient check assemblies as shown (see Fig.).

### **Installation Instructions**

1. Always check local codes before installing this device.
2. Flush out the hose connection with water to remove any scale or sediment which may possibly foul the backflow preventer.
3. Screw the device onto the hose connection hand tight to obtain an effective seal.
4. For tamper-proof installations, tighten set screw until head breaks off.

### **Field Testing Instructions**

**Testing of Atmospheric Vent:**  
Install a tightly closing shut-off valve on the outlet of the device. Pressurize the device and then allow the inlet pressure to drop to zero. The atmospheric vent should open and relieve pressure from the intermediate zone.

**Testing of Downstream Check:**  
Install a hose to the outlet of the device. With the opposite end open, fill with water and raise hose to a height of ten feet. There should be no leakage past the downstream check (out of the vent).

Failure of either test indicates faulty seals and requires repair or replacement for proper protection.

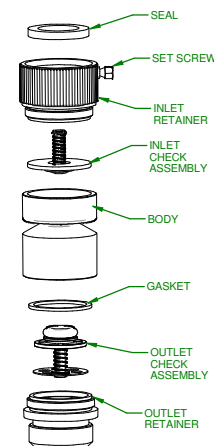

### **Repair Kit**

For repair kit containing a complete set of internal components order part No. 38-034-01.

**⚠ CALIFORNIA PROP 65: WARNING: Cancer and Reproductive Harm - [www.P65Warnings.ca.gov](http://www.P65Warnings.ca.gov).**

**FOR NON-LEAD FREE VALVES: It is illegal to use this product in the United States for potable water services (water intended for human consumption).**

**FOR LEAD FREE VALVES: This product complies with U.S. Safe Drinking Water Act (SDWA). Suitable for potable water applications intended for human consumption.**