



Job Name:	
Job Location:	
Engineer:	
Contractor:	
Tag:	
PO#:	
Rep:	
Wholesale Dist.:	

DESCRIPTION

ASME Section VIII capacity certified safety valve for overpressure protection of steam systems, cookers, kettles, sterilizers and similar equipment.

FEATURES

- ASME Section VIII Certified Capacity
- 15-60 psig (1.0 – 4.1 bar) Set Pressures @ 300°F (150°C) max
- Compact Design
- Chrome Finish Options
- Stainless Steel Wetted Component Option
- **Made in the USA**

APPROVALS

- National Board (NB) Certified Capacity
- ASME Section VIII Div 1 Pressure Vessels for Steam, Air/Gas and Liquids
- Canadian Registration Number OG8547.5C
- Directive 2002/95/CE (RoHS) Compliant
- Pressure Equipment Directive 2014/68/EU (PED)

Set pressures and temperatures vary by model.
Refer to catalog for sizing and selection information

STANDARD MATERIALS LIST

BODY	ASTM B16 Brass
NOZZLE	ASTM B16 Brass
SPRING	Stainless Steel
SEAT	Silicone

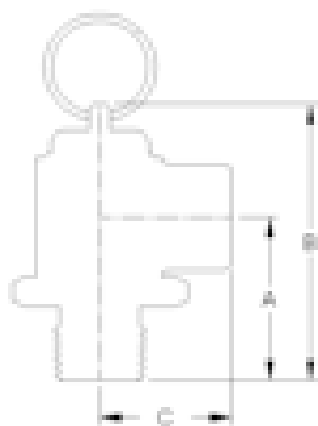

AVAILABLE CONFIGURATIONS

MODEL NUMBER	SERIES NUMBER	SIZE (.IN)	DIMENSIONS (.IN)		
			A	B	C
RVS52	10512	1/2	1.55 (39)	2.62 (67)	1.19 (30)

PART NUMBER MATRIX

10	XXX	XX	X	X
SERIES NO.	MODEL	FINISH	SET PRESSURE	OPTION
10	512	B - PLAIN BRASS	SET PRESSURE, PSIG (2 DIGITS)	B - BSPP CONNECTIONS
	(1/2" X 1/2")	P - POLISHED CHROME		CE - PED/CE
				S - STAINLESS STEEL TRIM
				V - VITON
				X - OUTLET NOT THREADED

CAPACITY

SET PRESSURE PSIG (BAR)	CAPACITY LB/HR (KG/HR)
15 (1.03)	151 (68)
20 (1.38)	178 (81)
25 (1.72)	205 (93)
30 (2.07)	232 (105)
35 (2.41)	259 (117)
40 (2.76)	285 (129)
45 (3.10)	312 (142)
50 (3.45)	339 (154)
55 (3.79)	365 (166)
60 (4.14)	392 (178)